

for sale

£240,000



## Victoria Place Alexandra Road Hemel Hempstead HP2 5XQ

\*\*\* TWO BEDROOM \*\*\* GROUND FLOOR APARTMENT \*\*\* ALLOCATED PARKING \*\*\* TOWN CENTRE \*\*\* LIVING AREA \*\*\* SEPARATE KITCHEN \*\*\* DOUBLE GLAZING \*\*\* IDEAL FOR FIRST TIME BUYERS OR INVESTORS \*\*\* CALL NOW TO BOOK A VIEWING \*\*\*



# Victoria Place Alexandra Road Hemel Hempstead HP2 5XQ

## Communal Entrance

Door to for with security entry system and stairs all floor.

## Entrance Hall

Door to front with entryphone and storage cupboard with boiler.

## Lounge

15' x 10' ( 4.57m x 3.05m )

Double glazed window and TV point and wall mounted electric heater.

## Kitchen

7' 6" x 7' 1" ( 2.29m x 2.16m )

Fitted with wall and base units with work surfaces to compliment, sink/drainers with splashbacks, sink/drainers with splashbacks, electric oven and hob with cookerhood and plumbing for washing machine.



## Bedroom 1

9' 10" plus fitted wardrobes x 9' ( 3.00m plus fitted wardrobes x 2.74m )

Double glazed window, fitted wardrobes and wall mounted electric heater.

## Bedroom 2

9' 1" x 7' 1" ( 2.77m x 2.16m )

Double glazed window and wall mounted electric heater.

## Bathroom

Fitted with bath with mixer taps, shower, wash hand basin with vanity unit, low level WC, heated towel rail and full tiling

## Parking

One allocated parking space.





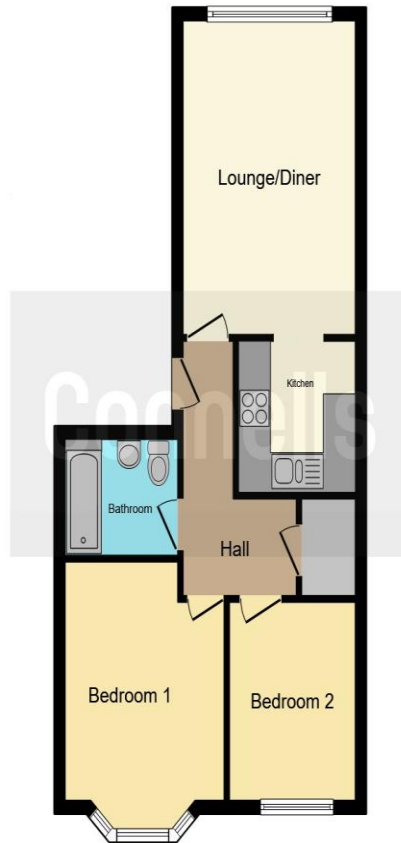

This floor plan is for illustrative purposes only. It is not drawn to scale. Any measurements, floor areas (including any total floor area), openings and orientation are approximate. No details are guaranteed, they cannot be relied upon for any purpose and they do not form part of any agreement. No liability is taken for any error, omission or misstatement. A party must rely upon its own inspection(s). Powered by [www.focalagent.com](http://www.focalagent.com)

To view this property please contact Connells on

**T 01442 216 633**  
**E [hemelhempstead@connells.co.uk](mailto:hemelhempstead@connells.co.uk)**

45 Marlowes  
 HEMEL HEMPSTEAD HP1 1LD

Property Ref: HEM312107 - 0005

**Tenure:** Leasehold

**EPC Rating:** E

**view this property online** [connells.co.uk/Property/HEM312107](http://connells.co.uk/Property/HEM312107)

This is a Leasehold property. We are awaiting further details about the Term of the lease. For further information please contact the branch. Please note additional fees could be incurred for items such as Leasehold packs.



1. MONEY LAUNDERING REGULATIONS Intending purchasers will be asked to produce identification documentation at a later stage and we would ask for your co-operation in order that there will be no delay in agreeing the sale. 2. These particulars do not constitute part or all of an offer or contract. 3. The measurements indicated are supplied for guidance only and as such must be considered incorrect. Potential buyers are advised to recheck measurements before committing to any expense. 4. We have not tested any apparatus, equipment, fixtures, fittings or services and it is in the buyers interest to check the working condition of any appliances.

Connells Residential is registered in England and Wales under company number 1489613, Registered Office is Cumbria House, 16-20 Hockliffe Street, Leighton Buzzard, Bedfordshire, LU7 1GN. VAT Registration Number is 500 2481 05.

see all our properties at [www.connells.co.uk](http://www.connells.co.uk) | [www.rightmove.co.uk](http://www.rightmove.co.uk) | [www.zoopla.co.uk](http://www.zoopla.co.uk)