



Not for marketing purposes INTERNAL USE ONLY

Coulser Close  
Hemel Hempstead



### Property Description

Three bedroom end of terrace family home in a popular Gadebridge location. DRIVEWAY PARKING, good sized rear garden, CONSERVATORY and spacious bedrooms. Walking distance to local shops, schools and Gadebridge Park. Ideal first time buy or investment, call now to arrange a viewing!

### Entrance Hall

Double glazed door to front, double glazed window, central heating combi boiler, understairs storage, radiator and stairs to first floor.

### Bathroom

Fitted with bath, shower, wash hand basin, low level WC and fully tiled.

### Lounge

16' 8" x 11' 9" ( 5.08m x 3.58m )

Double glazed window, TV point, radiator and double glazed doors to conservatory.

### Kitchen

11' 6" x 5' 9" ( 3.51m x 1.75m )

Fitted with wall and base units with work surfaces to compliment, sink/drainer with splashbacks, cooker point, radiator, double glazed window and double glazed door.

### Conservatory

11' 3" x 10' 2" ( 3.43m x 3.10m )

Brick built with double glazed windows and patio doors.

## Landing

Stairs from entrance hall and access to loft.

## Bedroom 1

16' 3" x 8' 6" ( 4.95m x 2.59m )

Double glazed window and radiator.

## Bedroom 2

11' 5" x 7' 5" ( 3.48m x 2.26m )

Double glazed window and radiator.

## Bedroom 3

11' 5" x 6' ( 3.48m x 1.83m )

Double glazed window and radiator.

## Front Garden

Driveway parking for two vehicles and side access alley.

## Rear Garden

Patio area leading to lawned area and brick built shed.







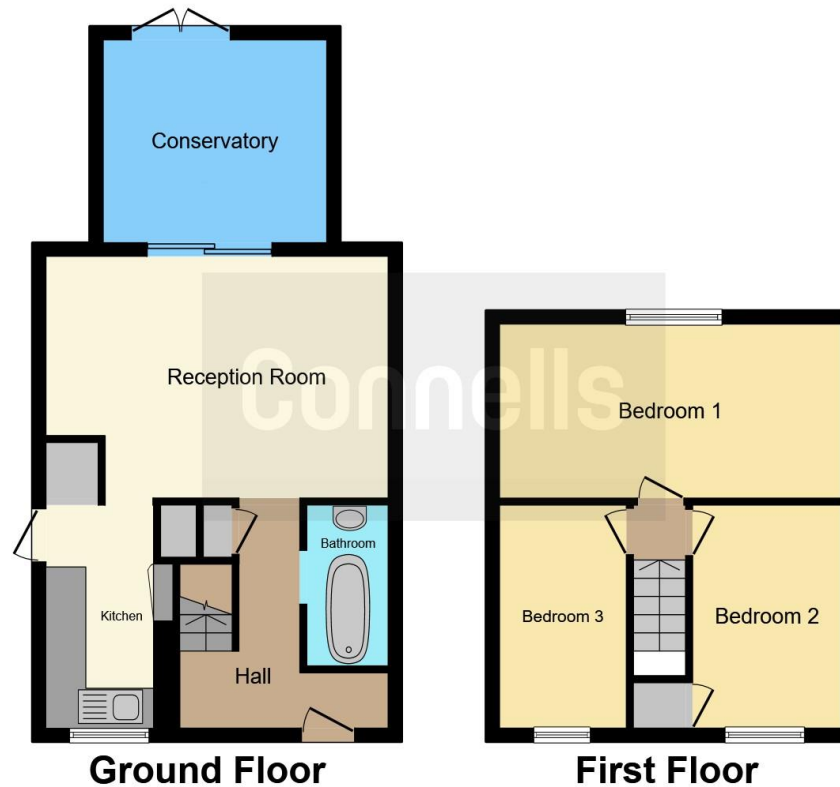

This floor plan is for illustrative purposes only. It is not drawn to scale. Any measurements, floor areas (including any total floor area), openings and orientation are approximate. No details are guaranteed, they cannot be relied upon for any purpose and they do not form part of any agreement. No liability is taken for any error, omission or misstatement. A party must rely upon its own inspection(s). Powered by [www.focalagent.com](http://www.focalagent.com)

To view this property please contact Connells on

**T 01442 216 633**  
**E [hemel Hempstead@connells.co.uk](mailto:hemel Hempstead@connells.co.uk)**

45 Marlowes  
 HEMEL HEMPSTEAD HP1 1LD

**EPC Rating: C**

Tenure: Freehold

**[check out more properties at connells.co.uk](http://connells.co.uk)**



1. MONEY LAUNDERING REGULATIONS Intending purchasers will be asked to produce identification documentation at a later stage and we would ask for your co-operation in order that there will be no delay in agreeing the sale. 2. These particulars do not constitute part or all of an offer or contract. 3. The measurements indicated are supplied for guidance only and as such must be considered incorrect. Potential buyers are advised to recheck measurements before committing to any expense. 4. We have not tested any apparatus, equipment, fixtures, fittings or services and it is in the buyers interest to check the working condition of any appliances.

Connells Residential is registered in England and Wales under company number 1489613, Registered Office is Cumbria House, 16-20 Hockliffe Street, Leighton Buzzard, Bedfordshire, LU7 1GN. VAT Registration Number is 500 2481 05.

**See all our properties at [www.connells.co.uk](http://www.connells.co.uk) | [www.rightmove.co.uk](http://www.rightmove.co.uk) | [www.zoopla.co.uk](http://www.zoopla.co.uk)**

Property Ref: HEM311898 - 0007