



Connells

Hare Lane
Hatfield



Property Description

Nestled in a charming neighbourhood of Hatfield, this three-bedroom mid terrace home offers spacious and comfortable living for families or professionals alike. As you step through the front door, you're greeted by a warm and inviting atmosphere. The ground floor boasts a generous living room, perfect for relaxing evenings or gathering with friends and family. The modern kitchen features ample counter space and storage, making meal preparation a breeze. Upstairs you'll find three well-appointed bedrooms, providing plenty of space of rest and relaxation. In addition, there is a family bathroom. Outside, the rear garden offers a real al fresco feel, with a sheltered tiled area with brick-built barbeque/ pizza oven. A driveway offers convenient off-street parking - a rare find in the area. With its convenient location, close to schools, parks and amenities, this home is the perfect place to settle down and enjoy all that Hatfield has to offer.

Entrance Hall

Lounge

17' 4" x 13' 2" (5.28m x 4.01m)

Double glazed window to rear aspect, double glazed door leading to garden, wood flooring, radiator.

Kitchen

11' 5" x 8' 2" (3.48m x 2.49m)

Double glazed window to front aspect, tiled flooring, electric oven, gas hob, extractor hood, range of wall and base units, sink with drainer, worktops.

Landing

Bedroom One

12' 9" x 10' 2" (3.89m x 3.10m)

Double glazed window to rear aspect, wood laminate flooring, radiator.

Bedroom Two

10' 3" x 8' 6" (3.12m x 2.59m)

Double glazed window to front aspect, carpeted, radiator.

Bedroom Three

9' 9" x 7' 2" (2.97m x 2.18m)

Double glazed window to rear aspect, wood laminate flooring, radiator.

Bathroom

8' 4" x 5' 4" (2.54m x 1.63m)

Frosted double glazed window to front aspect, low level wc, wash hand basin, panel enclosed bathtub.

Rear Garden

Tiled area providing al fresco feel, brick oven, sheltered, fence panel enclosed, laid to lawn, brick built shed.







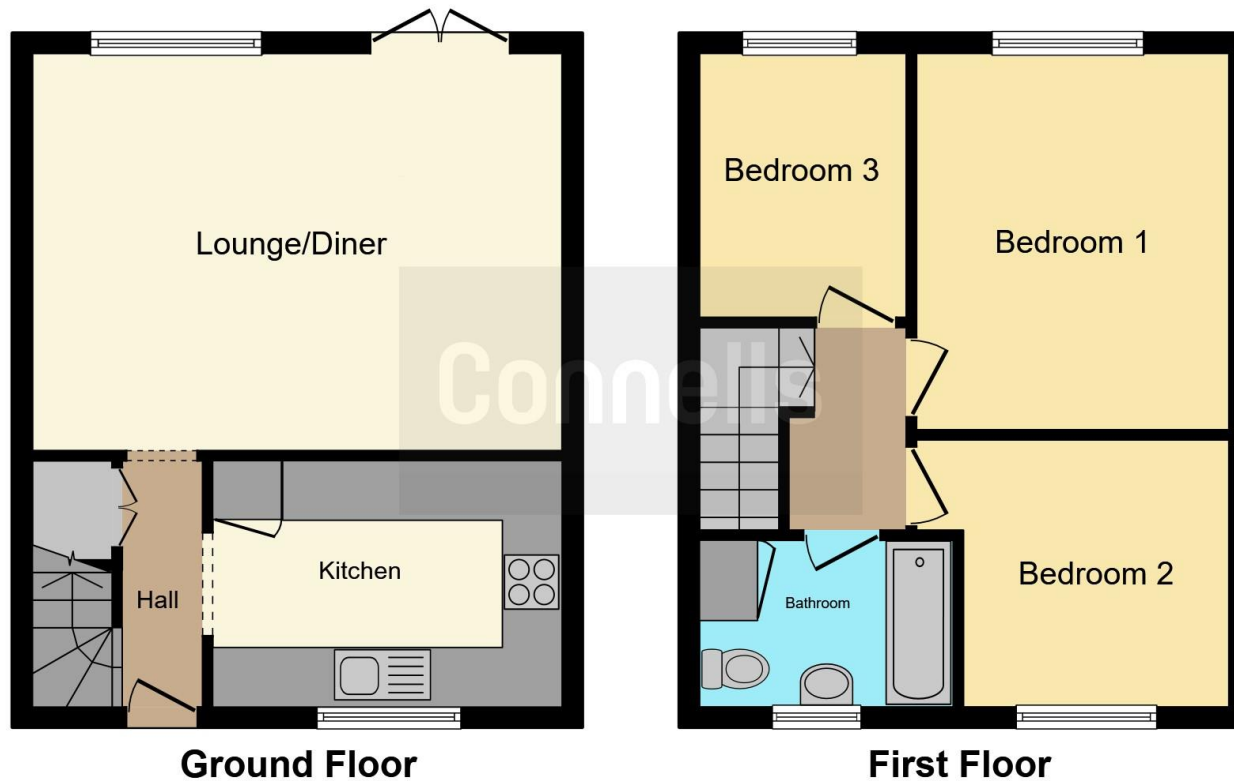

This floor plan is for illustrative purposes only. It is not drawn to scale. Any measurements, floor areas (including any total floor area), openings and orientation are approximate. No details are guaranteed, they cannot be relied upon for any purpose and they do not form part of any agreement. No liability is taken for any error, omission or misstatement. A party must rely upon its own inspection(s). Powered by www.focalagent.com

To view this property please contact Connells on

T 01707 322 903

E welwyngardencity@connells.co.uk

38 Wigmores North
WELWYN GARDEN CITY AL8 6PH

EPC Rating: C

Tenure: Freehold

view this property online connells.co.uk/Property/WWY306712



1. MONEY LAUNDERING REGULATIONS Intending purchasers will be asked to produce identification documentation at a later stage and we would ask for your co-operation in order that there will be no delay in agreeing the sale. 2. These particulars do not constitute part or all of an offer or contract. 3. The measurements indicated are supplied for guidance only and as such must be considered incorrect. Potential buyers are advised to recheck measurements before committing to any expense. 4. We have not tested any apparatus, equipment, fixtures, fittings or services and it is in the buyers interest to check the working condition of any appliances.

Connells Residential is registered in England and Wales under company number 1489613, Registered Office is Cumbria House, 16-20 Hockliffe Street, Leighton Buzzard, Bedfordshire, LU7 1GN. VAT Registration Number is 500 2481 05.

See all our properties at www.connells.co.uk | www.rightmove.co.uk | www.zoopla.co.uk

Property Ref: WWY306712 - 0003