



**Connells**

Knot House Millward Drive  
Bletchley Milton Keynes



### Property Description

Offered to the market with no onward chain is this spacious one-bedroom top floor apartment, located alongside the Grand Union Canal and the River Ouzel in Fenny Stratford.

Other benefits of this property include its fantastic location which is within proximity to local amenities and transport links. There is also one allocated parking space that belongs to this property, situated in a secure underground garage. This property needs to be viewed to be truly appreciated.

Accommodation comprises entrance hall, open-plan lounge/diner, kitchen, one double bedrooms and a bathroom. Outside there is allocated parking for one car situated in an underground garage secured by gated access.

### Entrance Hall

Carpeted flooring. Door into the Bathroom on the left and large storage airing cupboard with hot water tank.

### Lounge/Diner

18' 2" x 12' 1" ( 5.54m x 3.68m )

Full length window overlooking the parking area, carpeted, tv points and two wall mounted radiators and opening into the kitchen area.

### Kitchen

11' 2" x 6' 3" ( 3.40m x 1.91m )

A mixture of high and low level units, tiled splash backs, integrated oven and hob, with space for a free standing fridge freezer, washing machine and dishwasher.

### Bedroom One

14' x 10' 1" ( 4.27m x 3.07m )

Carpeted flooring, window overlooking the parking area and green spaces, tv arial and heating controls

### Bathroom

6' 10" x 9' 5" ( 2.08m x 2.87m )

Wall mounted radiator, Bath with shower over it, low level wc and wash hand basin.



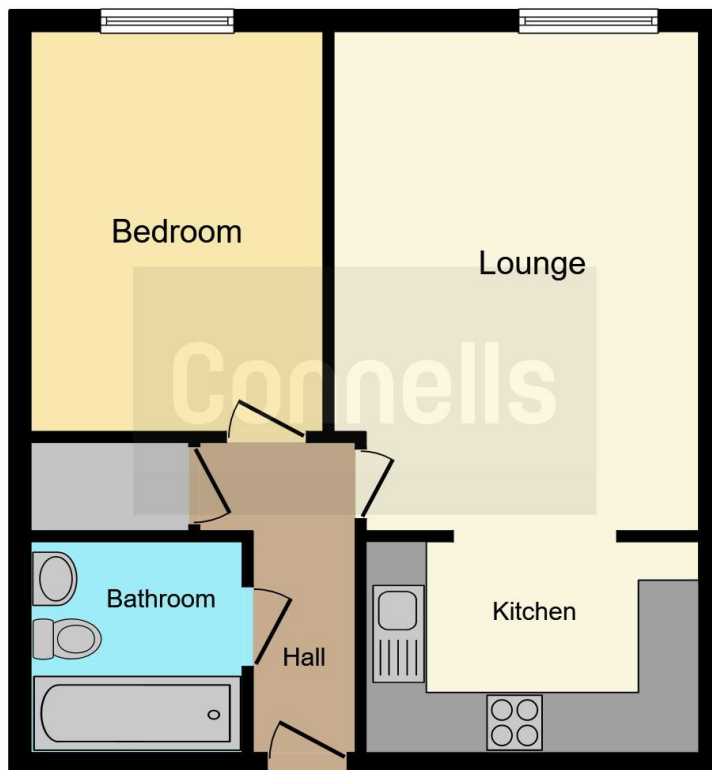

This floor plan is for illustrative purposes only. It is not drawn to scale. Any measurements, floor areas (including any total floor area), openings and orientation are approximate. No details are guaranteed, they cannot be relied upon for any purpose and they do not form part of any agreement. No liability is taken for any error, omission or misstatement. A party must rely upon its own inspection(s). Powered by [www.focalagent.com](http://www.focalagent.com)

To view this property please contact Connells on

**T 01908 375 241**  
**E [bletchley@connells.co.uk](mailto:bletchley@connells.co.uk)**

188 Queensway Bletchley  
 MILTON KEYNES MK2 2SW

**EPC Rating: Awaited**

**view this property online [connells.co.uk/Property/BLE310775](http://connells.co.uk/Property/BLE310775)**

This is a Leasehold property with details as follows; Term of Lease 125 years from 01 Jan 2007. Should you require further information please contact the branch. Please Note additional fees could be incurred for items such as Leasehold packs.



Tenure: Leasehold



1. MONEY LAUNDERING REGULATIONS Intending purchasers will be asked to produce identification documentation at a later stage and we would ask for your co-operation in order that there will be no delay in agreeing the sale. 2. These particulars do not constitute part or all of an offer or contract. 3. The measurements indicated are supplied for guidance only and as such must be considered incorrect. Potential buyers are advised to recheck measurements before committing to any expense. 4. We have not tested any apparatus, equipment, fixtures, fittings or services and it is in the buyers interest to check the working condition of any appliances.

Connells Residential is registered in England and Wales under company number 1489613, Registered Office is Cumbria House, 16-20 Hockliffe Street, Leighton Buzzard, Bedfordshire, LU7 1GN. VAT Registration Number is 500 2481 05.

**See all our properties at [www.connells.co.uk](http://www.connells.co.uk) | [www.rightmove.co.uk](http://www.rightmove.co.uk) | [www.zoopla.co.uk](http://www.zoopla.co.uk)**

Property Ref: BLE310775 - 0003