



Connells

Guyana Lane
Bletchley MILTON KEYNES



Property Description

Located in the highly sought after 'Newton Leys' development is this immaculately presented four bedroom semi-detached property.

This townhouse style property offers the best of modern living with accommodation situated across three floors which allows for four generously sized bedrooms.

This property also benefits from eighteen solar panels which are owned outright with the property.

In terms of location, this property is situated within close proximity to local amenities such as shops and schools, and is also situated within easy access to transport links namely Bletchley mainline station, and the A5 and M1 road links.

Viewing is highly recommended to truly appreciate this property.

Accommodation comprises entrance hall, kitchen, lounge, conservatory, cloakroom, first floor landing, two bedrooms, shower room, second floor landing, two further bedrooms, en-suite to the master and another shower room.

There is also sliding fly screens in all rooms including on the Bi - fold doors to garden. Outside there is a low maintenance rear garden and parking for two cars.

Entrance Hall

Laminate flooring. Wall mounted gas radiator. Storage under stairs.

Kitchen

11' 2" x 10' 1" Maximum (3.40m x 3.07m Maximum)

Enter from entrance hall. Laminate flooring. Integrated oven, fridge freezer, dishwasher and washing machine. Four ring electric hob. Extractor fan. Double glazed window to front aspect.

Lounge

15' 6" x 12' 2" (4.72m x 3.71m)

Enter from entrance hall. Laminate flooring. Two wall mounted gas radiators.

Conservatory

13' 11" x 8' 8" (4.24m x 2.64m)

Enter from lounge. Vinyl flooring. Wall mounted electric fire place. Bifold doors to rear.

Cloakroom

Enter from entrance hall. Tiled flooring. Wall mounted gas radiator. Extractor fan. Wc and wash-hand basin.

First Floor Landing

Rise from entrance hall. Carpeted flooring.

Bedroom Two

15' 6" x 11' 1" (4.72m x 3.38m)

Enter from first floor landing. Carpeted flooring. Wall mounted gas radiator. Double glazed window to rear aspect. Juliette balcony to rear aspect.

Bedroom Four

9' 5" x 8' 4" (2.87m x 2.54m)

Enter from first floor landing. Carpeted flooring. Wall mounted gas radiator. Double glazed window to front aspect.

Shower Room

Enter from first floor landing. Tiled flooring. Heated towel rail. Extractor fan. Walk-in shower, wc and wash-hand basin.

Second Floor Landing

Rise from first floor landing. Carpeted flooring. Loft hatch. Airing cupboard.

Master Bedroom

12' x 11' 1" (3.66m x 3.38m)

Enter from second floor landing. Carpeted flooring. Wall mounted gas radiator. Double glazed window to rear aspect.

En-Suite

Enter from master bedroom. Tiled flooring. Extractor fan. Wall mounted gas radiator. Walk-in shower, wc and wash-hand basin.

Bedroom Three

14' 8" x 9' 1" (4.47m x 2.77m)

Enter from second floor landing. Carpeted flooring. Two double glazed windows to front aspect. Fitted wardrobe. Wall mounted gas radiator.

Shower Room

Enter from second floor landing. Tiled flooring. Walk-in shower. Wall mounted gas radiator. Extractor fan.



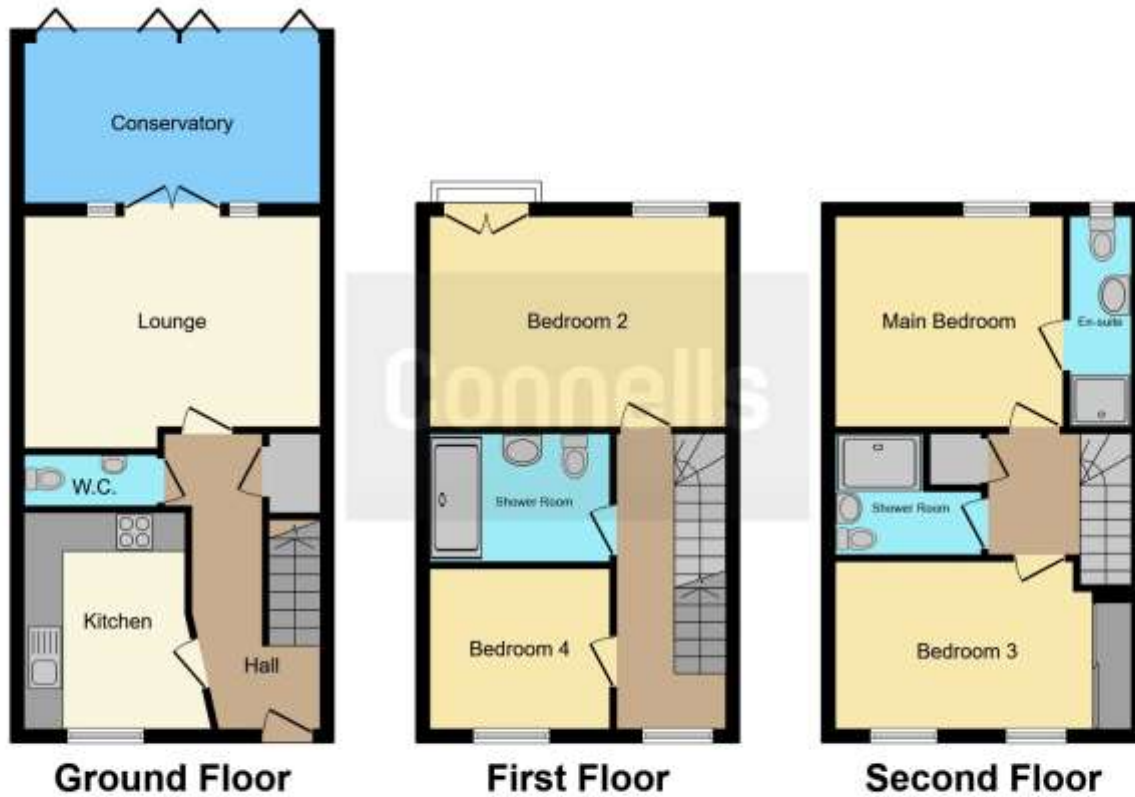

This floor plan is for illustrative purposes only. It is not drawn to scale. Any measurements, floor areas (including any total floor area), openings and orientation are approximate. No details are guaranteed, they cannot be relied upon for any purpose and they do not form part of any agreement. No liability is taken for any error, omission or misstatement. A party must rely upon its own inspection(s). Powered by www.focalagent.com



To view this property please contact Connells on

T 01908 375 241
E bletchley@connells.co.uk

188 Queensway Bletchley
 MILTON KEYNES MK2 2SW

EPC Rating: Awaited

view this property online connells.co.uk/Property/BLE310502

Tenure: Freehold



1. MONEY LAUNDERING REGULATIONS Intending purchasers will be asked to produce identification documentation at a later stage and we would ask for your co-operation in order that there will be no delay in agreeing the sale. 2. These particulars do not constitute part or all of an offer or contract. 3. The measurements indicated are supplied for guidance only and as such must be considered incorrect. Potential buyers are advised to recheck measurements before committing to any expense. 4. We have not tested any apparatus, equipment, fixtures, fittings or services and it is in the buyers interest to check the working condition of any appliances.

Connells Residential is registered in England and Wales under company number 1489613, Registered Office is Cumbria House, 16-20 Hockliffe Street, Leighton Buzzard, Bedfordshire, LU7 1GN. VAT Registration Number is 500 2481 05.

See all our properties at www.connells.co.uk | www.rightmove.co.uk | www.zoopla.co.uk

Property Ref: BLE310502 - 0003