



Connells

Surrey Road
Bletchley Milton Keynes

Surrey Road
Bletchley Milton Keynes MK3 7HB

for sale offers in excess of
£260,000



Property Description

Located in the popular 'Counties' estate of Bletchley, this three bedroom property offers easy access to local amenities such as shops and Schools, and is also situated within close proximity to public transport links like the train station and bus station.

Accommodation comprises in brief, entrance hall, living room, kitchen/diner, first floor landing, three bedrooms and a family bathroom.

Outside the property boasts a low maintenance rear garden.



Entrance Hall

Living Room

11' 7" x 11' 5" (3.53m x 3.48m)

Kitchen/diner

17' 9" x 9' (5.41m x 2.74m)

First Floor Landing

Bedroom One

12' 1" x 11' 8" (3.68m x 3.56m)

Bedroom Two

11' 8" x 9' 1" (3.56m x 2.77m)

Bedroom Three

12' 1" x 6' 3" (3.68m x 1.91m)

Shower Room



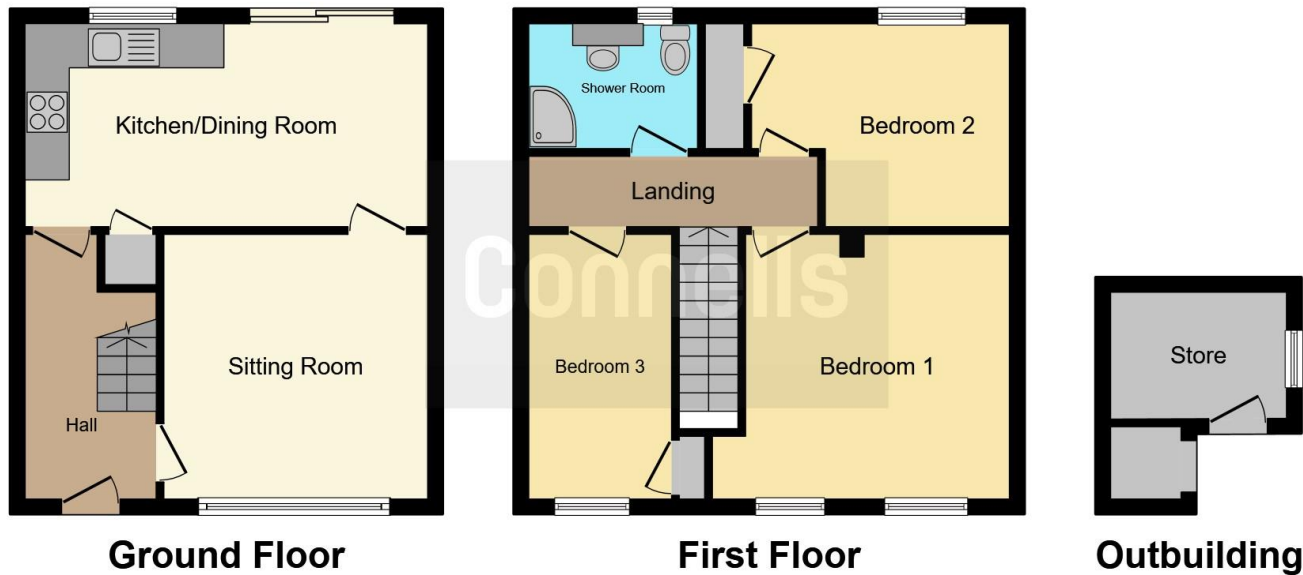

This floorplan is for illustrative purposes only and is not drawn to scale. Measurements, floor-areas, openings and orientations are approximate. They should not be relied upon for any purpose and do not form any part of an agreement. No liability is taken for any error or mis-statement. All parties must rely on their own inspections.

To view this property please contact Connells on

T 01908 375 241
E bletchley@connells.co.uk

188 Queensway Bletchley
 MILTON KEYNES MK2 2SW

EPC Rating: D

view this property online connells.co.uk/Property/BLE310098

Tenure: Freehold



1. MONEY LAUNDERING REGULATIONS Intending purchasers will be asked to produce identification documentation at a later stage and we would ask for your co-operation in order that there will be no delay in agreeing the sale. 2. These particulars do not constitute part or all of an offer or contract. 3. The measurements indicated are supplied for guidance only and as such must be considered incorrect. Potential buyers are advised to recheck measurements before committing to any expense. 4. We have not tested any apparatus, equipment, fixtures, fittings or services and it is in the buyers interest to check the working condition of any appliances.

Connells Residential is registered in England and Wales under company number 1489613, Registered Office is Cumbria House, 16-20 Hockliffe Street, Leighton Buzzard, Bedfordshire, LU7 1GN. VAT Registration Number is 500 2481 05.

See all our properties at www.connells.co.uk | www.rightmove.co.uk | www.zoopla.co.uk

Property Ref: BLE310098 - 0005