



Not for marketing purposes INTERNAL USE ONLY

Gledfield Place
Hodge Lea MILTON KEYNES

Gledfield Place Hodge Lea MILTON KEYNES MK12 6JH

for sale
£325,000



Property Description

Situated in the sought-after area of Hodge Lea, Milton Keynes, this four-bedroom semi-detached home combines comfort, space, and convenience-making it an ideal choice for families or first-time buyers alike.

The property welcomes you with a generous driveway offering parking for several vehicles. Inside, a spacious living room provides the perfect setting for both relaxing and entertaining. The well-designed kitchen diner is ideal for family meals and social gatherings, while a handy downstairs cloakroom enhances everyday practicality.

Upstairs, the accommodation comprises two well-proportioned double bedrooms and two single bedrooms, offering flexible space for children, guests, or a home office. The family bathroom is neatly presented and designed for comfortable daily use.

Being sold chain-free, this home allows for a stress-free purchase. Hodge Lea is a thriving community with excellent local amenities, and its convenient location offers easy access to Milton Keynes city centre, where a wide selection of shopping, dining, and leisure facilities can be found. The area also benefits from strong transport links, including nearby train stations and major road routes, ensuring excellent connectivity.

Entrance Hall

Radiator. Understairs Storage. Stairs rising to

first floor.

Cloakroom

Wc and sink unit. Heated towel rail. Window to front aspect.

Lounge

14' 5" x 11' 10" (4.39m x 3.61m)

Radiator. Patio doors to garden.

Kitchen

21' 7" x 9' 3" (6.58m x 2.82m)

Radiator. 1 1/2 sink and drainer. Wall and base cupboards. Oven and gas hob. Extractor fan. Space for appliances. 2 windows to the front aspect and door to garden. Patio doors to garden.

Bedroom 1

11' 9" x 9' 10" (3.58m x 3.00m)

Radiator. Window to front Aspect.

Bedroom 2

11' 5" x 8' 9" (3.48m x 2.67m)

Radiator. Window to front Aspect.

Bedroom 3

13' 1" x 5' 7" (3.99m x 1.70m)

Radiator. Window to rear aspect.

Bedroom 4

9' 10" x 6' 5" (3.00m x 1.96m)

Radiator. Window to front aspect.

Bathroom

Wc and Sink. Bath with mixer tap and overhead shower. Window to front aspect.

Outside

Front

Drive for multiple vehicles

Rear

Mainly laid to patio









Ground Floor

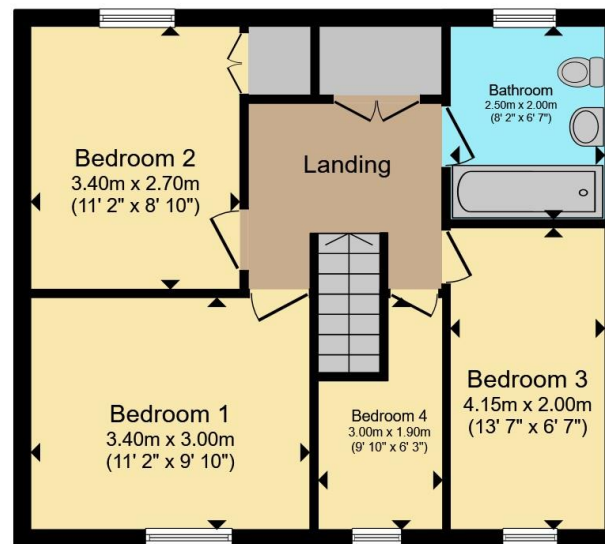

First Floor

Total floor area 96.2 m² (1,035 sq.ft.) approx

This floor plan is for illustrative purposes only. It is not drawn to scale. Any measurements, floor areas (including any total floor area), openings and orientation are approximate. No details are guaranteed, they cannot be relied upon for any purpose and they do not form part of any agreement. No liability is taken for any error, omission or misstatement. A party must rely upon its own inspection(s). Powered by www.propertybox.io

Connells

To view this property please contact Connells on

T 01908 563 993
E stonystatford@connells.co.uk

82 High Street Stony Stratford
MILTON KEYNES MK11 1AH

EPC Rating: D Council Tax
Band: C

Tenure: Freehold

check out more properties at connells.co.uk



1. MONEY LAUNDERING REGULATIONS Intending purchasers will be asked to produce identification documentation at a later stage and we would ask for your co-operation in order that there will be no delay in agreeing the sale. 2. These particulars do not constitute part or all of an offer or contract. 3. The measurements indicated are supplied for guidance only and as such must be considered incorrect. Potential buyers are advised to recheck measurements before committing to any expense. 4. We have not tested any apparatus, equipment, fixtures, fittings or services and it is in the buyers interest to check the working condition of any appliances.

Connells Residential is registered in England and Wales under company number 1489613, Registered Office is Cumbria House, 16-20 Hockliffe Street, Leighton Buzzard, Bedfordshire, LU7 1GN. VAT Registration Number is 500 2481 05.

See all our properties at www.connells.co.uk | www.rightmove.co.uk | www.zoopla.co.uk

Property Ref: SSD307626 - 0002