

for sale

£375,000



Shelsmore Giffard Park Milton Keynes MK14 5HU

Connells are pleased to bring to the market a three-bedroom Link detached home set in the much sought after area of Newport Pagnell.



Shelsmore Giffard Park Milton Keynes MK14 5HU

Entrance Hall

Front door. Stairs to first floor. Doors leading to Cloakroom, Kitchen and lounge/diner.

Cloakroom

W/C. Sink. Window to side aspect.

Kitchen

Door to rear garden. Window to rear aspect. Wall and base level units. Sink drainer. Oven with hob.

Lounge

15' 8" x 11' 1" (4.78m x 3.38m)

Double doors to rear. Window to front. Cupboard.

Bedroom One

15' 7" x 8' 4" (4.75m x 2.54m)

Good sized room. Window to rear aspect.

Bedroom Two

10' 6" x 9' 1" (3.20m x 2.77m)

Good sized room. Window to rear aspect.

Bedroom Three

9' 1" x 7' 4" (2.77m x 2.24m)

Fitted wardrobe. Windows to front and rear aspects.

Bathroom

Bath with shower over. W/C. Sink. Window to front.

Rear Garden

Enclosed rear garden with gated access.

Outside

Parking and garage with window and door to rear.







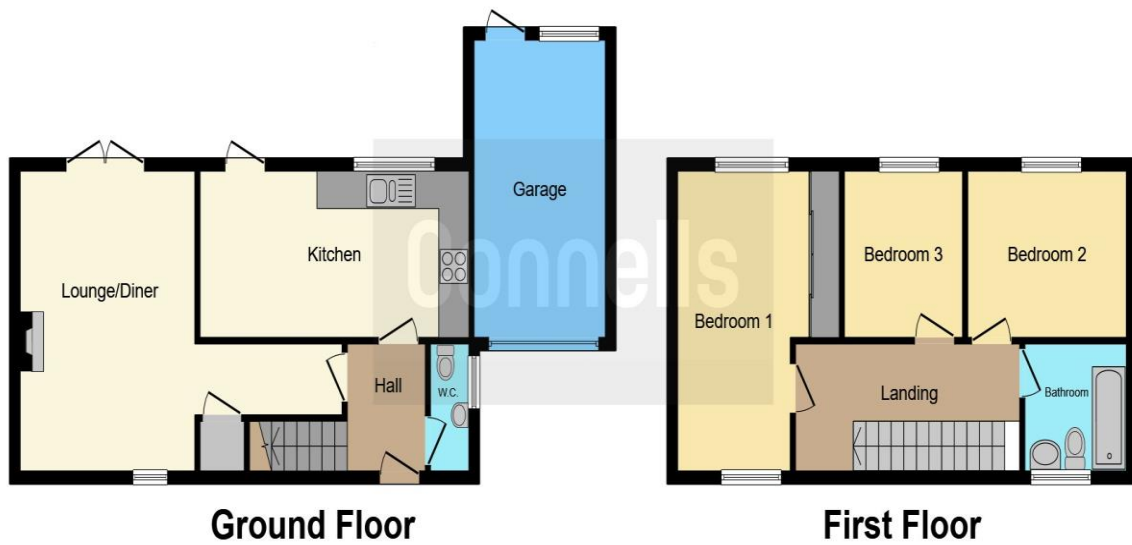

This floor plan is for illustrative purposes only. It is not drawn to scale. Any measurements, floor areas (including any total floor area), openings and orientation are approximate. No details are guaranteed, they cannot be relied upon for any purpose and they do not form part of any agreement. No liability is taken for any error, omission or misstatement. A party must rely upon its own inspection(s). Powered by www.focalagent.com

To view this property please contact Connells on

T 01908 610 805
E newportpagnell@connells.co.uk

91 High Street Newport Pagnell
 MILTON KEYNES MK16 8EN

Property Ref: NPA306304 - 0003

Tenure: Freehold EPC Rating: Awaiting

Council Tax Band: C

view this property online connells.co.uk/Property/NPA306304



1. MONEY LAUNDERING REGULATIONS Intending purchasers will be asked to produce identification documentation at a later stage and we would ask for your co-operation in order that there will be no delay in agreeing the sale. 2. These particulars do not constitute part or all of an offer or contract. 3. The measurements indicated are supplied for guidance only and as such must be considered incorrect. Potential buyers are advised to recheck measurements before committing to any expense. 4. We have not tested any apparatus, equipment, fixtures, fittings or services and it is in the buyers interest to check the working condition of any appliances.

Connells Residential is registered in England and Wales under company number 1489613, Registered Office is Cumbria House, 16-20 Hockliffe Street, Leighton Buzzard, Bedfordshire, LU7 1GN. VAT Registration Number is 500 2481 05.

see all our properties at www.connells.co.uk | www.rightmove.co.uk | www.zoopla.co.uk