



Connells

Bernay Gardens
Bolbeck Park Milton Keynes

Bernay Gardens Bolbeck Park Milton Keynes MK15 8QD

for sale
£375,000



Property Description

Connells Estate Agents are delighted to offer for sale this three bedroom semi detached family home in the popular and much sought after area of Bolbeck Park, Milton Keynes. This property is in very good condition throughout.

The accommodation includes an entrance hallway, cloakroom, lounge, kitchen/diner, first floor landing, bedroom one with an en suite, a further two bedrooms and a family bathroom. Outside enclosed rear garden, driveway and garager parking for two vehicles.

Please see the full range of photographs as well as the floorplan that shows an indicative view of room layouts. For further information and to arrange your viewing please contact us on 01908 674141 or email miltonkeynes@connells.co.uk.

The Area

Bolbeck Park is a well regarded and sought after area within the North East of Milton Keynes. The area is a short drive away from the centre of Milton Keynes and its vast array of amenities.

In Central Milton Keynes you will find Centre:MK, the Xscape building and the theatre district. You will find a large selection of shops, restaurants and entertainment facilities. There is also a mainline railway station offering regular and direct links into London Euston, with journey times of approximately 35 minutes.

Bolbeck Park is also pleasantly situated near to the Grand Union Canal and Willen Lake, offering excellent outside space and brilliant walking areas. The market town of Newport Pagnell is also a short drive away, offering restaurants pubs and more local amenities.

Junction 14 of the M1 is nearby, making this an ideal location for those that commute by road. Further trunk roads such as the A5, A509, A421 and A422 are also easily accessible. The town is also well served with regular bus routes providing journeys across the town and to towns/cities a bit further afield.

Entrance Hall

Stairs leading to first floor landing

Cloakroom

Wash hand basin, w/c.

Lounge

11' 1" x 19' (3.38m x 5.79m)

Double glazed window and double glazed patio doors to the rear garden, fireplace, tv and telephone points, wall mounted radiator.

Kitchen/Diner 10' 5" x 13' 1" (3.17m x 3.99m)

Fitted kitchen with eye base units, worksurfaces, stainless steel sink drainer, built in oven, gas hob with an extractor hood over, double glazed window.

Landing

Bedroom 1

10' 5" x 11' 8" (3.17m x 3.56m)

Double glazed window, fitted wardrobes, wall mounted radiator.

En Suite Fully tiled, wash hand basin, w/c, shower cubicle, shower.

Bedroom 2

11' 2" x 14' 4" RHH (3.40m x 4.37m RHH)

Double glazed window, wall mounted radiator, tv point.

Bedroom 3 (Ground Floor)

11' 1" x 7' 9" (3.38m x 2.36m)

Double glazed window, wall mounted radiator

Bathroom Fully tiled, bath, bath taps, heated towel radiator, w/c, wash hand basin, double glazed window.

Front Garden Laid to lawn

Rear Garden Enclosed by a timber fence, laid to lawn, patio area, gated access, shed.

Parking Driveway and garage







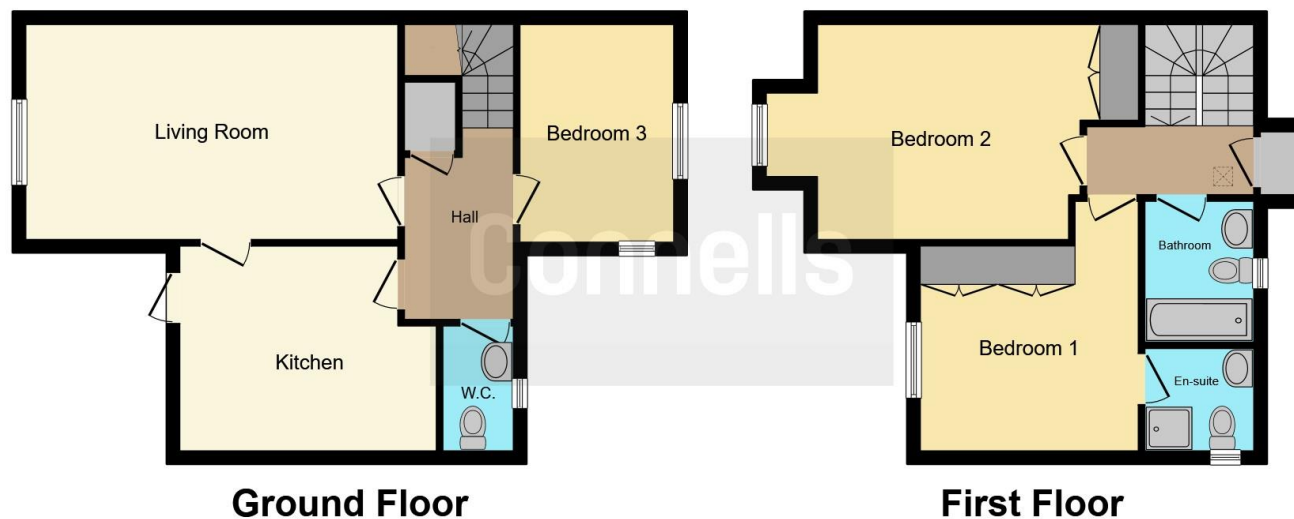

This floor plan is for illustrative purposes only. It is not drawn to scale. Any measurements, floor areas (including any total floor area), openings and orientation are approximate. No details are guaranteed, they cannot be relied upon for any purpose and they do not form part of any agreement. No liability is taken for any error, omission or misstatement. A party must rely upon its own inspection(s). Powered by www.focalagent.com

To view this property please contact Connells on

T 01908 674 141
E miltonkeynes@connells.co.uk

Northgate House 500 Silbury Boulevard
 MILTON KEYNES MK9 2AD

EPC Rating: C Council Tax
 Band: D

Tenure: Freehold

view this property online connells.co.uk/Property/MKN320235



1. MONEY LAUNDERING REGULATIONS Intending purchasers will be asked to produce identification documentation at a later stage and we would ask for your co-operation in order that there will be no delay in agreeing the sale. 2. These particulars do not constitute part or all of an offer or contract. 3. The measurements indicated are supplied for guidance only and as such must be considered incorrect. Potential buyers are advised to recheck measurements before committing to any expense. 4. We have not tested any apparatus, equipment, fixtures, fittings or services and it is in the buyers interest to check the working condition of any appliances.

Connells Residential is registered in England and Wales under company number 1489613, Registered Office is Cumbria House, 16-20 Hockliffe Street, Leighton Buzzard, Bedfordshire, LU7 1GN. VAT Registration Number is 500 2481 05.

See all our properties at www.connells.co.uk | www.rightmove.co.uk | www.zoopla.co.uk

Property Ref: MKN320235 - 0004