



Connells

Tyhurst
Middleton Milton Keynes



Property Description

Connells Estate Agents are delighted to offer for sale a very popular and sought after area of Middleton.

The accommodation includes a secure communal kitchen, two bedrooms and a bathroom.

Please see the floorplan for an indicative view of the property. For further information and to arrange a viewing please call 01295 674141 or email miltonkeynes@connells.co.uk.

The Area

Middleton is widely regarded as one of the best areas to live in Milton Keynes. It provides a great area for families to live. There are many schools in Middleton and the nearby Oakgrove.

Milton Keynes town centre and all of its amenities are within walking distance. The town centre (MK) has a wide range of retail outlets, entertainment and recreational facilities. Milton Keynes has direct links into London Euston, with a journey time of approximately 45 minutes. The M1 is also a short drive away providing good access to public transport and cycle redways.

Local amenities with a range of shops can be found in the area. The Kingston retail park has a selection of well-known brands and some restaurants.

Middleton also benefits from being within walking distance of a park, providing lake and river side walking routes.

Entrance Hall

Laminated flooring, doors leading to all rooms.

Kitchen / Diner / Lounge

14' 6" x 15' 7" (4.42m x 4.75m)

Open plan irregular shape, laminated flooring, double glazed patio door leading to the balcony, eye base units, double glazed window to the side, sink with splash back tiles, cooker, space for washing machine and fridge freezer

Bedroom 1

15' 3" x 9' 5" (4.65m x 2.87m)

Laminated flooring double glazed patio door leading to balcony, wall mounted radiator.

Bedroom 2

15' 9" x 7' 5" (4.80m x 2.26m)

Irregular shape, double glazed window, shower room

Bathroom

W/c, bath taps with shower over, wash hand basin, heated towel radiator, cupboard, laminated flooring

Gardens

This development benefits from communal gardens for residents.



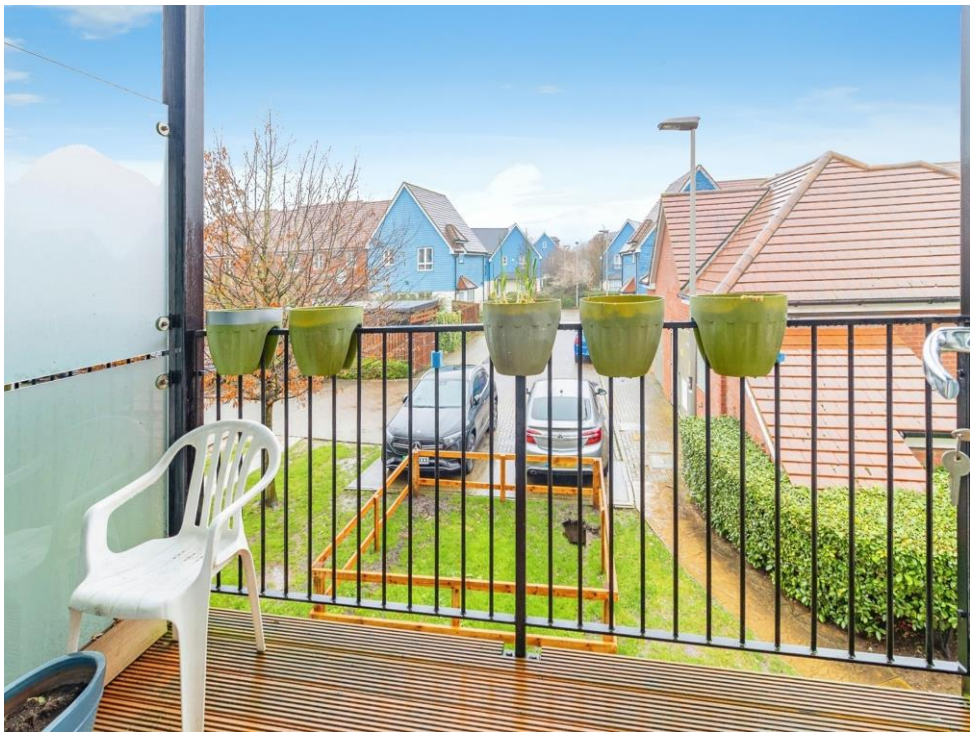



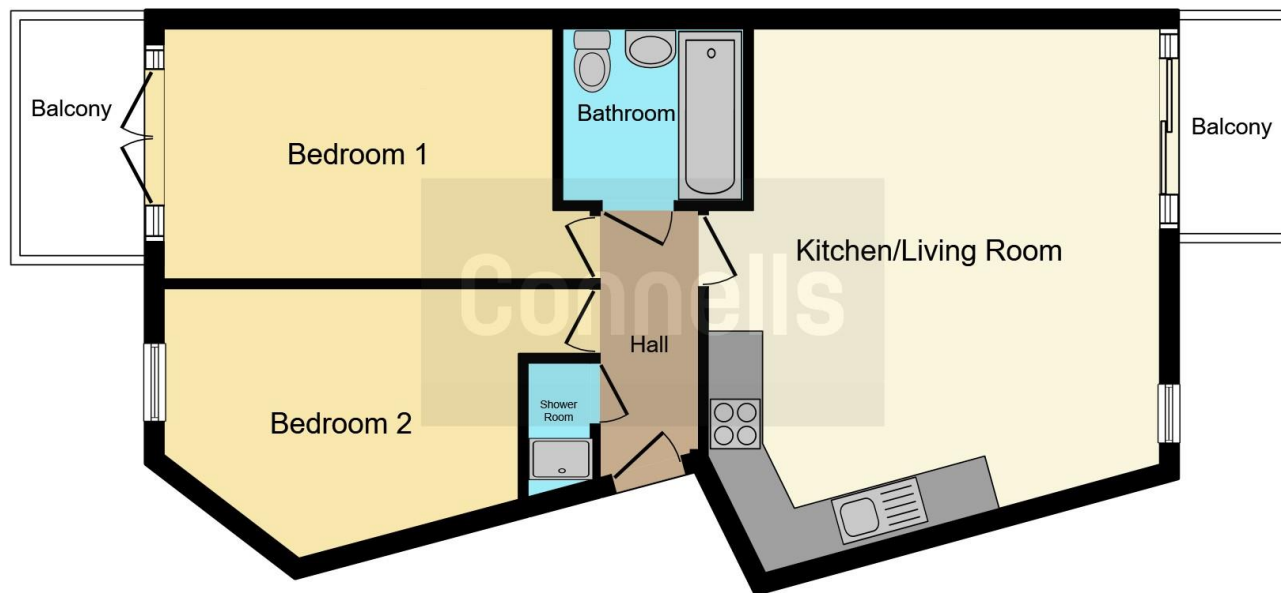

This floorplan is for illustrative purposes only and is not drawn to scale. Measurements, floor-areas, openings and orientations are approximate. They should not be relied upon for any purpose and do not form any part of an agreement. No liability is taken for any error or mis-statement. All parties must rely on their own inspections.

To view this property please contact Connells on

T 01908 674 141

E miltonkeynes@connells.co.uk

Northgate House 500 Silbury Boulevard
MILTON KEYNES MK9 2AD

EPC Rating: B

Tenure: Leasehold

view this property online connells.co.uk/Property/MKN318787

This is a Leasehold property with details as follows; Term of Lease 125 years from 31 Mar 2008. Should you require further information please contact the branch. Please Note additional fees could be incurred for items such as



1. MONEY LAUNDERING REGULATIONS Intending purchasers will be asked to produce identification documentation at a later stage and we would ask for your co-operation in order that there will be no delay in agreeing the sale. 2. These particulars do not constitute part or all of an offer or contract. 3. The measurements indicated are supplied for guidance only and as such must be considered incorrect. Potential buyers are advised to recheck measurements before committing to any expense. 4. We have not tested any apparatus, equipment, fixtures, fittings or services and it is in the buyers interest to check the working condition of any appliances.

Connells Residential is registered in England and Wales under company number 1489613, Registered Office is Cumbria House, 16-20 Hockliffe Street, Leighton Buzzard, Bedfordshire, LU7 1GN. VAT Registration Number is 500 2481 05.

See all our properties at www.connells.co.uk | www.rightmove.co.uk | www.zoopla.co.uk

Property Ref: MKN318787 - 0006