



**Connells**

Johnson Close  
Marston Moretaine BEDFORD



# Johnson Close Marston Moretaine BEDFORD MK43 0JT

for sale guide price  
**£215,000**



## Property Description

Nestled in the charming village of Marston Moretaine, this delightful one bedroom property offers a perfect blend of comfort and convenience. Ideal for first-time buyers or investors, this home features a cosy living space, a well-equipped kitchen, and a generously sized bedroom. Enjoy the tranquility of village life with easy access to local amenities and transport links. The property boasts a private garden, perfect for relaxing or entertaining, and ample parking space. With its warm and inviting atmosphere.

Don't miss the opportunity to own this wonderful home in Marston Moretaine. Schedule a viewing today and experience the charm and potential this property has to offer.

## Entrance

Door to front, opening to living room.

## Living Room

13' 6" x 8' 10" ( 4.11m x 2.69m )

Stairs rising to first floor, storage cupboard, single glazed windows to side and front aspect, electric heater.

## Kitchen

6' 9" x 6' 3" ( 2.06m x 1.91m )

Single glazed window. Wall to base fitted units, stainless steel sink with drainer, oven with extractor fan above, plumbing for washing machine, space for fridge and freezer, easy clean work surfaces.

## Rear Garden

Set away from the house, wooden shed, wooden fencing, gated access.

## First Floor

### Landing

Doors to bedroom and bathroom.

### Bedroom 1

13' 6" x 7' 4" ( 4.11m x 2.24m )

Built in wardrobe, three single glazed windows to front and side aspect, electric heater, loft access.

### Bathroom

Single glazed opaque window. Low level wc ,hand wash basin, panelled bath.

## Front Garden

Wooden fence perimeter with path leading to front door, small lawn area with flower bed borders and mature plants.













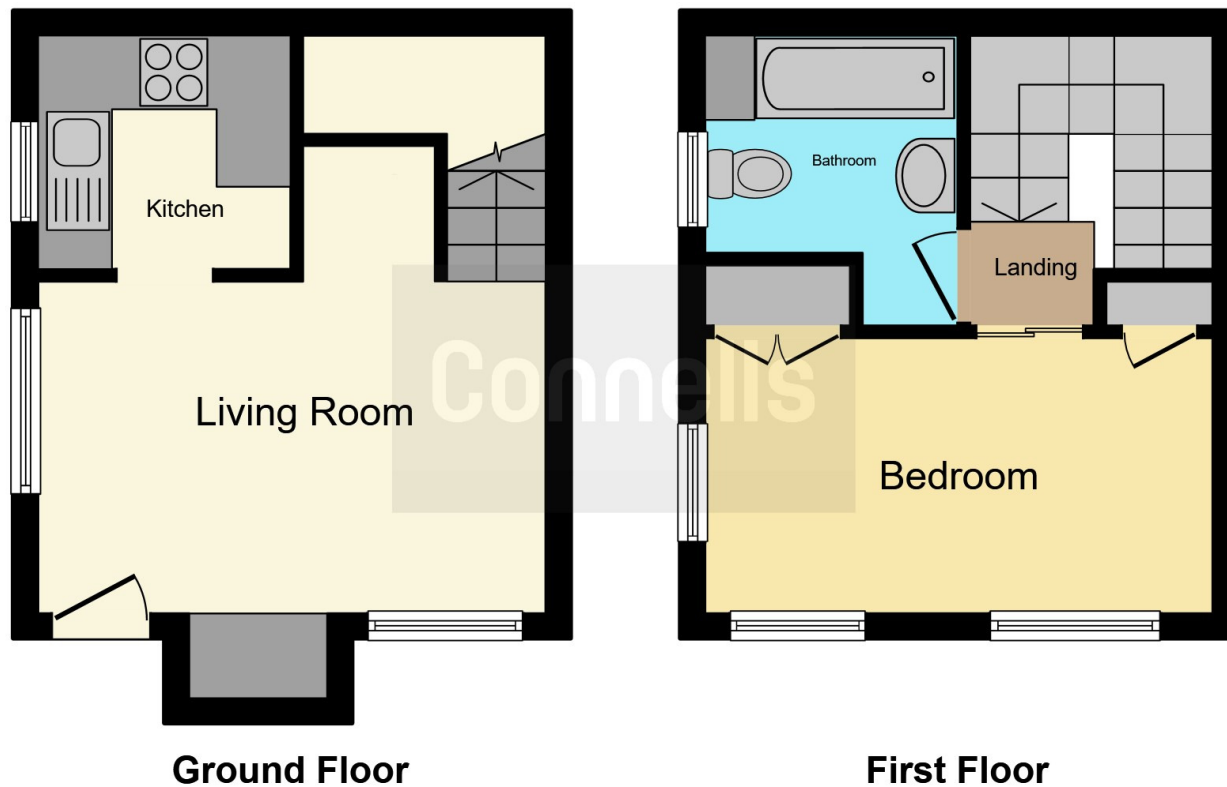

This floor plan is for illustrative purposes only. It is not drawn to scale. Any measurements, floor areas (including any total floor area), openings and orientation are approximate. No details are guaranteed, they cannot be relied upon for any purpose and they do not form part of any agreement. No liability is taken for any error, omission or misstatement. A party must rely upon its own inspection(s). Powered by [www.focalagent.com](http://www.focalagent.com)

To view this property please contact Connells on

**T 01525 712 271**  
**E [flitwick@connells.co.uk](mailto:flitwick@connells.co.uk)**

Unit 9 Russell Centre Coniston Road Flitwick  
 BEDFORD MK45 1QY

EPC Rating: C Council Tax  
 Band: A

Tenure: Freehold

**view this property online [connells.co.uk/Property/FLI305560](http://connells.co.uk/Property/FLI305560)**



1. MONEY LAUNDERING REGULATIONS Intending purchasers will be asked to produce identification documentation at a later stage and we would ask for your co-operation in order that there will be no delay in agreeing the sale. 2. These particulars do not constitute part or all of an offer or contract. 3. The measurements indicated are supplied for guidance only and as such must be considered incorrect. Potential buyers are advised to recheck measurements before committing to any expense. 4. We have not tested any apparatus, equipment, fixtures, fittings or services and it is in the buyers interest to check the working condition of any appliances.

Connells Residential is registered in England and Wales under company number 1489613, Registered Office is Cumbria House, 16-20 Hockliffe Street, Leighton Buzzard, Bedfordshire, LU7 1GN. VAT Registration Number is 500 2481 05.

**See all our properties at [www.connells.co.uk](http://www.connells.co.uk) | [www.rightmove.co.uk](http://www.rightmove.co.uk) | [www.zoopla.co.uk](http://www.zoopla.co.uk)**

Property Ref: FLI305560 - 0009