



**Connells**

Pitchfork Way  
Houghton Conquest Bedford





## Property Description

This immaculate throughout, two bedroom end of terrace home, offers a modern kitchen diner which opens to the rear garden, a low maintenance garden perfect for entertaining and al fresco dining, a cloakroom and well proportioned living room. Off road parking for two vehicles. Within the sought after location of Houghton Conquest. Early viewing is advised !

### Entrance

Door to front, hall with radiator.

### Cloak Room

Low level wc, hand wash basin, radiator.

### Living Room

15' 11" x 10' 4" ( 4.85m x 3.15m )

Double glazed window to front aspect, radiator, tv point. Stairs rising to first floor.

### Kitchen

11' 3" x 13' 2" ( 3.43m x 4.01m )

Wall to base fitted units, easy clean work surfaces, stainless steel sink, integrated oven with hob and extractor hood above, space for fridge freezer, double glazed French patio doors to rear garden with full length windows to either side, radiator, spotlights to ceiling. Space for dining furniture.

## First Floor

### Landing

Radiator, doors to bedrooms and bathroom, loft access, airing cupboard.

### Bedroom 1

8' 10" x 11' 5" ( 2.69m x 3.48m )

Double glazed window, radiator, fitted mirrored wardrobes.

### Bedroom 2

7' 10" x 3' 3" ( 2.39m x 0.99m )

Double glazed window, radiator.

### Bathroom

Panelled bath with shower over, low level wc, hand wash basin, spot lights to ceiling, shaver point, tiling, extractor fan, chrome towel radiator.

## Outside

### Front Garden

Block paved drive for off road parking for up to two vehicles, paved path to front door, planting area with shingle space for potted plants. Side gate access.

### Rear Garden

Mostly laid to lawn, side gate access, patio area, wooden shed, wooden fencing.













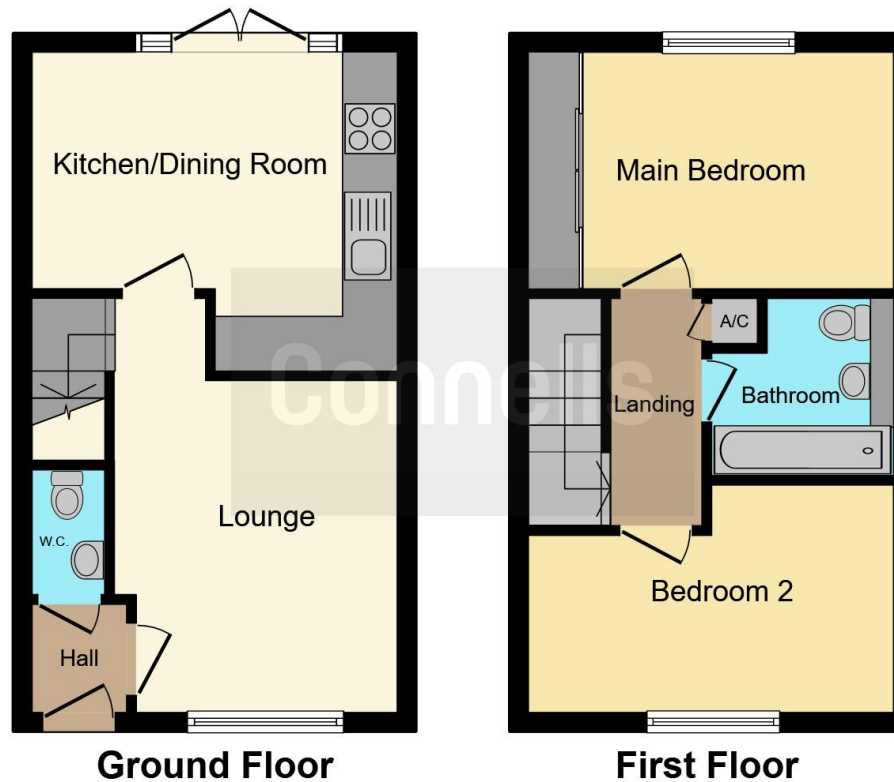

This floor plan is for illustrative purposes only. It is not drawn to scale. Any measurements, floor areas (including any total floor area), openings and orientation are approximate. No details are guaranteed, they cannot be relied upon for any purpose and they do not form part of any agreement. No liability is taken for any error, omission or misstatement. A party must rely upon its own inspection(s). Powered by [www.focalagent.com](http://www.focalagent.com)

To view this property please contact Connells on

**T 01525 712 271**  
**E [flitwick@connells.co.uk](mailto:flitwick@connells.co.uk)**

Unit 9 Russell Centre Coniston Road Flitwick  
 BEDFORD MK45 1QY

**EPC Rating: B**

Tenure: Freehold

**view this property online [connells.co.uk/Property/FLI305177](http://connells.co.uk/Property/FLI305177)**



1. MONEY LAUNDERING REGULATIONS Intending purchasers will be asked to produce identification documentation at a later stage and we would ask for your co-operation in order that there will be no delay in agreeing the sale. 2. These particulars do not constitute part or all of an offer or contract. 3. The measurements indicated are supplied for guidance only and as such must be considered incorrect. Potential buyers are advised to recheck measurements before committing to any expense. 4. We have not tested any apparatus, equipment, fixtures, fittings or services and it is in the buyers interest to check the working condition of any appliances.

Connells Residential is registered in England and Wales under company number 1489613, Registered Office is Cumbria House, 16-20 Hockliffe Street, Leighton Buzzard, Bedfordshire, LU7 1GN. VAT Registration Number is 500 2481 05.

**See all our properties at [www.connells.co.uk](http://www.connells.co.uk) | [www.rightmove.co.uk](http://www.rightmove.co.uk) | [www.zoopla.co.uk](http://www.zoopla.co.uk)**

Property Ref: FLI305177 - 0006