



Connells

Goldington Avenue
Bedford



Property Description

This charming one-bedroom ground floor flat in Bedford offers convenience and privacy, perfect for first-time buyers or investors. Featuring its own front door (no communal entrance), the property ensures a sense of independence and easy access.

The flat is well-presented throughout, boasting a bright living area, a comfortable bedroom, a fitted kitchen, and a modern bathroom. Located just a 6-minute drive from Bedford train station, being ideal for commuters.

Additional benefits include private parking at the rear and the advantage of being sold chain free for a smooth purchase process. A fantastic opportunity in a sought-after location!

Entrance Hall

Lounge

13' 4" x 11' 1" (4.06m x 3.38m)

Bedroom One

7' 8" x 7' 6" (2.34m x 2.29m)

Bathroom







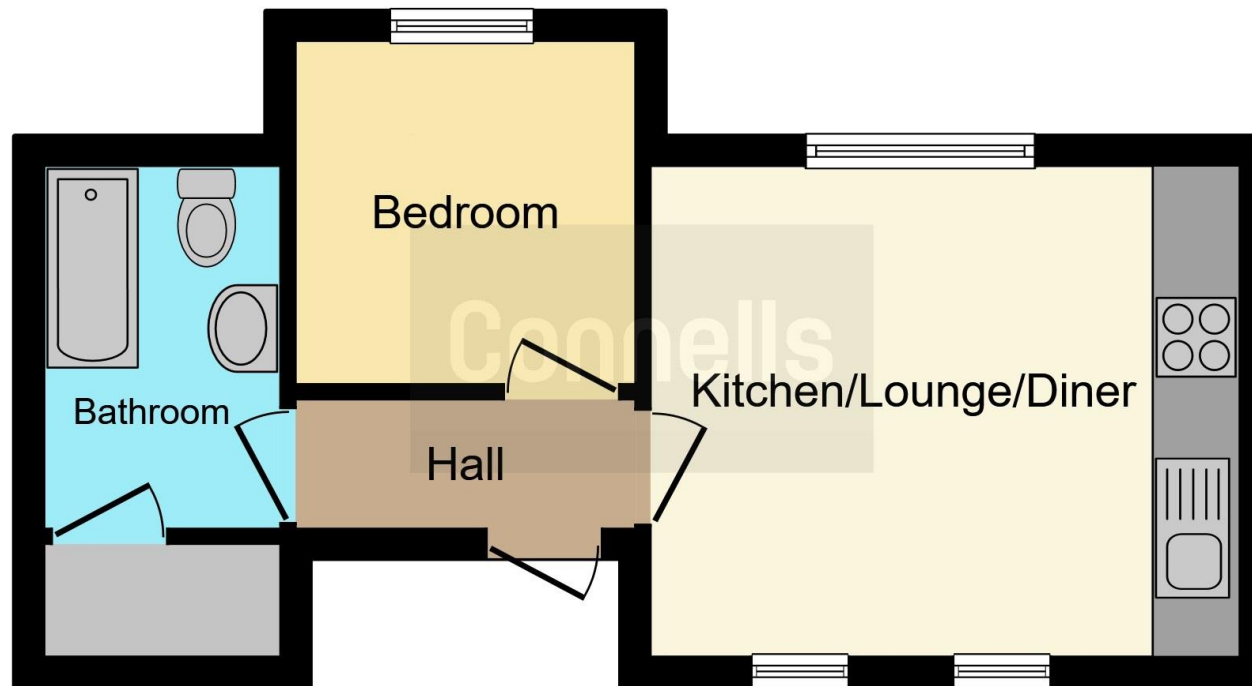

This floor plan is for illustrative purposes only. It is not drawn to scale. Any measurements, floor areas (including any total floor area), openings and orientation are approximate. No details are guaranteed, they cannot be relied upon for any purpose and they do not form part of any agreement. No liability is taken for any error, omission or misstatement. A party must rely upon its own inspection(s). Powered by www.focalagent.com

To view this property please contact Connells on

T 01234 345 303
E bedford@connells.co.uk

42 Allhallows
 BEDFORD MK40 1LN

EPC Rating: D

Tenure: Leasehold

view this property online connells.co.uk/Property/BED312256

This is a Leasehold property. We are awaiting further details about the Term of the lease. For further information please contact the branch. Please note additional fees could be incurred for items such as Leasehold packs.



1. MONEY LAUNDERING REGULATIONS Intending purchasers will be asked to produce identification documentation at a later stage and we would ask for your co-operation in order that there will be no delay in agreeing the sale. 2. These particulars do not constitute part or all of an offer or contract. 3. The measurements indicated are supplied for guidance only and as such must be considered incorrect. Potential buyers are advised to recheck measurements before committing to any expense. 4. We have not tested any apparatus, equipment, fixtures, fittings or services and it is in the buyers interest to check the working condition of any appliances.

Connells Residential is registered in England and Wales under company number 1489613, Registered Office is Cumbria House, 16-20 Hockliffe Street, Leighton Buzzard, Bedfordshire, LU7 1GN. VAT Registration Number is 500 2481 05.

See all our properties at www.connells.co.uk | www.rightmove.co.uk | www.zoopla.co.uk

Property Ref: BED312256 - 0005