



Connells

Saltdean Close
Luton



Property Description

Connells Stopsley bring to the market a five bedroom mid terraced property located in the sought after Putteridge area of Stopsley. Saltdean Close briefly comprises of an entrance hall, cloakroom, kitchen area, open plan lounge/diner, conservatory. The first floor contains three bedrooms and family bathroom suite. The second floor via loft conversion contains two additional bedrooms. Externally the property benefits from off street parking for multiple vehicles, to the rear the garden contains a blend of patio and laid to lawn area.

Saltdean Close is within walking distance to all local amenities. Located within the Putteridge School catchment area and with fantastic transport links throughout Stopsley and Luton and just a short drive from the M1 and Luton Parkway Stations The property is a must view. Call our Stopsley office on 01582 737069 to arrange your viewing.

Entrance Hall

Double glazed door to front. Radiator.

Cloakroom

Fitted with wall and base units. Integrated washing machine. Stainless steel sink drainer. Low level wc.

Lounge

10' 10" x 14' 2" (3.30m x 4.32m)
Double glazed window to rear. TV point.

Dining Room

8' 9" x 14' (2.67m x 4.27m)
Double glazed patio doors to rear.

Kitchen

10' 9" x 9' 6" (3.28m x 2.90m)
Fitted with wall and base units. Sink drainer. Work surfaces. Electric oven. Gas hob. Cooker hood. Integrated dishwasher, fridge freezer and microwave. Double glazed window to front.

Conservatory

9' 6" x 9' 2" (2.90m x 2.79m)
UPVC. Double glazed windows.
Double glazed door to side.

Landing

Bedroom One

14' 3" x 10' 11" (4.34m x 3.33m)
Double glazed window to rear.
Radiator. TV point. Fitted wardrobes.

Bedroom Two

8' 10" x 14' 3" (2.69m x 4.34m)
Double glazed window to rear.
Radiator. Fitted wardrobes.

Bedroom Three

9' 7" x 12' 5" (2.92m x 3.78m)
Double glazed window to front.
Radiator. Fitted wardrobes.

Bathroom

Fitted with low level wc. Wash hand basin. Bath with mixer taps. Shower cubicle. Radiator. Double glazed window to front.

Second Floor

Double glazed window to side.

Bedroom Four

8' 10" x 10' 10" (2.69m x 3.30m)
Double glazed window to side and front. Radiator. Fitted wardrobes.

Bedroom Five

13' 6" x 10' 11" (4.11m x 3.33m)
Double glazed window to rear.
Radiator. Fitted wardrobes. TV point.

Outside

Front Garden

Rear Garden



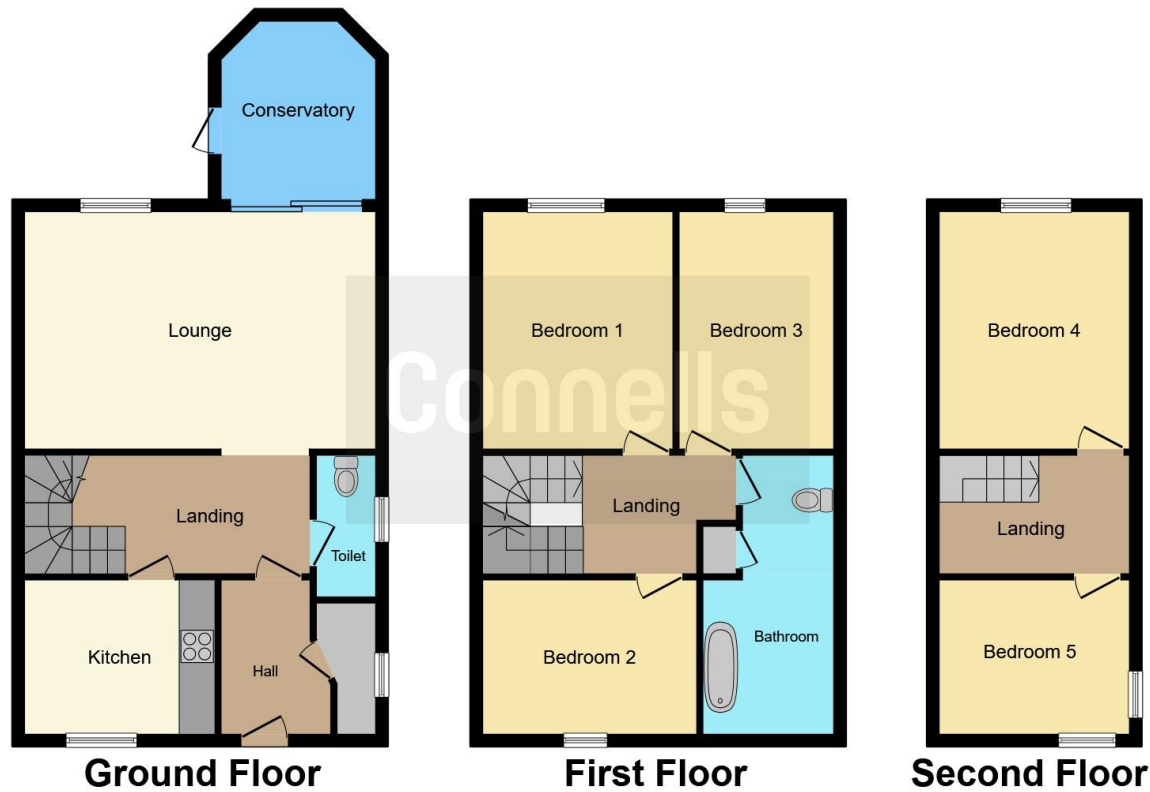

This floor plan is for illustrative purposes only. It is not drawn to scale. Any measurements, floor areas (including any total floor area), openings and orientation are approximate. No details are guaranteed, they cannot be relied upon for any purpose and they do not form part of any agreement. No liability is taken for any error, omission or misstatement. A party must rely upon its own inspection(s). Powered by www.focalagent.com

To view this property please contact Connells on

T 01582 737 069
E stopsley@connells.co.uk

Jansel House Parade 656 Hitchin Road Stopsley
 LUTON LU2 7XH

EPC Rating: C

view this property online connells.co.uk/Property/STP307366

Tenure: Freehold



1. MONEY LAUNDERING REGULATIONS Intending purchasers will be asked to produce identification documentation at a later stage and we would ask for your co-operation in order that there will be no delay in agreeing the sale. 2. These particulars do not constitute part or all of an offer or contract. 3. The measurements indicated are supplied for guidance only and as such must be considered incorrect. Potential buyers are advised to recheck measurements before committing to any expense. 4. We have not tested any apparatus, equipment, fixtures, fittings or services and it is in the buyers interest to check the working condition of any appliances.

Connells Residential is registered in England and Wales under company number 1489613, Registered Office is Cumbria House, 16-20 Hockliffe Street, Leighton Buzzard, Bedfordshire, LU7 1GN. VAT Registration Number is 500 2481 05.

See all our properties at www.connells.co.uk | www.rightmove.co.uk | www.zoopla.co.uk

Property Ref: STP307366 - 0005