





# Westminster Gardens Houghton Regis Dunstable LU5 5RT

for sale offers in excess of  
**£250,000**



## Property Description

\*TWO DOUBLE BEDROOMS\* \*TWO  
RECEPTION ROOMS\* \*GARAGE AND OFF  
ROAD PARKING TO REAR \*12FT LOUNGE\*  
\*EXCELLENT A5-M1 LINKS\*

A fantastic opportunity to own a three bedroom end terrace home situated in the popular location of Houghton Regis - close to local amenities and a variety of good schools!

Accommodation comprises; entrance hall, 12ft lounge, kitchen/diner, three goodsized bedroom and family bathroom. Outside, the home benefits from a front and rear garden with garage and off road parking to the rear garden.

Alongside this the property benefits from a desirable location featuring easy access to the A5/M1 for commuter links whilst still being close to good schools and local amenities.

This is an ideal purchase.

## Entrance Hall

Door to front aspect

## Lounge

12' 7" x 13' 9" ( 3.84m x 4.19m )

Window to front aspect

## Kitchen

10' 9" x 17' 1" ( 3.28m x 5.21m )

Fitted kitchen, wall and base units, double glazed window to rear aspect, work surfaces, one bowl sink / drainer, cooker hood, integrated oven and hob, space for fridge and freezer, space for washing machine.

## Bedroom One

10' 9" x 7' 7" ( 3.28m x 2.31m )

Window to rear aspect, radiator, carpeted flooring.

## Bedroom Two

11' 9" x 6' 9" ( 3.58m x 2.06m )

radiator, carpeted flooring.

## Bedroom Three

9' 5" x 7' 7" ( 2.87m x 2.31m )

Window to rear aspect, Bath with overhead shower, w/c, wash hand basin.

## Bathroom

Window to rear aspect, Bath with overhead shower, w/c, wash hand basin.

## Outside

Patio, laid to lawn

## Front Garden

## Rear Garden















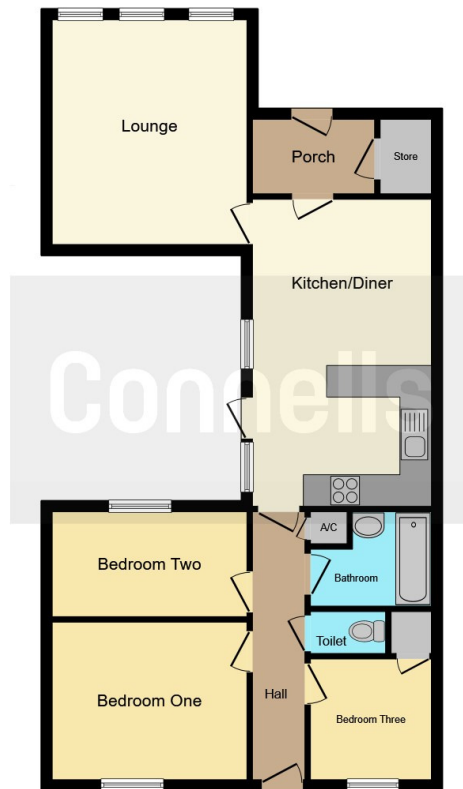

This floor plan is for illustrative purposes only. It is not drawn to scale. Any measurements, floor areas (including any total floor area), openings and orientation are approximate. No details are guaranteed, they cannot be relied upon for any purpose and they do not form part of any agreement. No liability is taken for any error, omission or misstatement. A party must rely upon its own inspection(s). Powered by [www.focalagent.com](http://www.focalagent.com)

To view this property please contact Connells on

**T 01582 661 265**  
**E [dunstable@connells.co.uk](mailto:dunstable@connells.co.uk)**

19 High Street North  
 DUNSTABLE LU6 1HX

**EPC Rating: D**

Tenure: Freehold

**view this property online [connells.co.uk/Property/DUN311476](http://connells.co.uk/Property/DUN311476)**



1. MONEY LAUNDERING REGULATIONS Intending purchasers will be asked to produce identification documentation at a later stage and we would ask for your co-operation in order that there will be no delay in agreeing the sale. 2. These particulars do not constitute part or all of an offer or contract. 3. The measurements indicated are supplied for guidance only and as such must be considered incorrect. Potential buyers are advised to recheck measurements before committing to any expense. 4. We have not tested any apparatus, equipment, fixtures, fittings or services and it is in the buyers interest to check the working condition of any appliances.

Connells Residential is registered in England and Wales under company number 1489613, Registered Office is Cumbria House, 16-20 Hockliffe Street, Leighton Buzzard, Bedfordshire, LU7 1GN. VAT Registration Number is 500 2481 05.

**See all our properties at [www.connells.co.uk](http://www.connells.co.uk) | [www.rightmove.co.uk](http://www.rightmove.co.uk) | [www.zoopla.co.uk](http://www.zoopla.co.uk)**

Property Ref: DUN311476 - 0008