



Connells

Chelsea Gardens
Houghton Regis Dunstable



Property Description

Located in Houghton Regis this five bedroom town house is ideally situated on a no through road and is within close proximity to green spaces, local bus routes and shops.

The home comprises of ground floor; entrance hall, W/C, kitchen and a separate living/diner with patio doors to the rear garden. First floor; landing, master bedroom and bedroom two. Second floor; landing, bedroom three, bedroom four, bedroom five along with the family bathroom.

This five bedroom home benefits from gas central heating and a garage En-block. Perfectly suited for growing families or as an ideal investment opportunity. Call Connells now for more information and to book a viewing.

Entrance Hall

Laminated flooring, cupboard.

Cloakroom

Window to front aspect. Toilet and wash hand basin.

Lounge

15' 9" x 12' 4" (4.80m x 3.76m)

Laminated flooring, patio doors to garden.

Kitchen

14' 8" x 9' 4" (4.47m x 2.84m)

Window to front, integrated oven and hob.

First Floor Landing

Carpeted

Bedroom One

15' 9" x 12' 4" (4.80m x 3.76m)

Laminated flooring, window to rear aspect.

Bedroom Two

14' 11" x 9' 3" (4.55m x 2.82m)

Carpeted flooring, window to front aspect, built in wardrobes.

Bedroom Three (2nd Floor)

13' 4" x 9' 5" (4.06m x 2.87m)

Carpeted flooring, window to front aspect, built in wardrobes.

Bedroom Four (2nd Floor)

14' 6" x 8' 3" (4.42m x 2.51m)

Carpeted flooring, window to rear aspect.

Bedroom Five (2nd Floor)

9' 8" x 7' 3" (2.95m x 2.21m)

Carpeted flooring, window to rear aspect.

Bathroom

Window to front aspect, electric shower over

bath, three piece suite.

Front Garden

Paved,

Rear Garden

Paved.

Second Floor Landing

Carpeted flooring, airing cupboard.







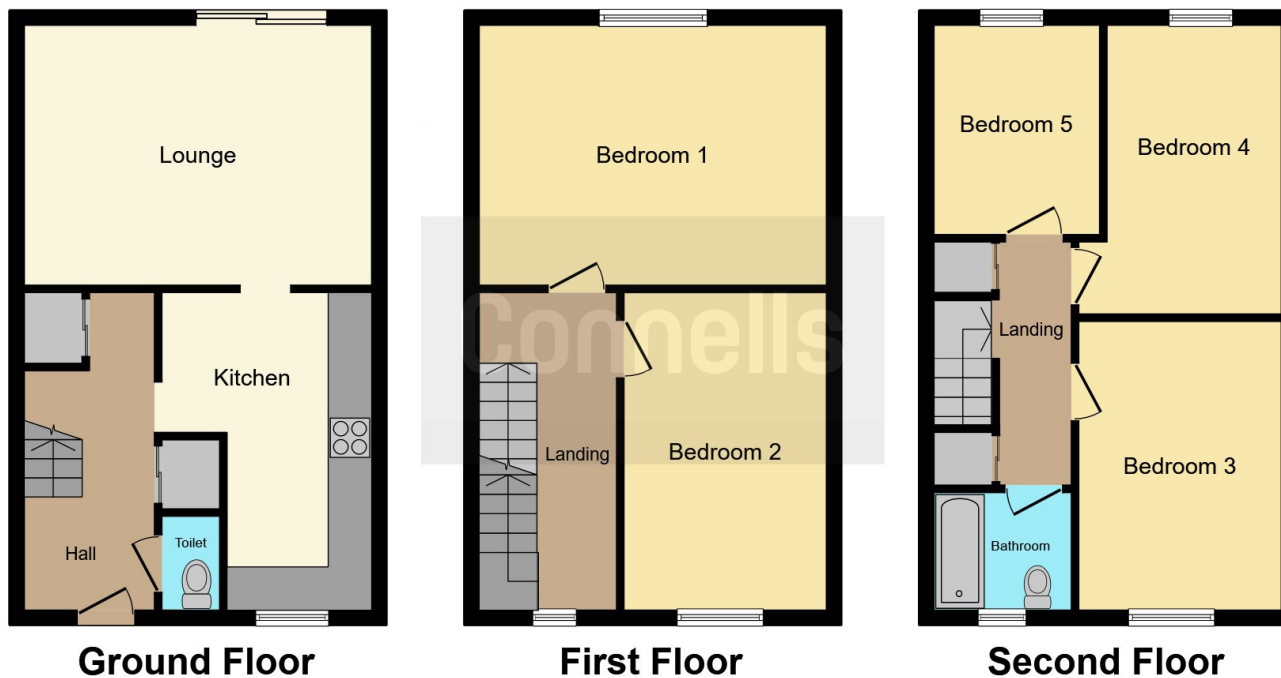

This floorplan is for illustrative purposes only and is not drawn to scale. Measurements, floor-areas, openings and orientations are approximate. They should not be relied upon for any purpose and do not form any part of an agreement. No liability is taken for any error or mis-statement. All parties must rely on their own inspections.

To view this property please contact Connells on

T 01582 661 265
E dunstable@connells.co.uk

19 High Street North
 DUNSTABLE LU6 1HX

EPC Rating: D

view this property online connells.co.uk/Property/DUN310840

Tenure: Freehold



1. MONEY LAUNDERING REGULATIONS Intending purchasers will be asked to produce identification documentation at a later stage and we would ask for your co-operation in order that there will be no delay in agreeing the sale. 2. These particulars do not constitute part or all of an offer or contract. 3. The measurements indicated are supplied for guidance only and as such must be considered incorrect. Potential buyers are advised to recheck measurements before committing to any expense. 4. We have not tested any apparatus, equipment, fixtures, fittings or services and it is in the buyers interest to check the working condition of any appliances.

Connells Residential is registered in England and Wales under company number 1489613, Registered Office is Cumbria House, 16-20 Hockliffe Street, Leighton Buzzard, Bedfordshire, LU7 1GN. VAT Registration Number is 500 2481 05.

See all our properties at www.connells.co.uk | www.rightmove.co.uk | www.zoopla.co.uk

Property Ref: DUN310840 - 0007