



Connells

High Dane
Hitchin



Property Description

With fantastic potential to improve and extend, this three bedroom semi-detached could make a fantastic family home. The ground floor accommodation has a large reception to the front, fitted kitchen and ground floor family bathroom. The first floor has three double bedrooms and a W.C. The property benefits further from a driveway for multiple vehicles and has a large private rear garden of approximately 100 ft in length.

Ground Floor

Entrance Hall

Door to side, double glazed window to side aspect, two small storage areas, wood effect flooring and radiator.

Lounge

16' 6" into recess x 11' 11" (5.03m into recess x 3.63m)

Double glazed bay window to front aspect, double glazed window to front aspect, feature fireplace, wood effect flooring and radiator.

Kitchen

14' 7" x 8' 6" (4.45m x 2.59m)

Fully fitted kitchen with double glazed window and door to rear aspect, a range of wall and base units, freestanding oven, space for all white goods, boiler, spotlights, vinyl flooring and radiator. Access to bathroom.

Bathroom

Double glazed window to rear aspect, wash hand basin, panelled bath with handheld shower, WC, storage, partly tiled, vinyl flooring and radiator.

First Floor

Landing

Double glazed window to side aspect, storage, loft access and access to all first floor accommodation.

Bedroom One

Double glazed window to front aspect and radiator.

W.C.

Double glazed window to side aspect, wash hand basin, WC, vinyl flooring and radiator.

Bedroom Two

12' 3" into recess x 8' 5" (3.73m into recess x 2.57m)

Double glazed window to rear aspect and radiator.

Bedroom Three

7' 11" x 9' 4" (2.41m x 2.84m)

Double glazed window to front and side aspects and radiator.

Outside

Front Garden

Driveway for two vehicles.

Rear Garden

Block paved patio area, lawn approx. 100 ft, outdoor tap and shrubs.

Timber Outbuilding

Timber-built outbuilding.



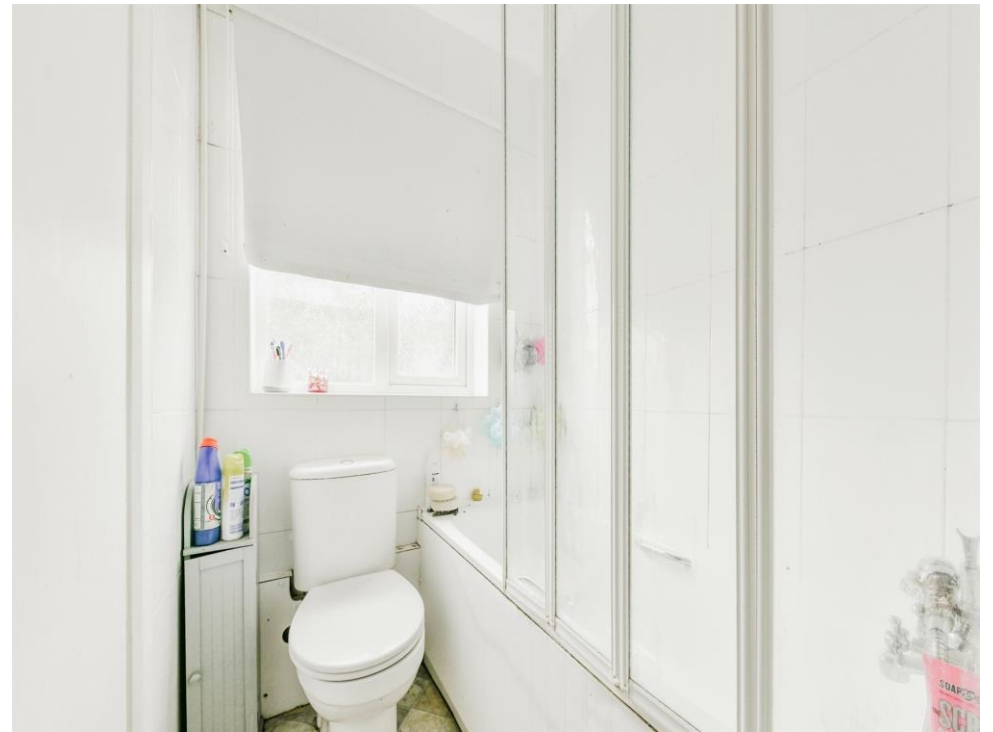



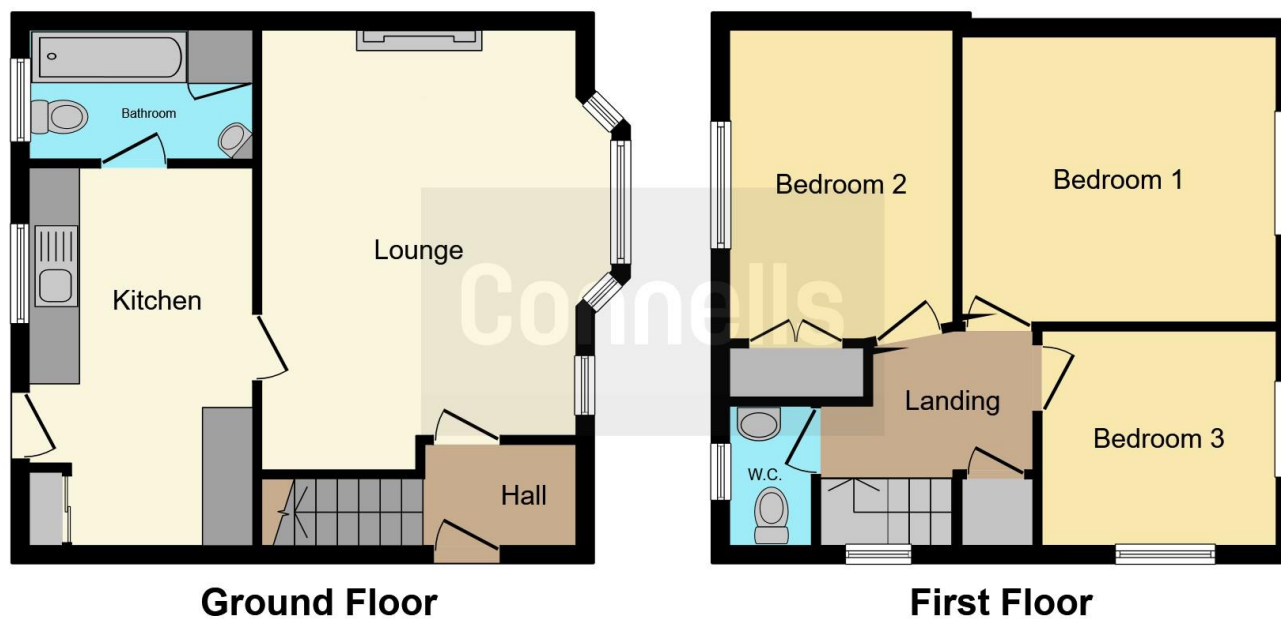

This floor plan is for illustrative purposes only. It is not drawn to scale. Any measurements, floor areas (including any total floor area), openings and orientation are approximate. No details are guaranteed, they cannot be relied upon for any purpose and they do not form part of any agreement. No liability is taken for any error, omission or misstatement. A party must rely upon its own inspection(s). Powered by www.focalagent.com

To view this property please contact Connells on

T 01462 437 666
E hitchin@connells.co.uk

14 High Street
 HITCHIN SG5 1AT

EPC Rating: D

view this property online connells.co.uk/Property/HIT307777

Tenure: Freehold



1. MONEY LAUNDERING REGULATIONS Intending purchasers will be asked to produce identification documentation at a later stage and we would ask for your co-operation in order that there will be no delay in agreeing the sale. 2. These particulars do not constitute part or all of an offer or contract. 3. The measurements indicated are supplied for guidance only and as such must be considered incorrect. Potential buyers are advised to recheck measurements before committing to any expense. 4. We have not tested any apparatus, equipment, fixtures, fittings or services and it is in the buyers interest to check the working condition of any appliances.

Connells Residential is registered in England and Wales under company number 1489613, Registered Office is Cumbria House, 16-20 Hockliffe Street, Leighton Buzzard, Bedfordshire, LU7 1GN. VAT Registration Number is 500 2481 05.

See all our properties at www.connells.co.uk | www.rightmove.co.uk | www.zoopla.co.uk

Property Ref: HIT307777 - 0003