



Connells

Leeson Drive
Ferndown



Property Description

Connells are delighted to present this detached bungalow in a popular area of Ferndown, with a modern open plan kitchen, lounge/Diner and double french doors to a good size rear garden, two double bedrooms, bathroom. The front of the property is tarmac driveway leading to the garage/workshop and mature shrubs.

Entrance Hall

Wooden laminated flooring with radiator and doors to all rooms.

Lounge/Diner

21' 10" MAX x 20' 8" MAX (6.65m MAX x 6.30m MAX)

Wooden laminated flooring with side aspect double glazed french doors to rear garden, tiled feature wall, TV and telephone point and radiator.

Kitchen

11' 2" MAX x 9' 9" MAX (3.40m MAX x 2.97m MAX)

Wooden laminated flooring with side aspect double glazed windows, a range of soft close wall and base units (some with internal lighting) sink with mixer tap, integrated 4 ring electric hob, eye level oven and microwave, integrated dishwasher and fridge freezer, space for a washing machine and benefiting from a breakfast bar.

Bedroom 1

12' 2" x 11' 4" (3.71m x 3.45m)

Wooden laminated flooring with double glazed side aspect window and radiator below,

Bedroom 2

11' 4" x 9' 1" (3.45m x 2.77m)

Wooden laminated flooring with double glazed side aspect window, radiator below and built in wardrobe space,

Bathroom

Wooden laminated flooring with fully tiled walls, low level WC, floating hand wash basin with vanity unit below and light up vanity mirror over, panel bath with shower over and glass shower screen and ladder radiator.

Front Garden

Hardstanding driveway for multiple vehicles and part laid to lawn with mature shrubs.

Rear Garden

Fenced enclosed rear garden mainly laid to lawn with part decked area and side gated entrance to driveway.

Garage

16' 5" x 8' 5" (5.00m x 2.57m)

Up and over door with electric.







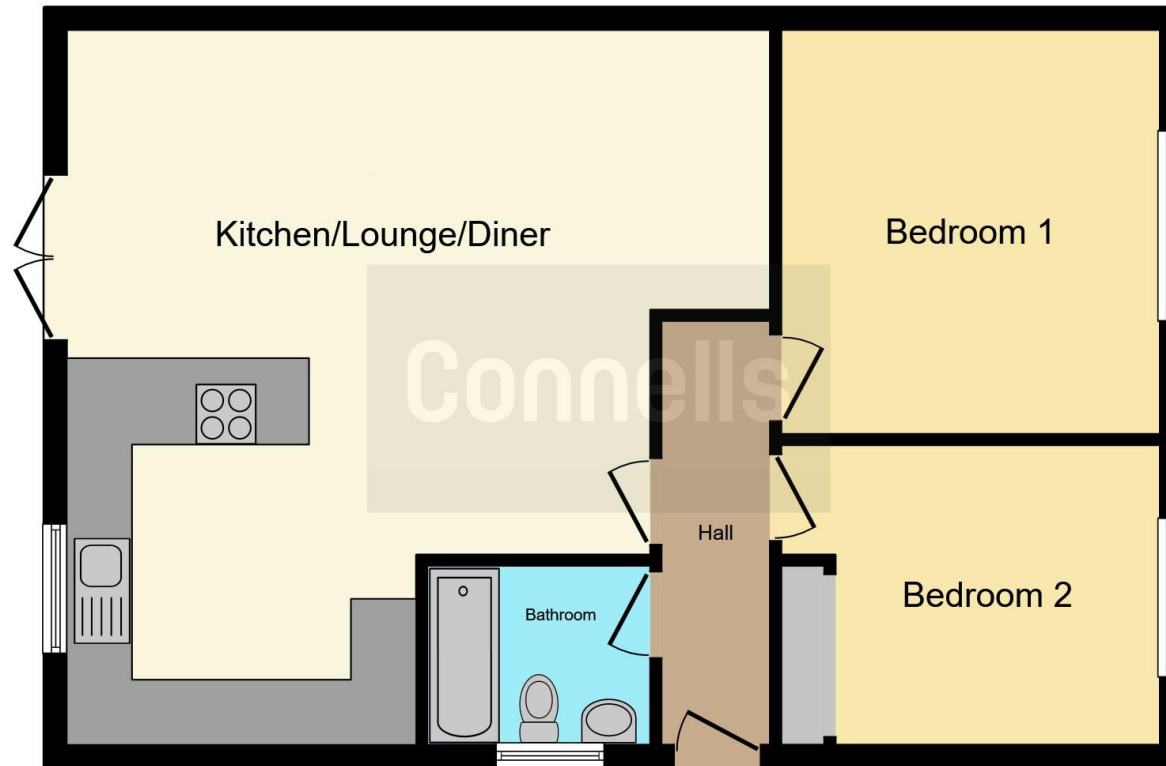

This floor plan is for illustrative purposes only. It is not drawn to scale. Any measurements, floor areas (including any total floor area), openings and orientation are approximate. No details are guaranteed, they cannot be relied upon for any purpose and they do not form part of any agreement. No liability is taken for any error, omission or misstatement. A party must rely upon its own inspection(s). Powered by www.focalagent.com

To view this property please contact Connells on

T 01258 452 327

E blandfordforum@connells.co.uk

20 Salisbury Street
BLANDFORD FORUM DT11 7AR

EPC Rating: D

Tenure: Freehold

view this property online connells.co.uk/Property/FDN306055



1. MONEY LAUNDERING REGULATIONS Intending purchasers will be asked to produce identification documentation at a later stage and we would ask for your co-operation in order that there will be no delay in agreeing the sale. 2. These particulars do not constitute part or all of an offer or contract. 3. The measurements indicated are supplied for guidance only and as such must be considered incorrect. Potential buyers are advised to recheck measurements before committing to any expense. 4. We have not tested any apparatus, equipment, fixtures, fittings or services and it is in the buyers interest to check the working condition of any appliances.

Connells Residential is registered in England and Wales under company number 1489613, Registered Office is Cumbria House, 16-20 Hockliffe Street, Leighton Buzzard, Bedfordshire, LU7 1GN. VAT Registration Number is 500 2481 05.

See all our properties at www.connells.co.uk | www.rightmove.co.uk | www.zoopla.co.uk

Property Ref: FDN306055 - 0002