



Connells

Woodcutter Close Woodcutter Close
Three Legged Cross Wimborne

Woodcutter Close Woodcutter Close Three Legged Cross Wimborne BH21 6FR

for sale
£550,000



Property Description

Plot 9 is a 4-bedroom detached home located in Three Legged Cross.

Situated in this picturesque location, it offers a spacious living area, private rear garden, driveway parking, and a detached single garage. The kitchen boasts a stylish design with a soft cream shaker style, copper handles, marble stone effect composite laminate worktop, and modern appliances. French doors lead to the south-facing garden with a patio and shrub flowerbeds.

The well-lit lounge features front and rear elevation windows, and there's a second patio area to the rear. The ground floor includes a WC with a concealed cistern, wall-hung basin, and chrome heated towel rail. The first floor comprises four bedrooms, with bedroom one having a mirrored wardrobe and en-suite. Bedrooms two and three offer rear-facing views, with bedroom Four holding a front aspect location and there's a well-equipped family bathroom. The property has solid oak features and neutral decoration throughout. For your convenience and peace of mind a Veritas security system has been fitted to the property. White UPVC double glazed windows and French doors are installed, and the garage is equipped with power and light.

Measurements detail the generous kitchen diner, lounge, and bedrooms.



Location

Many choose to live in Three Legged Cross, Dorset for various reasons such as its semi-rural setting, community atmosphere, proximity to amenities, with Ferndown only a short 6.6 miles away and a short drive of 25 mins (12.9 miles) takes you to the beautiful Dorset coastline that can be enjoyed at your leisure.

Measurements - Maximum

Kitchen/diner - 23.5 x 10.10

Sitting room - 11.2 X 21.3

Bedroom 1 - 10.9x 11.8

Bedroom 2 - 9.4 x 11.3

Bedroom 3 - 10.91x 9.4

Bedroom 4 - 7.10 x 11.6

Spec Detail

- Soft cream Shaker style kitchen with copper handles and soft close hinges.
- Marble stone effect, slim profile with square edged composite laminate worktop and Quartz's effect 1 1/2 bowl sink and Blanco chrome finish tap.
 - Induction hob and single Bosch electric oven and Stainless chimney style extractor hood
 - Space and plumbing for washing machine.
 - Integrated Slim-line dishwasher
 - Integrated fridge freezer
 - Internal Solid oak doors and matching Oak hand rail to stairs
 - UPVC double glazing throughout
 - Composite front door
 - Fully landscaped gardens, including patio and lawn areas and flower beds.
 - Glow Worm - Combi boiler
 - Veritas security system fitted
 - Modern White 3 piece bathroom suite and complementary stone effect ceramic tiles

- Flooring fitted throughout from wood effect ceramic tiles in the kitchen and WC areas, deep pile soft touch Carpets in all bedrooms, sitting rooms and hall, stairs and landing.







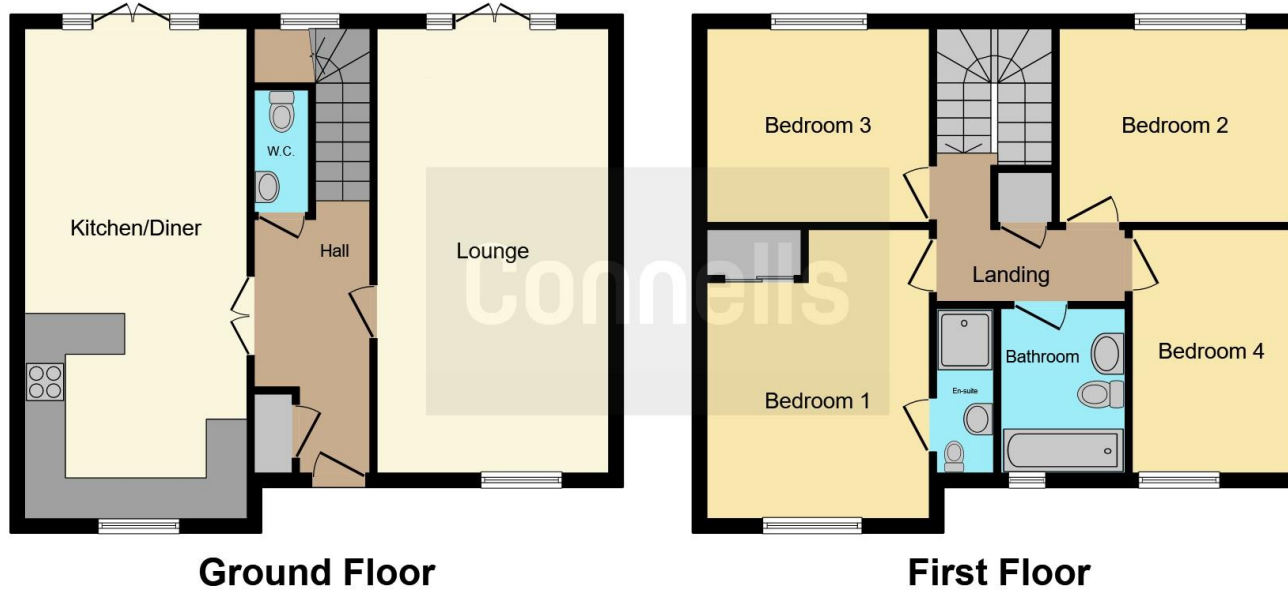

This floorplan is for illustrative purposes only and is not drawn to scale. Measurements, floor-areas, openings and orientations are approximate. They should not be relied upon for any purpose and do not form any part of an agreement. No liability is taken for any error or mis-statement. All parties must rely on their own inspections.

To view this property please contact Connells on

T 01202 861 677
E ferndown@connells.co.uk

37 Victoria Road
 FERNDOWN BH22 9HT

EPC Rating: Exempt

Tenure: Freehold

view this property online connells.co.uk/Property/FDN305740



1. MONEY LAUNDERING REGULATIONS Intending purchasers will be asked to produce identification documentation at a later stage and we would ask for your co-operation in order that there will be no delay in agreeing the sale. 2. These particulars do not constitute part or all of an offer or contract. 3. The measurements indicated are supplied for guidance only and as such must be considered incorrect. Potential buyers are advised to recheck measurements before committing to any expense. 4. We have not tested any apparatus, equipment, fixtures, fittings or services and it is in the buyers interest to check the working condition of any appliances.

Connells Residential is registered in England and Wales under company number 1489613, Registered Office is Cumbria House, 16-20 Hockliffe Street, Leighton Buzzard, Bedfordshire, LU7 1GN. VAT Registration Number is 500 2481 05.

See all our properties at www.connells.co.uk | www.rightmove.co.uk | www.zoopla.co.uk

Property Ref: FDN305740 - 0002