



Connells

River Walk Cross Way
Christchurch



Property Description

Situated in the scenic town of Christchurch, Dorset, off Cross Way, this development comprises six bespoke detached four-bedroom homes, each with its own driveway parking and garage. Nestled in a quiet and secluded area, the properties offer a tranquil living environment while still being conveniently close to local amenities and natural attractions.

Features

Each home boasts four spacious bedrooms, providing ample accommodation for a growing family or guests. The master bedroom includes an en-suite shower room for added convenience and luxury.

The heart of these homes is the open plan kitchen, family dining room, offering stunning views over the turfed garden. The seamless flow of space is perfect for modern living and entertaining.

Upon entrance, you're greeted by solid oak staircases with glass and chrome detail, setting the tone for the quality finishes throughout. The ground floor features LVT flooring, while the lounge and bedrooms are carpeted for comfort.

The fully-fitted German kitchens are stylishly designed with grey slab effect units and quartz worktops. Integrated Siemens appliances, including a double oven, fridge freezer, induction hob, and dishwasher, make cooking and cleaning a breeze.

Enjoy the luxury of underfloor heating in all bathrooms and en-suites, adding warmth and comfort. High-quality fixtures and fittings create a spa-like atmosphere, while the family shower room and guest suite shower room offer convenience for busy households.

Step outside to the beautifully landscaped garden, complete with porcelain patios for al fresco dining and relaxation. The driveways are block paved for durability and aesthetic appeal, while natural stone cills and larch wood cladding enhance the exterior charm.

Stay warm and cozy with the Glowworm boiler heater system and conventional wall hung radiators. Ceiling spotlights and large windows flood the open plan family rooms with natural light, creating inviting spaces for everyday living.

Location

Crossways in Christchurch offers easy access to local shops, supermarkets, and services, ensuring all your daily needs are met. The town itself boasts a rich history, vibrant cultural scene, and beautiful natural surroundings, including rivers, parks, and beaches along the nearby Jurassic Coast.

These bespoke detached homes in Christchurch offer a perfect blend of luxury, comfort, and convenience in a sought-after location. Whether you're raising a family or enjoying retirement, this development provides the ideal setting for your next chapter.

Measurements

Kitchen/Diner/family room - 22.0 x 18.6 max
(central cooking island, complete with venting
induction hob)

Utility - 7.2 x 5.9 max - with external door to
rear side elevation

Lounge - 12.6 x 10.8 max (Extending into bay
by 2.2ft)

WC

Bedroom 1 - with en-suite shower room -
22.0 x 9.7 max

Bedroom 2 - with en-suite shower room -12.6
x 10.7 max

Bedroom 3 - with en-suite shower room - 12.6
x 10.7 max (with Bay window to front
elevation extending a further 2.2ft, situated on
the ground floor)

Bedroom 4 - 9.5 x 9.7 max

Family bathroom

Detached Double Garage - (Electric roll top
door to front elevation, with door to rear
elevation)Front and rear driveway parking
allowance for 4 cars



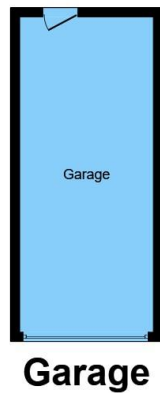
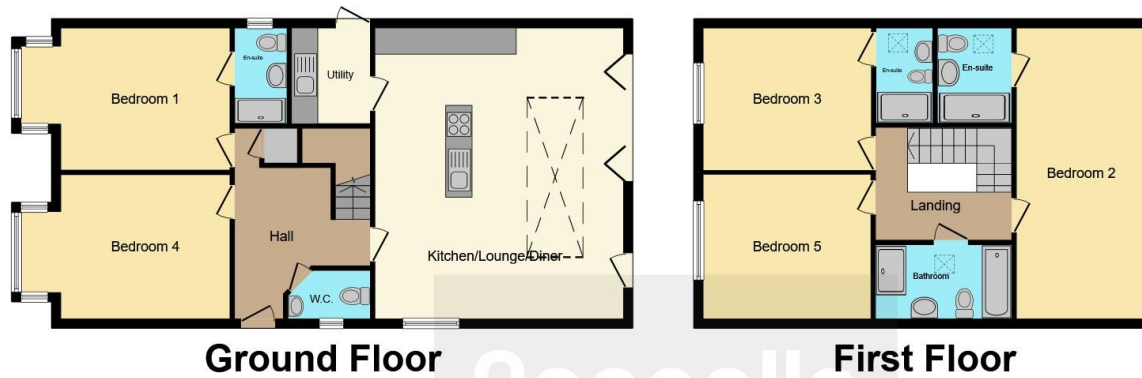

This floor plan is for illustrative purposes only. It is not drawn to scale. Any measurements, floor areas (including any total floor area), openings and orientation are approximate. No details are guaranteed, they cannot be relied upon for any purpose and they do not form part of any agreement. No liability is taken for any error, omission or misstatement. A party must rely upon its own inspection(s). Powered by www.focalagent.com

To view this property please contact Connells on

T 01202 423 281
E southbourne@connells.co.uk

73 Southbourne Grove
 BOURNEMOUTH BH6 3QU

EPC Rating: Exempt

view this property online connells.co.uk/Property/SBN305872

Tenure: Freehold



1. MONEY LAUNDERING REGULATIONS Intending purchasers will be asked to produce identification documentation at a later stage and we would ask for your co-operation in order that there will be no delay in agreeing the sale. 2. These particulars do not constitute part or all of an offer or contract. 3. The measurements indicated are supplied for guidance only and as such must be considered incorrect. Potential buyers are advised to recheck measurements before committing to any expense. 4. We have not tested any apparatus, equipment, fixtures, fittings or services and it is in the buyers interest to check the working condition of any appliances.

Connells Residential is registered in England and Wales under company number 1489613, Registered Office is Cumbria House, 16-20 Hockliffe Street, Leighton Buzzard, Bedfordshire, LU7 1GN. VAT Registration Number is 500 2481 05.

See all our properties at www.connells.co.uk | www.rightmove.co.uk | www.zoopla.co.uk

Property Ref: SBN305872 - 0002