



**Connells**

Hall Green Drive  
Exhall Coventry



## Property Description

This modern end of terrace family home is situated on Hall Green Drive in Bedworth close to local amenities, Bedworth town centre and the A444. The accommodation briefly comprises: ground floor guest w/c, lounge and a fitted kitchen. To the first floor there are three bedrooms and a fitted shower room. Outside there is allocated parking and a rear garden.

## Approach

Front door.

## Entrance Hall

Stairs to first floor.

## Lounge

16' 2" x 11' 3" ( 4.93m x 3.43m )

Double glazed doors opening onto the rear garden.

## Fitted Kitchen/Diner

16' 1" x 13' 1" ( 4.90m x 3.99m )

Wall and base mounted units incorporating an inset single drainer sink unit with work surfaces and tiled splashbacks over. Integrated electric oven and gas hob with cookerhood over, plumbing for automatic washing machine, space for domestic appliance, double glazed window to the front elevation.

## Guest W/C

Comprising, toilet, wash hand basin and double glazed window to the side elevation.

## First Floor Landing

Doors to;

### Bedroom One

13' 2" x 9' 1" ( 4.01m x 2.77m )

Double glazed window to the front elevation, built-in wardrobe and radiator.

### Bedroom Two

12' 4" x 7' ( 3.76m x 2.13m )

Double glazed window to the rear elevation.

### Bedroom Three

9' x 8' 9" ( 2.74m x 2.67m )

Double glazed window to the front elevation and radiator.

## Fitted Bathroom

Tiled, comprising bath with shower over, wash hand basin, toilet and double glazed window to the side elevation.

**Outside**

**Front Of Property**

Lawned area with access to front door.

**Rear Garden**



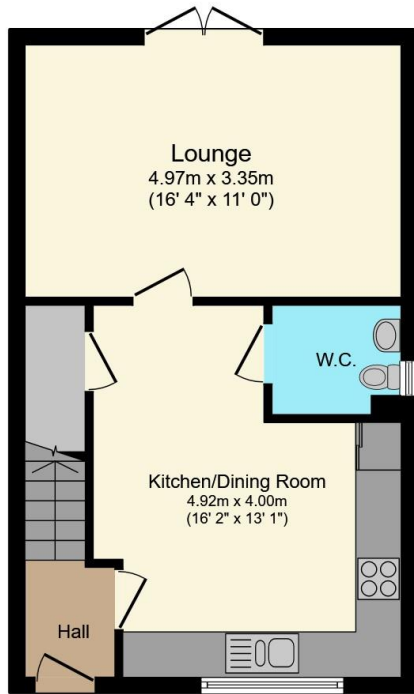

**Ground Floor**

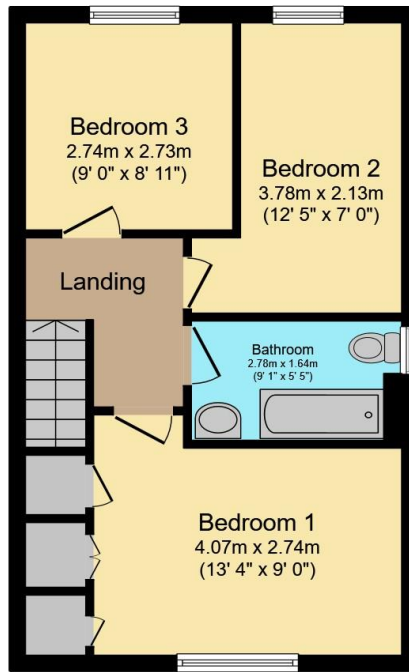

**First Floor**

Total floor area 83.1 m<sup>2</sup> (894 sq.ft.) approx

This floor plan is for illustrative purposes only. It is not drawn to scale. Any measurements, floor areas (including any total floor area), openings and orientation are approximate. No details are guaranteed, they cannot be relied upon for any purpose and they do not form part of any agreement. No liability is taken for any error, omission or misstatement. A party must rely upon its own inspection(s). Powered by [www.propertybox.io](http://www.propertybox.io)



To view this property please contact Connells on

**T 02476 553 093**

**E [coventry@connells.co.uk](mailto:coventry@connells.co.uk)**

38 New Union Street  
COVENTRY CV1 2HN

EPC Rating: B Council Tax  
Band: C

**view this property online [connells.co.uk/Property/COV322853](http://connells.co.uk/Property/COV322853)**

Tenure: Freehold



1. MONEY LAUNDERING REGULATIONS Intending purchasers will be asked to produce identification documentation at a later stage and we would ask for your co-operation in order that there will be no delay in agreeing the sale. 2. These particulars do not constitute part or all of an offer or contract. 3. The measurements indicated are supplied for guidance only and as such must be considered incorrect. Potential buyers are advised to recheck measurements before committing to any expense. 4. We have not tested any apparatus, equipment, fixtures, fittings or services and it is in the buyers interest to check the working condition of any appliances.

Connells Residential is registered in England and Wales under company number 1489613, Registered Office is Cumbria House, 16-20 Hockliffe Street, Leighton Buzzard, Bedfordshire, LU7 1GN. VAT Registration Number is 500 2481 05.

**See all our properties at [www.connells.co.uk](http://www.connells.co.uk) | [www.rightmove.co.uk](http://www.rightmove.co.uk) | [www.zoopla.co.uk](http://www.zoopla.co.uk)**

Property Ref: COV322853 - 0002