



**Connells**

South Holme  
Stourpaine Blandford Forum



# South Holme Stourpaine Blandford Forum DT11 8TG

for sale offers in the region of  
**£240,000**



## Property Description

Nestled away in the heart of Stourpaine sits this unique two bedroom home, benefiting from a garden, lounge, kitchen, bathroom and two double rooms.

The village of Stourpaine benefits from a post office, sports facilities, church and a public transport routes to Blandford Forum, Shaftesbury, Poole and Bournemouth and sits within a beautiful surrounding with many walks, riding paths and countryside.

### Lounge

12' 4" x 10' 8" ( 3.76m x 3.25m )

Carpeted with two side aspect double glazed windows and front door, exposed wooden beams, feature brick fireplace and stairs to the first floor.

### Kitchen

11' 2" x 7' 9" ( 3.40m x 2.36m )

Tiled floor and part tiled walls with a range of wall and base units, integrated oven with 4 ring electric hob and extractor fan and hood over, sink with drainer and mixer tap, space for washing machine and double-glazed rear aspect window and side aspect door to rear garden.

### Bedroom 1

12' 4" x 9' 2" ( 3.76m x 2.79m )

Carpeted with side and rear aspect window.

### Bedroom 2

12' 7" x 11' 9" ( 3.84m x 3.58m )

Carpeted with exposed beams and rear and side aspect windows with beautiful views over the country side.

### Bathroom

Part tiled walls with rear aspect double glazed window, low level WC, hand wash basin and panel bath with shower over.











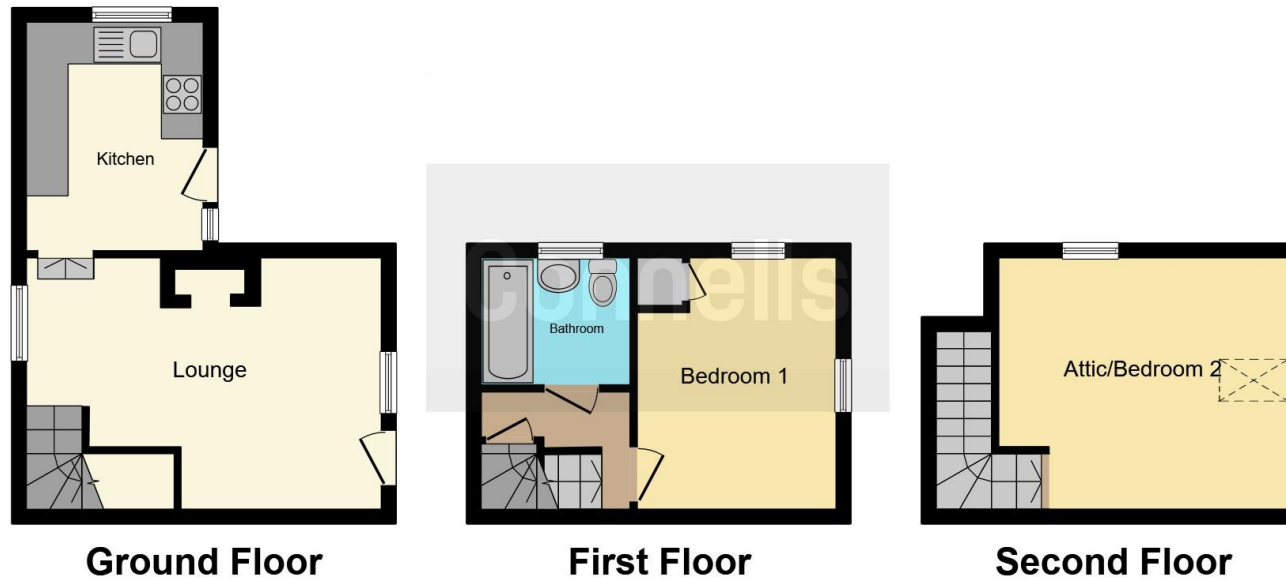

This floor plan is for illustrative purposes only. It is not drawn to scale. Any measurements, floor areas (including any total floor area), openings and orientation are approximate. No details are guaranteed, they cannot be relied upon for any purpose and they do not form part of any agreement. No liability is taken for any error, omission or misstatement. A party must rely upon its own inspection(s). Powered by [www.focalagent.com](http://www.focalagent.com)

To view this property please contact Connells on

**T 01258 452 327**  
**E [blandfordforum@connells.co.uk](mailto:blandfordforum@connells.co.uk)**

20 Salisbury Street  
 BLANDFORD FORUM DT11 7AR

**EPC Rating: F**

Tenure: Freehold

**view this property online** [connells.co.uk/Property/BLF306248](http://connells.co.uk/Property/BLF306248)



1. MONEY LAUNDERING REGULATIONS Intending purchasers will be asked to produce identification documentation at a later stage and we would ask for your co-operation in order that there will be no delay in agreeing the sale. 2. These particulars do not constitute part or all of an offer or contract. 3. The measurements indicated are supplied for guidance only and as such must be considered incorrect. Potential buyers are advised to recheck measurements before committing to any expense. 4. We have not tested any apparatus, equipment, fixtures, fittings or services and it is in the buyers interest to check the working condition of any appliances.

Connells Residential is registered in England and Wales under company number 1489613, Registered Office is Cumbria House, 16-20 Hockliffe Street, Leighton Buzzard, Bedfordshire, LU7 1GN. VAT Registration Number is 500 2481 05.

**See all our properties at [www.connells.co.uk](http://www.connells.co.uk) | [www.rightmove.co.uk](http://www.rightmove.co.uk) | [www.zoopla.co.uk](http://www.zoopla.co.uk)**

Property Ref: BLF306248 - 0006