



Connells

Loddington Way
Mawsley Kettering



Property Description

Situated outside of Kettering in the small village of Mawsley is this beautiful three bedroom town house. This property offers good size bedrooms with a master ensuite, generous living space, and front and rear gardens. The property is surrounded by many local amenities including a well regarded primary school, nursery and local shops. The property is on a bus route and Kettering is only a short drive away.

This stunning home offers spacious and well-appointed accommodation set across three floors, ideal for modern family living. The property benefits from central heating and UPVC double glazing and entrance hall has innovative storage options. The home also offers a stylish white fitted kitchen complete with integrated appliances. The bright and airy living/dining room features French doors that open onto a beautifully landscaped, split level enclosed rear garden - perfect for entertaining or relaxing.

Upstairs, the first floor hosts two generously sized bedrooms and a contemporary three-piece family bathroom. The second floor is dedicated to the impressive master bedroom, complete with fitted wardrobes and a luxury en-suite shower room.

Additional features include an entrance hall, downstairs WC, and high-quality finishes throughout.

An internal viewing is highly recommended to fully appreciate the space, style, and

presentation of this exceptional family home.

Lounge/Diner

14' 11" x 14' 8" (4.55m x 4.47m)

Kitchen

10' 7" x 7' 7" (3.23m x 2.31m)

W/C

Bedroom 1

12' 8" x 11' 4" (3.86m x 3.45m)

Ensuite

Bedroom 2

14' 7" x 8' 2" (4.45m x 2.49m)

Bedroom 3

10' 8" x 8' 7" (3.25m x 2.62m)

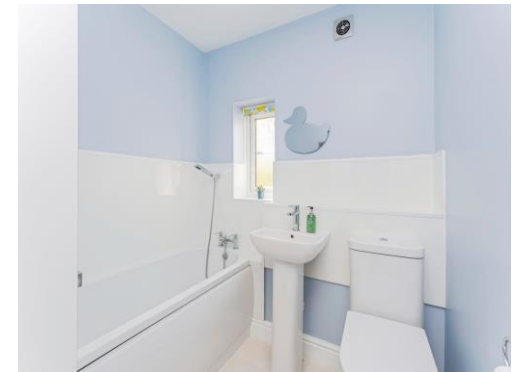





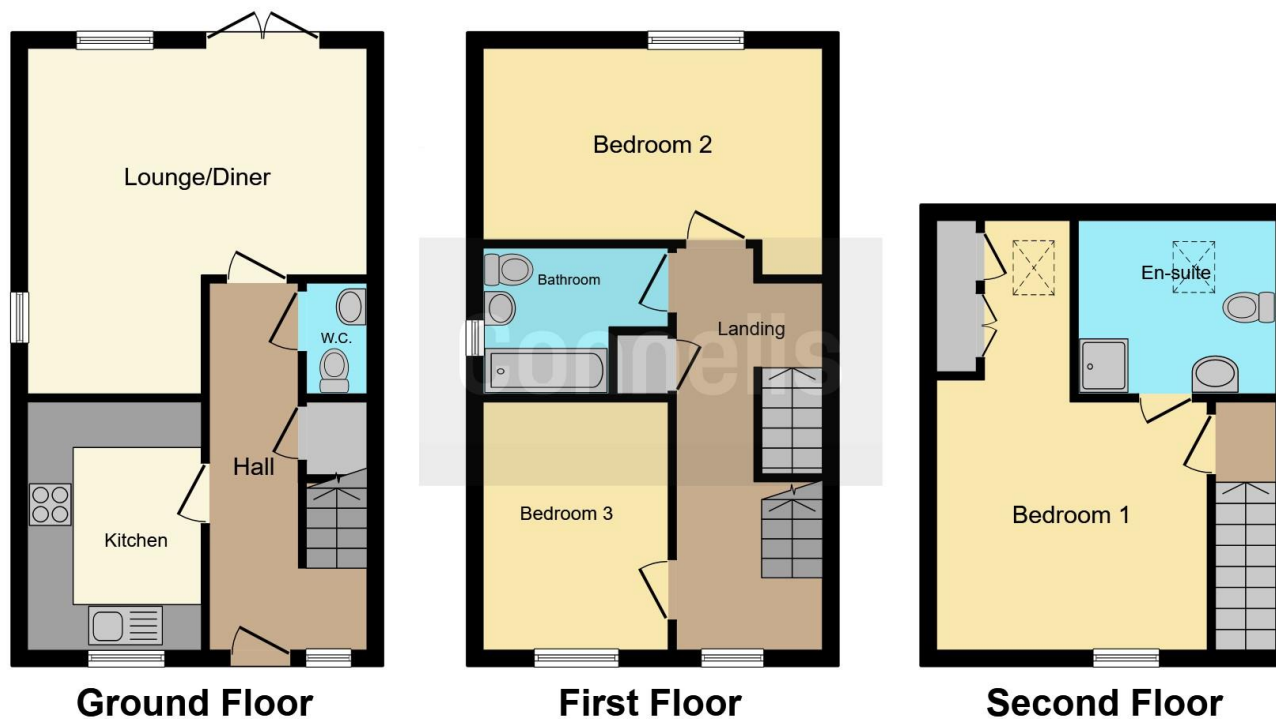

This floor plan is for illustrative purposes only. It is not drawn to scale. Any measurements, floor areas (including any total floor area), openings and orientation are approximate. No details are guaranteed, they cannot be relied upon for any purpose and they do not form part of any agreement. No liability is taken for any error, omission or misstatement. A party must rely upon its own inspection(s). Powered by www.focalagent.com

To view this property please contact Connells on

T 01536 411 811
E kettering@connells.co.uk

5 Montagu Street
 KETTERING NN16 8XG

EPC Rating: C

Tenure: Freehold

view this property online connells.co.uk/Property/KTT308350



1. MONEY LAUNDERING REGULATIONS Intending purchasers will be asked to produce identification documentation at a later stage and we would ask for your co-operation in order that there will be no delay in agreeing the sale. 2. These particulars do not constitute part or all of an offer or contract. 3. The measurements indicated are supplied for guidance only and as such must be considered incorrect. Potential buyers are advised to recheck measurements before committing to any expense. 4. We have not tested any apparatus, equipment, fixtures, fittings or services and it is in the buyers interest to check the working condition of any appliances.

Connells Residential is registered in England and Wales under company number 1489613, Registered Office is Cumbria House, 16-20 Hockliffe Street, Leighton Buzzard, Bedfordshire, LU7 1GN. VAT Registration Number is 500 2481 05.

See all our properties at www.connells.co.uk | www.rightmove.co.uk | www.zoopla.co.uk

Property Ref: KTT308350 - 0012