



Connells

Blackmore Road
Shaftesbury

Blackmore Road
Shaftesbury SP7 8RL

for sale offers in excess of
£260,000



Property Description

A three bedroom end of terrace house with a corner plot garden and parking. Finished inside to a good standard with lounge to the front and kitchen/diner to the rear with french doors onto the garden. Upstairs are the three bedrooms and bathroom.

Entrance Hall

Door into the entrance hall, double glazed window to the rear and a radiator.

Lounge

13' 11" x 11' 5" (4.24m x 3.48m)
Double glazed window to the front and a radiator.

Kitchen / Diner

14' 8" x 10' (4.47m x 3.05m)
Double glazed window to the rear, french doors onto the garden, fitted kitchen with wall and base units, space for a fridge/freezer, plumbing for a washing machine and dishwasher, electric oven and hob and the gas central heating boiler.

Landing

Access to the loft.

Bedroom One

14' 9" x 7' 10" (4.50m x 2.39m)
Double glazed window to the front and a radiator.

Bedroom Two

10' x 8' 4" (3.05m x 2.54m)
Double glazed window to the rear and a radiator.



Bedroom Three

7' 9" x 6' 9" (2.36m x 2.06m)
Double glazed window to the rear and a radiator.

Garden

Large corner plot garden laid to lawn with two patio seating areas.

Parking

Parking for 3 cars.



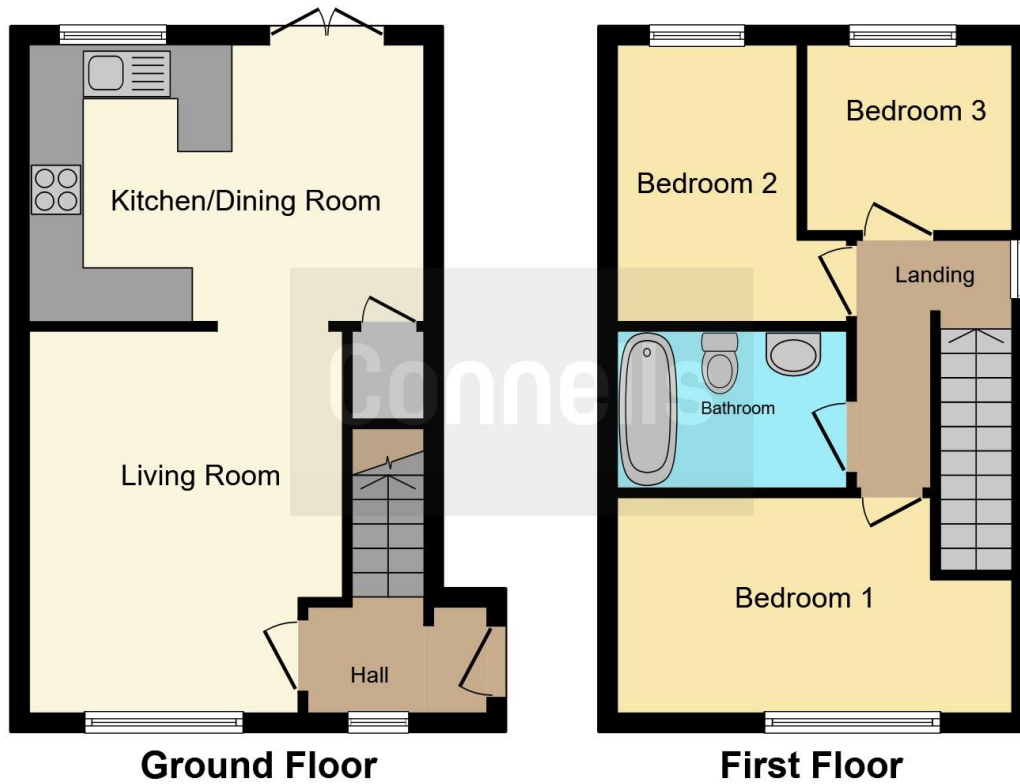

This floor plan is for illustrative purposes only. It is not drawn to scale. Any measurements, floor areas (including any total floor area), openings and orientation are approximate. No details are guaranteed, they cannot be relied upon for any purpose and they do not form part of any agreement. No liability is taken for any error, omission or misstatement. A party must rely upon its own inspection(s). Powered by www.focalagent.com

To view this property please contact Connells on

T 01747 854 001
E shaftesbury@connells.co.uk

34 High Street
 SHAFTESBURY SP7 8JG

EPC Rating: C Council Tax
 Band: B

view this property online connells.co.uk/Property/SFT306150



Tenure: Freehold



1. MONEY LAUNDERING REGULATIONS Intending purchasers will be asked to produce identification documentation at a later stage and we would ask for your co-operation in order that there will be no delay in agreeing the sale. 2. These particulars do not constitute part or all of an offer or contract. 3. The measurements indicated are supplied for guidance only and as such must be considered incorrect. Potential buyers are advised to recheck measurements before committing to any expense. 4. We have not tested any apparatus, equipment, fixtures, fittings or services and it is in the buyers interest to check the working condition of any appliances.

Connells Residential is registered in England and Wales under company number 1489613, Registered Office is Cumbria House, 16-20 Hockliffe Street, Leighton Buzzard, Bedfordshire, LU7 1GN. VAT Registration Number is 500 2481 05.

See all our properties at www.connells.co.uk | www.rightmove.co.uk | www.zoopla.co.uk

Property Ref: SFT306150 - 0003