





Property Description

Connells are pleased to offer to the market this three bedroom mid terrace house in the town of Shaftesbury with NO ONWARD CHAIN. With lounge/diner, kitchen and cloakroom on the ground floor. Upstairs are the three bedrooms and family bathroom, outside is the garden, off street parking and a garage.

Entrance Hall

Under stairs cupboard and an electric radiator.

Cloakroom

Single glazed window to the side.

Lounge

16' max x 14' 7" max (4.88m max x 4.45m max)
Patio doors the rear and a radiator.

Kitchen

10' 2" x 9' 8" (3.10m x 2.95m)
Double glazed window to the front, fitted kitchen with stainless steel sink and drainer, electric oven and hob, extractor fan, space for a washing machine and slimline dishwasher and a fitted fridge/freezer.

Landing

Stairs from the entrance hall, airing cupboard and access to the loft.

Bedroom One

13' 5" max x 9' 5" max (4.09m max x 2.87m max)
Double glazed window to the rear and a radiator.

Bedroom Two

9' 5" max x 9' 5" (2.87m max x 2.87m)
Double glazed window to the front and a radiator.

Bedroom Three

8' 8" x 8' 2" (2.64m x 2.49m)
Double glazed window to the rear and a radiator.

Bathroom

Bath with an electric shower over, WC, wash hand basin and a Dimplex wall heater.

Rear Garden

To the rear the garden is laid to lawn with a patio.

Garage

Up and over door.



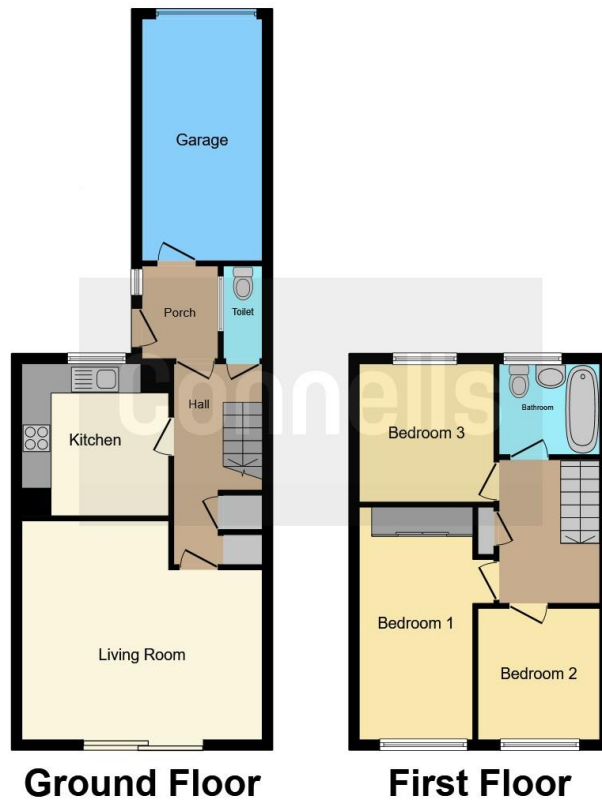

This floor plan is for illustrative purposes only. It is not drawn to scale. Any measurements, floor areas (including any total floor area), openings and orientation are approximate. No details are guaranteed, they cannot be relied upon for any purpose and they do not form part of any agreement. No liability is taken for any error, omission or misstatement. A party must rely upon its own inspection(s). Powered by www.focalagent.com

To view this property please contact Connells on

T 01747 854 001
E shaftesbury@connells.co.uk

34 High Street
 SHAFTESBURY SP7 8JG

EPC Rating: E

view this property online connells.co.uk/Property/SFT305870



Tenure: Freehold



1. MONEY LAUNDERING REGULATIONS Intending purchasers will be asked to produce identification documentation at a later stage and we would ask for your co-operation in order that there will be no delay in agreeing the sale. 2. These particulars do not constitute part or all of an offer or contract. 3. The measurements indicated are supplied for guidance only and as such must be considered incorrect. Potential buyers are advised to recheck measurements before committing to any expense. 4. We have not tested any apparatus, equipment, fixtures, fittings or services and it is in the buyers interest to check the working condition of any appliances.

Connells Residential is registered in England and Wales under company number 1489613, Registered Office is Cumbria House, 16-20 Hockliffe Street, Leighton Buzzard, Bedfordshire, LU7 1GN. VAT Registration Number is 500 2481 05.

See all our properties at www.connells.co.uk | www.rightmove.co.uk | www.zoopla.co.uk

Property Ref: SFT305870 - 0009