



Connells

Anstee Road
Shaftesbury



Property Description

Offered to the market is this one bedroom coach house with 4 years remaining on the NHBC. This home would make an ideal first time buy or investment with stairs leading up to the coach house, open plan kitchen and living space, bedroom, bathroom and a garage this is a property not to be missed.

Entrance Hall

Double glazed door and window to the front, stairs up to the coach house, telephone point and a radiator.

Kitchen / Open Plan Living

19' 7" max x 14' 5" max (5.97m max x 4.39m max)

Double glazed windows to the front and rear, wooden flooring, television aerial socket, radiator, fitted kitchen with wall and base units, worksurfaces, tiling, stainless steel sink and drainer, plumbing for a washing machine and dishwasher, electric oven, gas hob, cooker hood and the gas central heating boiler.

Bedroom

19' 7" max x 9' 4" max (5.97m max x 2.84m max)

Double glazed windows to the front and rear, access to the loft, telephone point and a radiator.



Bathroom

Double glazed window to the rear, bath with a shower over, WC, wash hand basin, tiling, radiator and an extractor fan.

Garage

20' 4" max x 8' 9" max (6.20m max x 2.67m max)
Up and over door, power, lighting and an under stairs cupboard.

Parking

On street parking.



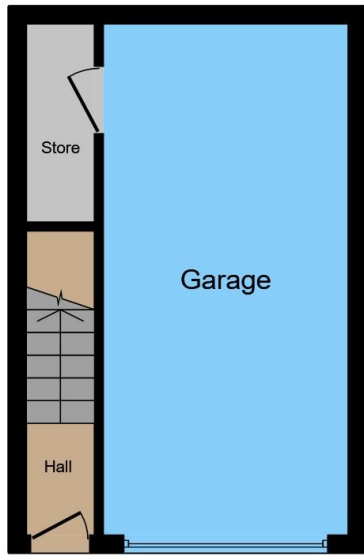

Ground Floor

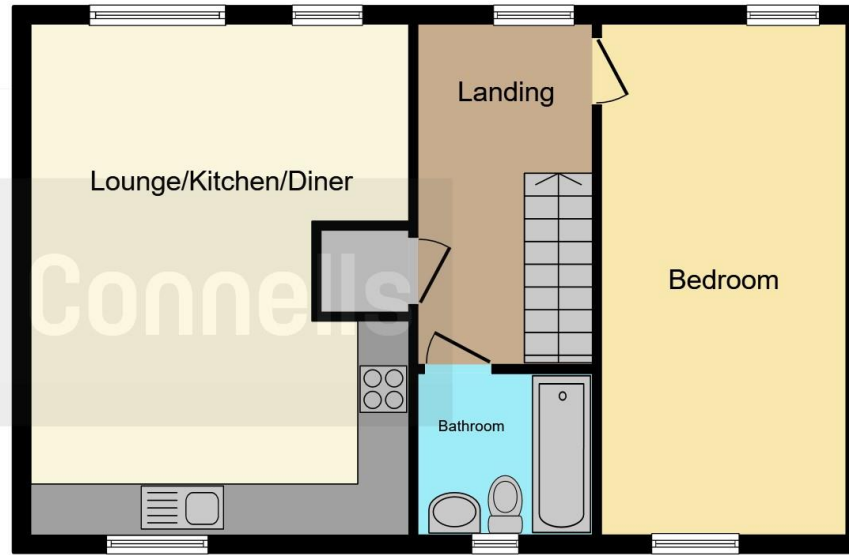

First Floor



This floorplan is for illustrative purposes only and is not drawn to scale. Measurements, floor-areas, openings and orientations are approximate. They should not be relied upon for any purpose and do not form any part of an agreement. No liability is taken for any error or mis-statement. All parties must rely on their own inspections.

To view this property please contact Connells on

T 01747 854 001
E shaftesbury@connells.co.uk

34 High Street
 SHAFTESBURY SP7 8JG

EPC Rating: C

view this property online connells.co.uk/Property/SFT305375

Tenure: Freehold



1. MONEY LAUNDERING REGULATIONS Intending purchasers will be asked to produce identification documentation at a later stage and we would ask for your co-operation in order that there will be no delay in agreeing the sale. 2. These particulars do not constitute part or all of an offer or contract. 3. The measurements indicated are supplied for guidance only and as such must be considered incorrect. Potential buyers are advised to recheck measurements before committing to any expense. 4. We have not tested any apparatus, equipment, fixtures, fittings or services and it is in the buyers interest to check the working condition of any appliances.

Connells Residential is registered in England and Wales under company number 1489613, Registered Office is Cumbria House, 16-20 Hockliffe Street, Leighton Buzzard, Bedfordshire, LU7 1GN. VAT Registration Number is 500 2481 05.

See all our properties at www.connells.co.uk | www.rightmove.co.uk | www.zoopla.co.uk

Property Ref: SFT305375 - 0005