



**Connells**

Penfold Close  
Northampton



### Property Description

Situated in a popular area of Kingsthorpe is this one bedroom end of terrace house. Accommodation comprises of lounge/diner, fitted kitchen and downstairs W/C. Upstairs you will find one double bedroom with an en-suite bathroom. The property benefits from being close to local amenities with schools, pubs and shops close by. Viewing is highly recommended.

### Entrance

### Lounge

15' 6" x 8' 2" ( 4.72m x 2.49m )  
Double glazed door to front aspect, TV point, wall mounted radiator.

### W/ C

Low level W/C, wash hand basin, wall mounted radiator.

### Kitchen

9' 1" x 7' 2" ( 2.77m x 2.18m )  
Double glazed window to front aspect, central heating boiler, fitted kitchen wall and base units, space for cooker, washing machine and dishwasher, stainless steel sink/drainer.

### Landing

### Bedroom One

15' 5" x 9' 1" ( 4.70m x 2.77m )  
Double glazed window to front aspect, TV point, loft access, two wall mounted radiators.

### En-Suite

Double glazed window to front aspect, low level W/C, bath with shower over, wall mounted radiator.

### Outside

### Front

Allocated parking space.



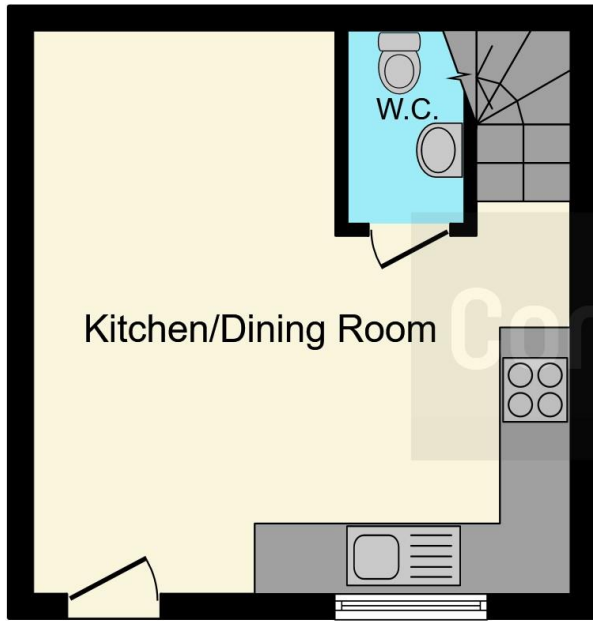

**Ground Floor**

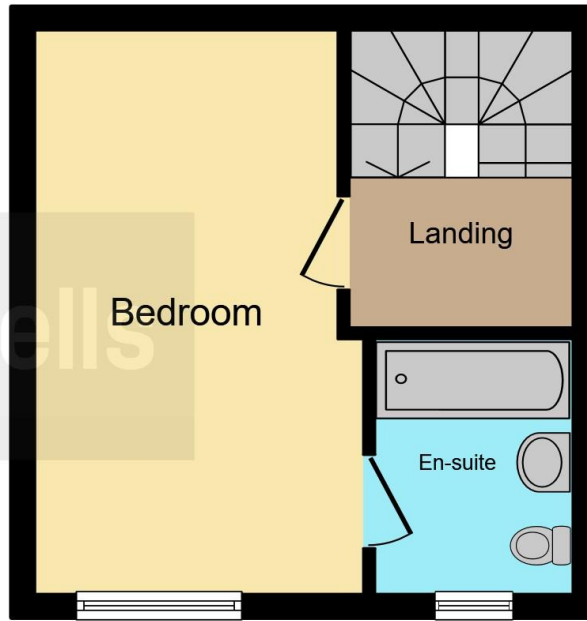

**First Floor**



This floorplan is for illustrative purposes only and is not drawn to scale. Measurements, floor-areas, openings and orientations are approximate. They should not be relied upon for any purpose and do not form any part of an agreement. No liability is taken for any error or mis-statement. All parties must rely on their own inspections.

To view this property please contact Connells on

**T 01604 716 655**  
**E [kingsthorpe@connells.co.uk](mailto:kingsthorpe@connells.co.uk)**

87 Harborough Road Kingsthorpe  
NORTHAMPTON NN2 7SL

**EPC Rating: B**

**view this property online [connells.co.uk/Property/KTP406608](http://connells.co.uk/Property/KTP406608)**

Tenure: Freehold



1. MONEY LAUNDERING REGULATIONS Intending purchasers will be asked to produce identification documentation at a later stage and we would ask for your co-operation in order that there will be no delay in agreeing the sale. 2. These particulars do not constitute part or all of an offer or contract. 3. The measurements indicated are supplied for guidance only and as such must be considered incorrect. Potential buyers are advised to recheck measurements before committing to any expense. 4. We have not tested any apparatus, equipment, fixtures, fittings or services and it is in the buyers interest to check the working condition of any appliances.

Connells Residential is registered in England and Wales under company number 1489613, Registered Office is Cumbria House, 16-20 Hockliffe Street, Leighton Buzzard, Bedfordshire, LU7 1GN. VAT Registration Number is 500 2481 05.

**See all our properties at [www.connells.co.uk](http://www.connells.co.uk) | [www.rightmove.co.uk](http://www.rightmove.co.uk) | [www.zoopla.co.uk](http://www.zoopla.co.uk)**

Property Ref: KTP406608 - 0003