



Connells

Wheatfield Road
Northampton



Property Description

The accommodation comprises an inviting entrance hall, a spacious kitchen/dining room with ample room for entertaining, and a comfortable lounge. The first floor boasts two generously sized double bedrooms and a refitted bathroom suite, ensuring modern comfort and style. Outside, you'll find a delightful, good-sized private rear garden, mainly laid to lawn with a patio area, perfect for relaxing or entertaining. Further benefits include uPVC double glazing and gas radiator heating, ensuring a warm and energy-efficient living space.

Entrance Hall

Double glazed door to the front aspect. Understairs storage.

Lounge

16' 1" x 11' 11" (4.90m x 3.63m)

Double glazed window to the front aspect. Wall mounted radiator.

Kitchen

9' 1" x 19' 9" (2.77m x 6.02m)

Wall and base units. Worksurfaces. Sink and drainer unit. Space for white goods. Two double glazed windows to the rear aspect. Double glazed door to the rear aspect. Wall mounted radiator.

Landing

Double glazed window to the front aspect. Access to loft space.

Bedroom One

11' 11" x 13' 5" (3.63m x 4.09m)

Double glazed window to the front aspect. Wall mounted radiator.

Bedroom Two

12' x 9' 1" (3.66m x 2.77m)

Double glazed window to the rear aspect. Wall mounted radiator.

Bathroom

Bath with shower over, wash hand basin and low level WC. Double glazed window to the rear aspect. Combi boiler.

Outside

Front Garden

Gravelled front. Path. Enclosed by fencing.

Rear Garden

Laid to lawn. Patio. Shed.

Parking

On street Parking







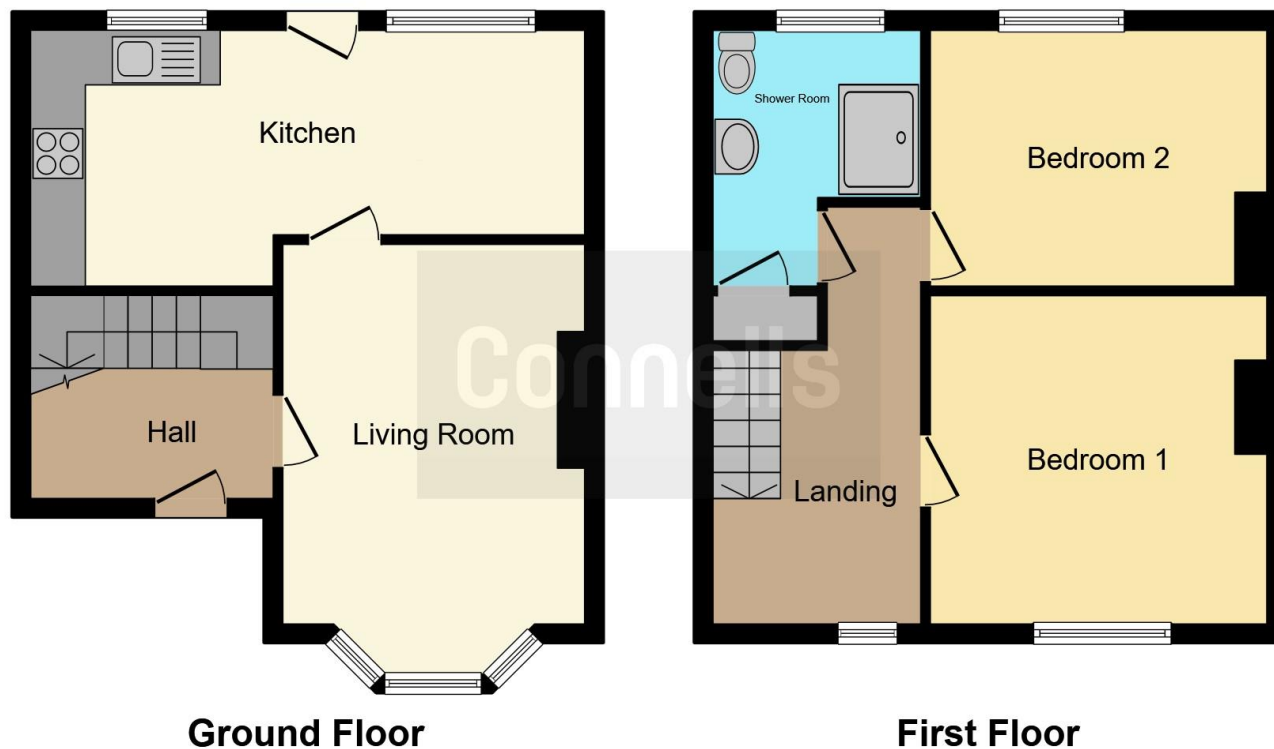

This floor plan is for illustrative purposes only. It is not drawn to scale. Any measurements, floor areas (including any total floor area), openings and orientation are approximate. No details are guaranteed, they cannot be relied upon for any purpose and they do not form part of any agreement. No liability is taken for any error, omission or misstatement. A party must rely upon its own inspection(s). Powered by www.focalagent.com

To view this property please contact Connells on

T 01604 638 281
E northampton@connells.co.uk

6 Wood Hill
 NORTHAMPTON NN1 2DA

EPC Rating: C Council Tax
 Band: A

Tenure: Freehold

view this property online connells.co.uk/Property/NHT414247



1. MONEY LAUNDERING REGULATIONS Intending purchasers will be asked to produce identification documentation at a later stage and we would ask for your co-operation in order that there will be no delay in agreeing the sale. 2. These particulars do not constitute part or all of an offer or contract. 3. The measurements indicated are supplied for guidance only and as such must be considered incorrect. Potential buyers are advised to recheck measurements before committing to any expense. 4. We have not tested any apparatus, equipment, fixtures, fittings or services and it is in the buyers interest to check the working condition of any appliances.

Connells Residential is registered in England and Wales under company number 1489613, Registered Office is Cumbria House, 16-20 Hockliffe Street, Leighton Buzzard, Bedfordshire, LU7 1GN. VAT Registration Number is 500 2481 05.

See all our properties at www.connells.co.uk | www.rightmove.co.uk | www.zoopla.co.uk

Property Ref: NHT414247 - 0004