



Connells

High Street
Husbands Bosworth Lutterworth

High Street Husbands Bosworth Lutterworth LE17 6LH

for sale offers over
£230,000



Property Description

This charming mid-terrace cottage nestled in the heart of this picturesque Leicestershire village. The property offers a blend of traditional features and modern comforts, making it an ideal home for those seeking village life with convenient access to nearby towns.

Situated in the heart of Husbands Bosworth, a well-regarded and friendly Leicestershire village known for its character and community spirit. Positioned on the historic High Street, surrounded by other period homes and just a short stroll from local amenities such as a village shop and post office, Primary School, Public House, Village Hall and recreational spaces. Offering scenic countryside surroundings, ideal for walking, cycling and enjoying rural life.

Despite the rural setting, its well connected to Lutterworth which is just a 10-minute drive away from supermarkets and further amenities. Market Harborough and Rugby are nearby for more extensive shopping, dining and leisure.

Excellent transport links, including access to the A14, M1 and M6, make commuting straightforward. Train stations in Market Harborough and Rugby provide fast services to Leicester, Birmingham and London.

This location perfectly suits those looking for a quiet village lifestyle without sacrificing access to towns, cities or major transport networks.

Lounge

11' 5" x 11' 5" (3.48m x 3.48m)

The front door leads into a well presented living room with a double glazed window to the front elevation, stylish wooden flooring and door leading through to the kitchen/diner.

Kitchen/Dining Room

A well presented kitchen with space for a dining area, fitted with a range of wall and base units with wooden worksurfaces above. The kitchen is fitted with a Belfast sink, electric oven and gas hob with cooker hood above, plumbing for washing machine, space for fridge/freezer and splash back tiling and tiled floor. Feature fire place, double glazed window to the rear elevation, stairs rising to the first floor accommodation, door to the rear garden and door to the downstairs bathroom.

Shower Room

Fitted with suite comprising of: low level W.C, wash hand basin, shower cubicle, partially tiled and a double glazed window to the side elevation.

Bedroom One

A good sized double bedroom with a double glazed window to the front elevation, radiator and built in cupboard offering additional storage space.

Bedroom Two

A good sized second bedroom with a double glazed window to the rear elevation, radiator and loft access.

Outside

The cottage features a private rear garden with wooden fencing to allow privacy.







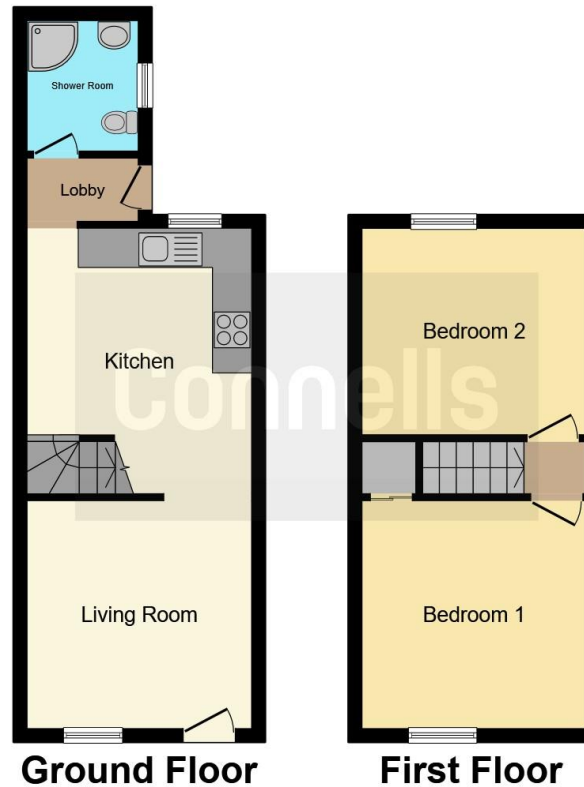

This floor plan is for illustrative purposes only. It is not drawn to scale. Any measurements, floor areas (including any total floor area), openings and orientation are approximate. No details are guaranteed, they cannot be relied upon for any purpose and they do not form part of any agreement. No liability is taken for any error, omission or misstatement. A party must rely upon its own inspection(s). Powered by www.focalagent.com

To view this property please contact Connells on

T 01858 465 921
E marketharborough@connells.co.uk

11 St. Marys Road
 MARKET HARBOROUGH LE16 7DS

EPC Rating: E Council Tax
 Band: B

Tenure: Freehold

view this property online connells.co.uk/Property/MKH302463



1. MONEY LAUNDERING REGULATIONS Intending purchasers will be asked to produce identification documentation at a later stage and we would ask for your co-operation in order that there will be no delay in agreeing the sale. 2. These particulars do not constitute part or all of an offer or contract. 3. The measurements indicated are supplied for guidance only and as such must be considered incorrect. Potential buyers are advised to recheck measurements before committing to any expense. 4. We have not tested any apparatus, equipment, fixtures, fittings or services and it is in the buyers interest to check the working condition of any appliances.

Connells Residential is registered in England and Wales under company number 1489613, Registered Office is Cumbria House, 16-20 Hockliffe Street, Leighton Buzzard, Bedfordshire, LU7 1GN. VAT Registration Number is 500 2481 05.

See all our properties at www.connells.co.uk | www.rightmove.co.uk | www.zoopla.co.uk

Property Ref: MKH302463 - 0003