



Connells

Oak Tree Road
Great Glen Leicester



Property Description

Modern spacious two bedroom town house on this sought after new build development in the enviable village of Great Glen. Offered to the market with the remainder of the NHBC guarantee making it an ideal first time or professional purchase.

Entrance Hall

As you step inside, you are greeted by a welcoming entrance hall that leads to the cloakroom, kitchen and lounge with staircase ascending to first floor accommodation.

Cloakroom

The ground floor is completed by a convenient downstairs cloakroom comprising low level wc and pedestal wash hand basin with a privacy window to the front elevation.

Lounge/Diner

15' 6" x 13' 3" (4.72m x 4.04m)

Situated at the rear of the house is a light and airy lounge/diner, a useful downstairs storage cupboard and french doors leading into the rear garden.

Kitchen/Breakfast Room

11' 5" x 6' 2" (3.48m x 1.88m)

The stylish fitted kitchen/breakfast room has integrated appliances including stainless steel single oven, extractor hood, gas hob, fridge/freezer, and dishwasher. Stainless steel sink and drainer with window to front elevation.

First Floor Landing

Ascend the stairs to the first floor where you're greeted by a landing that leads to two generously sized double bedrooms and the family bathroom.

Bedroom One

13' 3" x 9' 9" (4.04m x 2.97m)

Master double bedroom to front elevation of the home comprising a storage cupboard, carpet flooring and gas radiator central heating.

Bedroom Two

13' 3" x 9' 9" (4.04m x 2.97m)

Double bedroom to the rear elevation of the home with carpet flooring and gas radiator central heating.

Bathroom

Family bathroom comprising low level wc, wash hand basin and bath tub with electric shower over. Partially tiled splashback and fully tiled flooring.







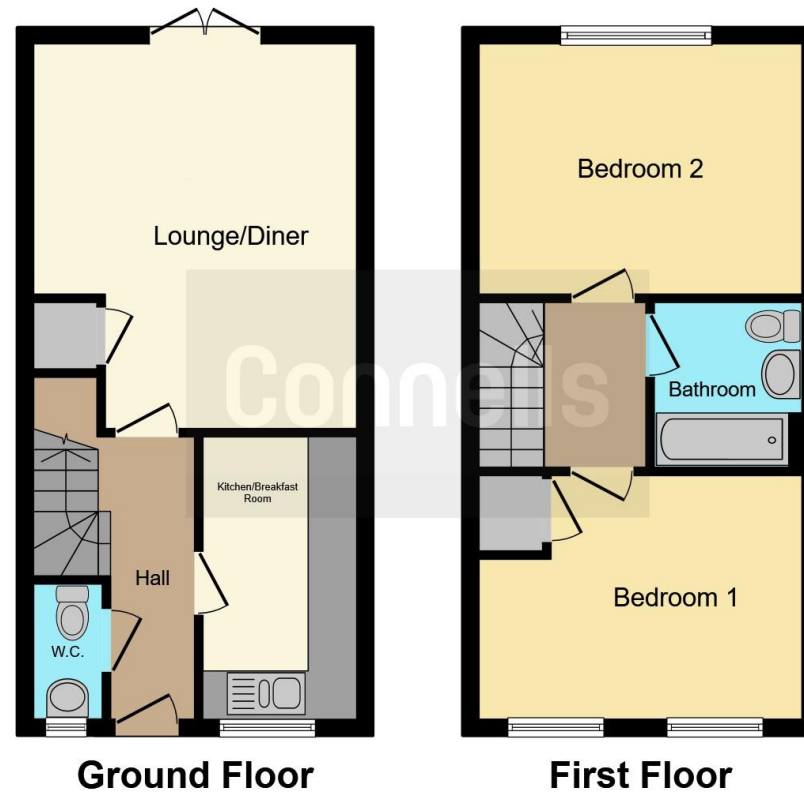

This floor plan is for illustrative purposes only. It is not drawn to scale. Any measurements, floor areas (including any total floor area), openings and orientation are approximate. No details are guaranteed, they cannot be relied upon for any purpose and they do not form part of any agreement. No liability is taken for any error, omission or misstatement. A party must rely upon its own inspection(s). Powered by www.focalagent.com

To view this property please contact Connells on

T 01858 465 921
E marketharborough@connells.co.uk

11 St. Marys Road
 MARKET HARBOROUGH LE16 7DS

EPC Rating: B

view this property online connells.co.uk/Property/OBY311462

Tenure: Freehold



1. MONEY LAUNDERING REGULATIONS Intending purchasers will be asked to produce identification documentation at a later stage and we would ask for your co-operation in order that there will be no delay in agreeing the sale. 2. These particulars do not constitute part or all of an offer or contract. 3. The measurements indicated are supplied for guidance only and as such must be considered incorrect. Potential buyers are advised to recheck measurements before committing to any expense. 4. We have not tested any apparatus, equipment, fixtures, fittings or services and it is in the buyers interest to check the working condition of any appliances.

Connells Residential is registered in England and Wales under company number 1489613, Registered Office is Cumbria House, 16-20 Hockliffe Street, Leighton Buzzard, Bedfordshire, LU7 1GN. VAT Registration Number is 500 2481 05.

See all our properties at www.connells.co.uk | www.rightmove.co.uk | www.zoopla.co.uk

Property Ref: OBY311462 - 0004