



Not for marketing purposes INTERNAL USE ONLY

Beauville Drive
Leicester



Property Description

Located in the diverse and vibrant area of Northfields in Leicester. This locale is particularly notable for its multicultural character, with a variety of shops, eateries, and markets reflecting the diverse backgrounds of its residents. The nearby Golden Mile, a famous stretch of road, is renowned for its array of Indian shops, restaurants, and jewellers, making it a hub for cultural experiences and vibrant festivals.

Residents benefit from a wealth of local amenities, including several places of worship, community centres, and educational institutions, making it a family-friendly area. The presence of Abbey Park and the River Soar nearby provides green spaces for leisure and outdoor activities, offering a pleasant escape from the urban environment.

Transport links are highly convenient, with good access to public transportation options such as buses that connect to Leicester city centre and surrounding areas. The location also enjoys proximity to major road networks like the A6 and A47, facilitating easy commutes and travel.

First Floor

Bedroom 1

13' 2" x 12' 4" (4.01m x 3.76m)
With window to the front

Bedroom 2

10' 9" x 11' 2" (3.28m x 3.40m)
With window to the rear

Bedroom 3

8' 3" x 9' (2.51m x 2.74m)
With window to the front

Bathroom

8' x 5' 5" (2.44m x 1.65m)
Having a bath, wash hand basin & toilet

Garage

12.1 sq. m.

Ground Floor

Lounge

14' 9" x 11' 9" (4.50m x 3.58m)
Spacious room with window to the front

Kitchen/Diner

19' 5" x 11' 6" (5.92m x 3.51m)
Open plan kitchen/diner with window and access to the rear garden







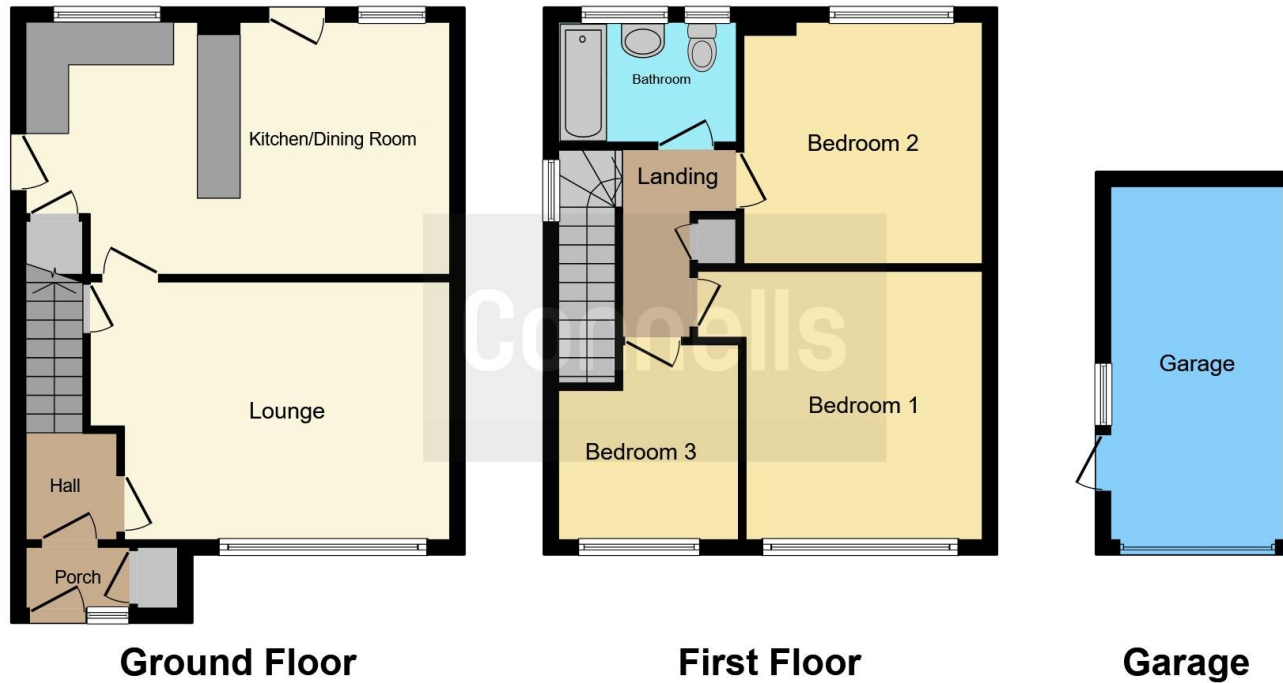

This floor plan is for illustrative purposes only. It is not drawn to scale. Any measurements, floor areas (including any total floor area), openings and orientation are approximate. No details are guaranteed, they cannot be relied upon for any purpose and they do not form part of any agreement. No liability is taken for any error, omission or misstatement. A party must rely upon its own inspection(s). Powered by www.focalagent.com

To view this property please contact Connells on

T 0116 262 0022
E leicester@connells.co.uk

22-24 Halford Street
 LEICESTER LE1 1JB

EPC Rating: E

Tenure: Freehold

[check out more properties at connells.co.uk](http://connells.co.uk)



1. MONEY LAUNDERING REGULATIONS Intending purchasers will be asked to produce identification documentation at a later stage and we would ask for your co-operation in order that there will be no delay in agreeing the sale. 2. These particulars do not constitute part or all of an offer or contract. 3. The measurements indicated are supplied for guidance only and as such must be considered incorrect. Potential buyers are advised to recheck measurements before committing to any expense. 4. We have not tested any apparatus, equipment, fixtures, fittings or services and it is in the buyers interest to check the working condition of any appliances.

Connells Residential is registered in England and Wales under company number 1489613, Registered Office is Cumbria House, 16-20 Hockliffe Street, Leighton Buzzard, Bedfordshire, LU7 1GN. VAT Registration Number is 500 2481 05.

See all our properties at www.connells.co.uk | www.rightmove.co.uk | www.zoopla.co.uk

Property Ref: LTR323295 - 0003