





Property Description

Connells are excited to bring to the market this beautifully designed new build home, situated in a highly sought-after residential location in the popular coastal town of Paignton.

Perfectly positioned close to well-regarded local schools-including grammar schools-excellent transport links, and everyday amenities, this stunning property has been thoughtfully created with family living in mind. With the added peace of mind provided by a 10-year Build warranty and the inclusion of energy-efficient solar panels, this is a home that combines comfort, style, and sustainability.

The developer of this home has executed a clear and modern vision for what a family home should be-functional, stylish, and welcoming. Every detail has been carefully considered, from the high-quality finishes to the practical layout, making it a move-in-ready opportunity for any buyer.

Cloakroom

Low level WC and vanity wash basin unit.

Lounge/Diner/Kitchen

23' 4" x 19' 8" (7.11m x 5.99m)

Upon entering the home, you're greeted by a bright and airy open-plan living space that is both functional and beautifully finished. This triple-aspect area has been cleverly designed to maximise natural light, creating a warm and inviting atmosphere for the entire family to enjoy.

The lounge area offers generous proportions, easily accommodating multiple pieces of furniture while maintaining a sense of flow and openness. It's the ideal setting for both relaxed evenings and lively family gatherings.

An elegant archway leads into the kitchen and dining area, which continues the home's sleek and contemporary design. The kitchen is finished to a high standard, featuring high-gloss white cabinetry, modern integrated appliances, ample worktop space, and stylish flooring. It not only looks the part but offers everything needed for family cooking and entertaining.

From the dining area, views extend out to the landscaped rear garden, creating a seamless link between indoor and outdoor living-ideal for summer entertaining or simply keeping an eye on children playing while you cook.

Upstairs Landing

Upstairs, the home continues to impress with three well-proportioned bedrooms, all finished in neutral tones to allow for easy personalisation. Doors off to these principle rooms.

Bedroom One

15' 2" x 9' 7" (4.62m x 2.92m)

The main bedroom is a spacious double, comfortably fitting a large bed and additional storage furniture. Large windows ensure the room remains light and airy.

Bedroom Two

15' 3" x 9' 7" (4.65m x 2.92m)

The second bedroom is also a good-sized double, making it perfect for children, guests, or even as a shared bedroom.

Bedroom Three

7' 7" x 5' 9" (2.31m x 1.75m)

Bathroom

The brand-new bathroom is sleek and stylish, featuring high-quality tiling, a full-sized bathtub with overhead shower, a modern vanity unit, and WC. The contemporary fittings and finishes give the space a hotel-like feel-fresh, clean, and elegant. With everything brand-new, there's nothing that needs doing-just move in and enjoy.

Outside

Step outside and you'll find a landscaped rear garden that's perfectly suited to modern living. This thoughtfully designed outdoor space offers both lawned and patio areas, ideal for summer barbecues, children's play, or simply unwinding at the end of the day.

The garden wraps around the side of the house, creating a sense of spaciousness and privacy. With fencing for security and a low-maintenance finish, it's ideal for families seeking an outdoor area that can be enjoyed without constant upkeep.







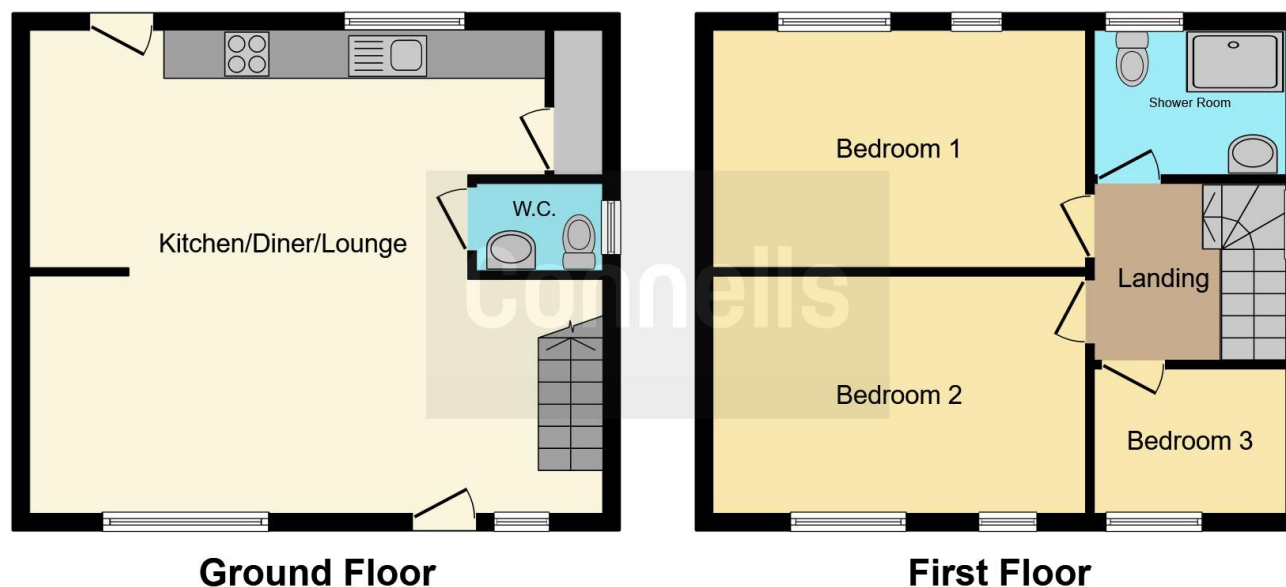

This floor plan is for illustrative purposes only. It is not drawn to scale. Any measurements, floor areas (including any total floor area), openings and orientation are approximate. No details are guaranteed, they cannot be relied upon for any purpose and they do not form part of any agreement. No liability is taken for any error, omission or misstatement. A party must rely upon its own inspection(s). Powered by www.focalagent.com

To view this property please contact Connells on

T 01803 400 888
E paignton@connells.co.uk

51 Hyde Road
 PAIGNTON TQ4 5BP

EPC Rating: C

Tenure: Freehold

view this property online connells.co.uk/Property/PGN312049



1. MONEY LAUNDERING REGULATIONS Intending purchasers will be asked to produce identification documentation at a later stage and we would ask for your co-operation in order that there will be no delay in agreeing the sale. 2. These particulars do not constitute part or all of an offer or contract. 3. The measurements indicated are supplied for guidance only and as such must be considered incorrect. Potential buyers are advised to recheck measurements before committing to any expense. 4. We have not tested any apparatus, equipment, fixtures, fittings or services and it is in the buyers interest to check the working condition of any appliances.

Connells Residential is registered in England and Wales under company number 1489613, Registered Office is Cumbria House, 16-20 Hockliffe Street, Leighton Buzzard, Bedfordshire, LU7 1GN. VAT Registration Number is 500 2481 05.

See all our properties at www.connells.co.uk | www.rightmove.co.uk | www.zoopla.co.uk

Property Ref: PGN312049 - 0003