



Connells

Lakeview Finlake Resort & Spa
Chudleigh Newton Abbot



Property Description

Nestled within the serene Finlake Resort & Spa, this lodge offers an idyllic retreat in the heart of Devon's magnificent countryside. This luxurious lodge boasts a spacious living area that seamlessly blends comfort with modern elegance.

The lounge and sitting area provide the perfect setting for relaxation, while the contemporary kitchen comes equipped with integrated appliances, ready for culinary adventures. The Central Heating is controlled by Hive.

The property features two well-appointed bedrooms with Jack & Jill bathroom and shower room.

Step outside to the expansive decking and bask in the tranquil views of the fishing lake. For an added touch of luxury, indulge in the private hot tub, offering a peaceful escape under the stars.

With an allocated parking space right outside the property, this lodge promises a hassle-free stay. As part of the Finlake Resort, owners and residents can enjoy a range of leisure facilities, including fitness classes, a swimming pool, and spa treatments at Sirona Spa.

Front Of The Property

One allocated parking space which is located next to the lodge.

Hallway

Glazed door leading into the hallway with storage cupboard and further cupboard housing the boiler.

Lounge

11' 8" max x 17' 7" max (3.56m max x 5.36m max)

Two double glazed windows to the side and two double glazed patio doors leading onto the decking, two 2-seater sofa with one being a sofa bed, electric fire with wall mounted TV above, coffee table, ceiling fan, wood flooring and a wall mounted radiator.

Kitchen / Diner

17' 7" max x 6' 5" max (5.36m max x 1.96m max)

Double glazed window to the side, wall and base units, inset sink with mixer taps, instant boiler tap, Bosch induction hob with extractor over, eye level combo oven, grill and microwave, integrated fridge freezer, washing machine, four seater dining table.

Bedroom One

10' max x 9' 5" max (3.05m max x 2.87m max)

Double glazed window to the side, fitted wardrobes, double bed, over-bed storage, bedside tables, dressing table, wall mounted tv and a wall mounted radiator. Door to Bathroom.

Bathroom

Obscure double glazed window, bath with mixer taps, WC, large wash hand basin, large triple mirror, full size storage cupboard, part tiled and a wall mounted radiator.

Bedroom Two

9' 5" max x 9' 5" max (2.87m max x 2.87m max)

Double glazed window, bunk beds, fitted wardrobes, dressing area and a wall mounted radiator. Door to Shower Room.

Shower Room

Obscure double glazed window, shower cubicle, WC, wash hand basin and part tiled.

Outside

The decking surrounds the lodge and is a perfect area for relaxing, there is outdoor seating, table and chairs and hot tub with pergola over. Additionally, there is a steel all weather bike lock up.

About Finlake Resort

Finlake is a "Multi Award Winning" resort set within 130 acres of woodland in rolling Devon countryside. The on-site facilities are excellent including a recent £6 million Swimming & Gym facility. There is also an outdoor pool together with a Sauna & Spa.

There are 3 restaurants/cafes on site plus a superbly laid out and well-stocked shop. There are tennis courts, a children's play area plus numerous other facilities including walking trails, biking trails, and horse riding.

Agent Notes

10 years remaining on the lease (June 2034).

The central pipes are located underneath the lodge and are fitted with an alert sensor to automatically heat up in cold weather to help prevent any freezing issues.







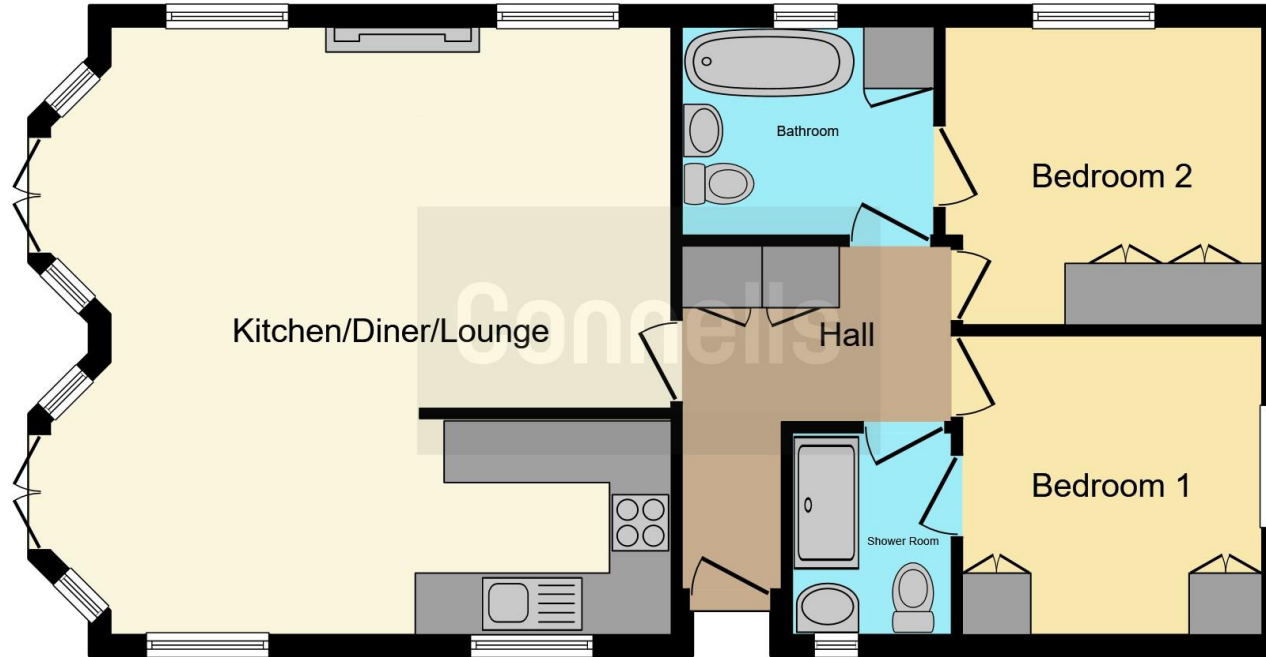

This floor plan is for illustrative purposes only. It is not drawn to scale. Any measurements, floor areas (including any total floor area), openings and orientation are approximate. No details are guaranteed, they cannot be relied upon for any purpose and they do not form part of any agreement. No liability is taken for any error, omission or misstatement. A party must rely upon its own inspection(s). Powered by www.focalagent.com

To view this property please contact Connells on

T 01626 365 064
E newtonabbot@connells.co.uk

4 Bank Street
NEWTON ABBOT TQ12 2JW

EPC Rating: Exempt

Tenure: Leasehold

view this property online connells.co.uk/Property/NAB312246

This is a Leasehold property. We are awaiting further details about the Term of the lease. For further information please contact the branch. Please note additional fees could be incurred for items such as Leasehold packs.



1. MONEY LAUNDERING REGULATIONS Intending purchasers will be asked to produce identification documentation at a later stage and we would ask for your co-operation in order that there will be no delay in agreeing the sale. 2. These particulars do not constitute part or all of an offer or contract. 3. The measurements indicated are supplied for guidance only and as such must be considered incorrect. Potential buyers are advised to recheck measurements before committing to any expense. 4. We have not tested any apparatus, equipment, fixtures, fittings or services and it is in the buyers interest to check the working condition of any appliances.

Connells Residential is registered in England and Wales under company number 1489613, Registered Office is Cumbria House, 16-20 Hockliffe Street, Leighton Buzzard, Bedfordshire, LU7 1GN. VAT Registration Number is 500 2481 05.

See all our properties at www.connells.co.uk | www.rightmove.co.uk | www.zoopla.co.uk

Property Ref: NAB312246 - 0005