



Hutchings Drive, Exeter

Connells SIGNATURE



Hutchings Drive, Exeter

Entrance Hall

Double glazed door to front.

Kitchen/Living Room

22' 2" x 11' 10" max (6.76m x 3.61m max)

Double glazed doors to rear, double glazed front aspect window, two wall mounted radiators, wall and base units, work surfaces, built-in fridge freezer, washing machine, electric oven, electric hob with extractor over, 1 1/2 bowl sink unit, cupboard housing boiler, breakfast bar.

Landing

Bedroom 1

7' 8" x 12' 2" (2.34m x 3.71m)

Double glazed rear aspect window, wall mounted radiator.

Bedroom 2

7' 6" x 12' 2" (2.29m x 3.71m)

Two double glazed front aspect windows, wall mounted radiator.

Bathroom

Bath with mains shower, low level toilet, wash hand basin, extractor fan, heated towel rail.

Rear Garden

Patio, two lawned areas, shed, gate to rear access.

Parking

1 parking space.





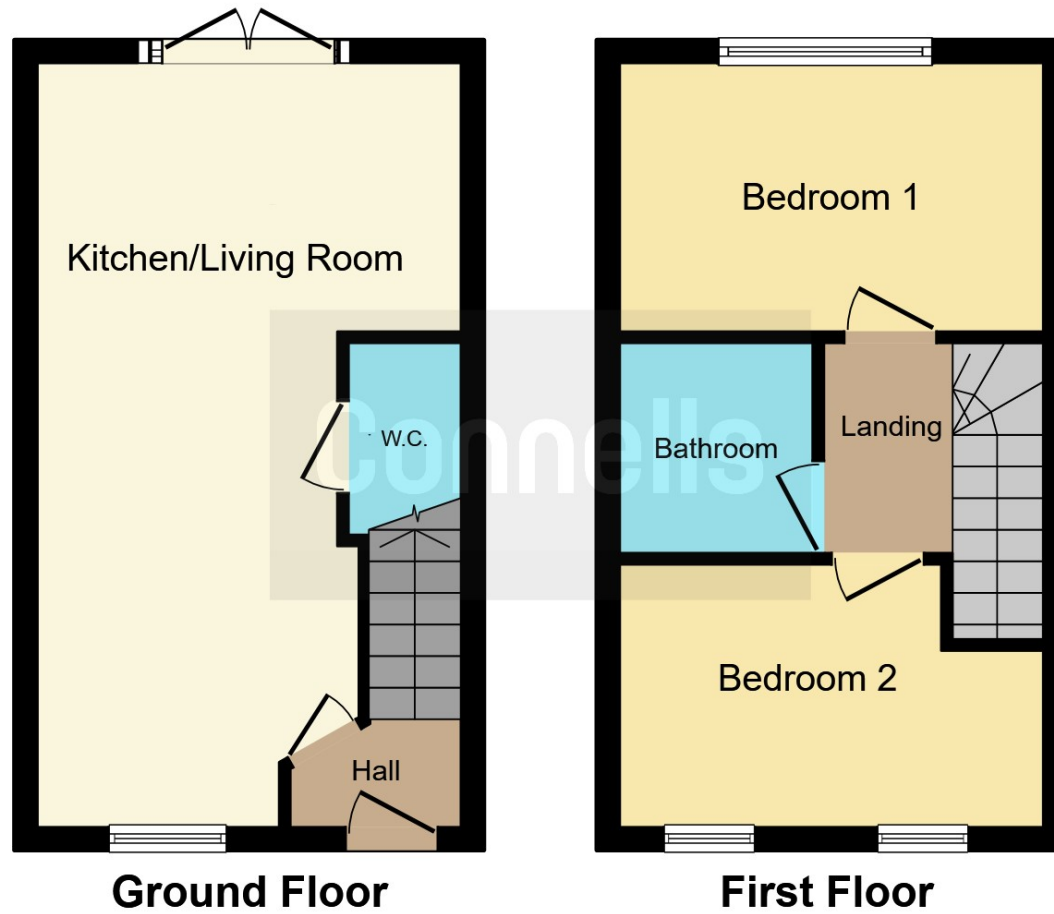

This floor plan is for illustrative purposes only. It is not drawn to scale. Any measurements, floor areas (including any total floor area), openings and orientation are approximate. No details are guaranteed, they cannot be relied upon for any purpose and they do not form part of any agreement. No liability is taken for any error, omission or misstatement. A party must rely upon its own inspection(s). Powered by www.focalagent.com

Hutchings Drive, Exeter

A perfect starter home located in TITHEBARN AREA ready to move into with 2 double bedrooms. Outside there is allocated parking and a landscaped rear garden. The property is ideal for commuters as easy access to the M5 and also the local train station. NO CHAIN.

Tenure: Freehold

EPC Rating: B

Connells SIGNATURE

To view this property please contact us on

01392 221 331

or email exeter@connells.co.uk

8-9 South Street, Exeter, Devon EX1 1DZ

CONNELLS.CO.UK



1. MONEY LAUNDERING REGULATIONS Intending purchasers will be asked to produce identification documentation at a later stage and we would ask for your co-operation in order that there is no delay in agreeing the sale. 2. These particulars do not constitute part or all of an offer or contract. 3. The measurements indicated are supplied for guidance only and as such must be considered incorrect. Potential buyers are advised to recheck measurements before committing to any expense. 4. We have not tested any apparatus, equipment, fixtures or services and it is in the buyers interest to check the working condition of any appliances. 5. Where an EPC, or a Home Report (Scotland only) is held for this property, it is available for inspection at the branch by appointment. If you require a printed version of a Home Report, you will need to pay a reasonable production charge reflecting printing and other costs. 6. We are not able to offer an opinion either written or verbal on the content of these reports and this must be obtained from your legal representative. 7. Whilst we take care in preparing these reports, a buyer should ensure that his/her legal representative confirms as soon as possible all matters relating to title including the extent and boundaries of the property and other important matters before exchange of contracts.

