



Goldfinch Lane, Cranbrook

Connells

SIGNATURE



## Goldfinch Lane, Cranbrook

### Entrance Hall

Built in storage unit, under stairs storage, wall mounted radiator.

### Downstairs WC

Low level WC, wash hand basin, extractor fan, wall mounted radiator.

### Lounge

*16'4" max x 14'1" (4.98m max x 4.29m)*

Double glazed front aspect window, double glazed side aspect bay window, double glazed side aspect window, carpeted, two wall mounted radiators.

### Kitchen/Diner

*16'4" x 8'8" (4.98m x 2.64m)*

Double glazed rear access door, Double glazed front and side aspect windows, built in oven & grill with induction hob, extractor hood, tiled, built in dishwasher & fridge freezer, wall and base units, stainless steel sink and drainer, wall mounted radiator.

### Landing

Large airing cupboard with shelving, loft access, wall mounted radiator.

### Bedroom One

*16'4" max x 11'8" (4.98m max x 3.56m)*

Double glazed side aspect bay window, double glazed side aspect window, carpeted, wall mounted radiator.

### En Suite

Shower cubicle with mains shower, double glazed front aspect window, partially tiled walls, low level WC, wash hand basin, wall mounted radiator.

### Bedroom Two

*12'1" x 10'1" (3.68m x 3.07m)*

Double glazed front and side aspect windows, carpeted, wall mounted radiator.

### Bedroom Three

*12'1" x 8'8" max (3.68m x 2.64m max)*

Double glazed side aspect window, carpeted, wall mounted radiator.

### Bedroom Four

*10'1" x 8'8" (3.07m x 2.64m)*

Double glazed side aspect window, carpeted, wall mounted radiator.

### Bathroom

Full length bath with mains shower, double glazed side aspect window, shave point, extractor fan, low level WC, wash hand basin, wall mounted radiator.

### Rear Garden

Enclosed, doors accessing the Kitchen and Garage, outside tap, outside plug, pergola, lawn and patio areas, side access.





**Garage**

Up and over door, stainless steel sink and drainer, base units, space for appliances.

**Parking**

Off road parking with electric charge point.

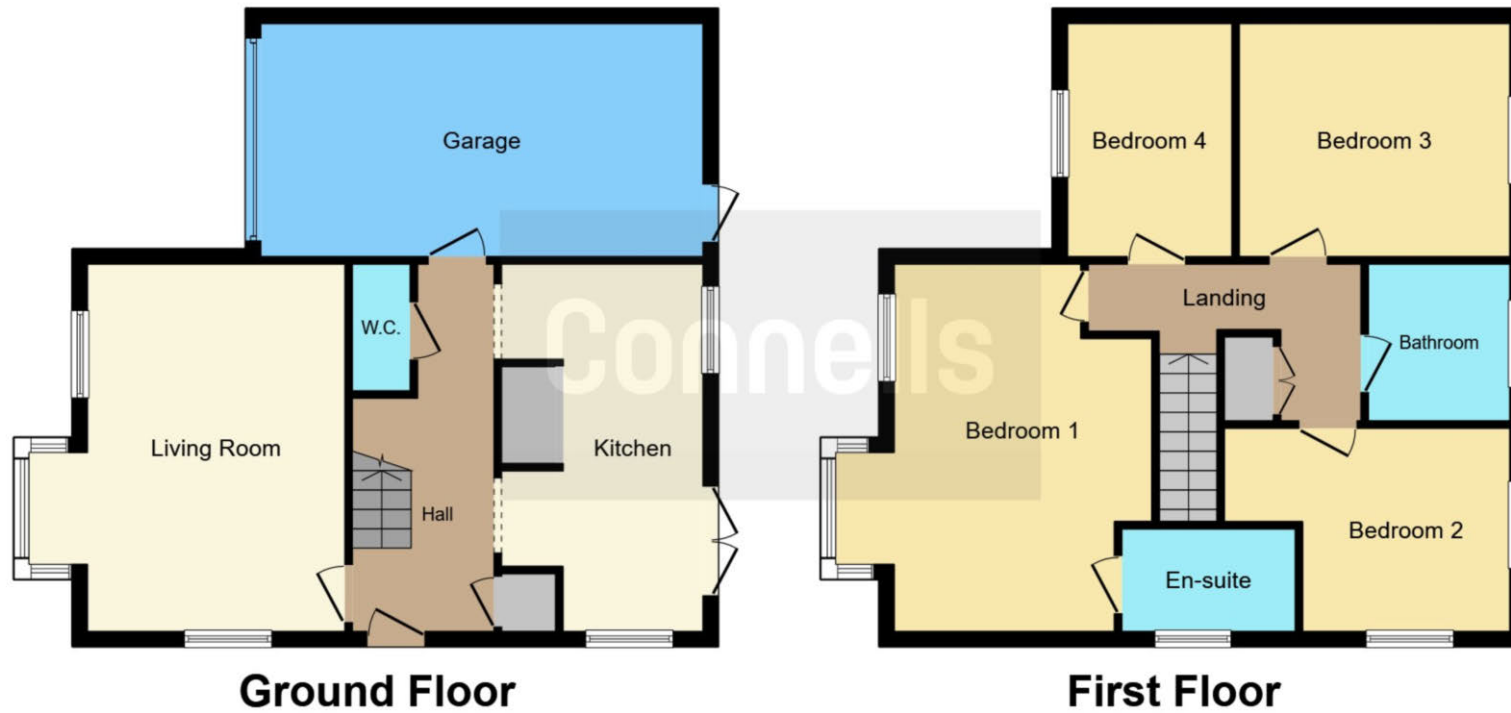

This floorplan is for illustrative purposes only and is not drawn to scale. Measurements, floor-areas, openings and orientations are approximate. They should not be relied upon for any purpose and do not form any part of an agreement. No liability is taken for any error or mis-statement. All parties must rely on their own inspections.

# Goldfinch Lane, Cranbrook

A stylish and modern four bedroom detached family home built by the popular developer Linden Homes, boasting off road parking with car charge point with access to garage, with well-presented modern kitchen with built in appliances only a short distance to local country park.

Tenure: Freehold

EPC Rating: B

**Connells** SIGNATURE

To view this property please contact us on

**01392 221 331**

or email [exeter@connells.co.uk](mailto:exeter@connells.co.uk)

8/9 South Street, Exeter, Devon, EX1 1DZ

[CONNELLS.CO.UK](http://CONNELLS.CO.UK)



1. MONEY LAUNDERING REGULATIONS Intending purchasers will be asked to produce identification documentation at a later stage and we would ask for your co-operation in order that there is no delay in agreeing the sale. 2. These particulars do not constitute part or all of an offer or contract. 3. The measurements indicated are supplied for guidance only and as such must be considered incorrect. Potential buyers are advised to recheck measurements before committing to any expense. 4. We have not tested any apparatus, equipment, fixtures or services and it is in the buyers interest to check the working condition of any appliances. 5. Where an EPC, or a Home Report (Scotland only) is held for this property, it is available for inspection at the branch by appointment. If you require a printed version of a Home Report, you will need to pay a reasonable production charge reflecting printing and other costs. 6. We are not able to offer an opinion either written or verbal on the content of these reports and this must be obtained from your legal representative. 7. Whilst we take care in preparing these reports, a buyer should ensure that his/her legal representative confirms as soon as possible all matters relating to title including the extent and boundaries of the property and other important matters before exchange of contracts.

Connells Residential is registered in England and Wales under company number 1489613, Registered Office is Cumbria House, 16-20 Hockliffe Street, Leighton Buzzard, Bedfordshire, LU7 1GN. VAT Registration Number is 500 2481 05.

