



Connells

Rake End
Hill Ridware Rugeley



Property Description

Connells Estate Agents Lichfield are thrilled to bring to the sales market this wonderfully unique countryside retreat located in the very pleasant hamlet of Hill Ridware, Staffordshire.

Boasting a super rear garden backing onto local fields, with plenty of village amenities nearby. *FANTASTIC OPPORTUNITY FOR REAR EXPANSION (SUBJECT TO PLANING OF COURSE) A REAL MUST SEE** **NO CHAIN** **POSSIBILITY FOR A FRONT DRIVEWAY, OTHERS HAVE DONE IT, SEEK PLANNING PERMISSION**

Internally we can offer a good size lounge, kitchen- diner, sun room, guest wc, two bedrooms and a bathroom

TWO GOOD SIZE BEDROOMS, SUPERB LOUNGE AND KITCHEN DINER **A MUST VISIT AREA OF STAFFORDSHIRE**
BEAUTIFUL COTTAGE IN THE MIDDLE OF HILL RIDWARE

SURE TO BE INCREDIBLY POPULAR AT THIS ASKING PRICE, CALL CONNELLS LICHFIELD TODAY TO REGISTER YOUR INTEREST. **FREE HOME VALUATIONS AND MORTGAGE ADVICE, JUST ASK OUR FRIENDLY TEAM**



Lounge

16' x 11' 1" (4.88m x 3.38m)

Kitchen

16' x 9' (4.88m x 2.74m)

Sun Room

10' 4" x 5' 9" (3.15m x 1.75m)

Ground Floor Wc

First Floor Landing

Bedroom One

16' x 11' 1" (4.88m x 3.38m)

Bedroom Two

10' x 6' 5" (3.05m x 1.96m)

Bathroom Off

Pleasant Lawned Garden

Countryside Views

Lawned Front Garden

Plenty Of Scope For Extension

Period Cottage ** Stunning

Popular Village Location







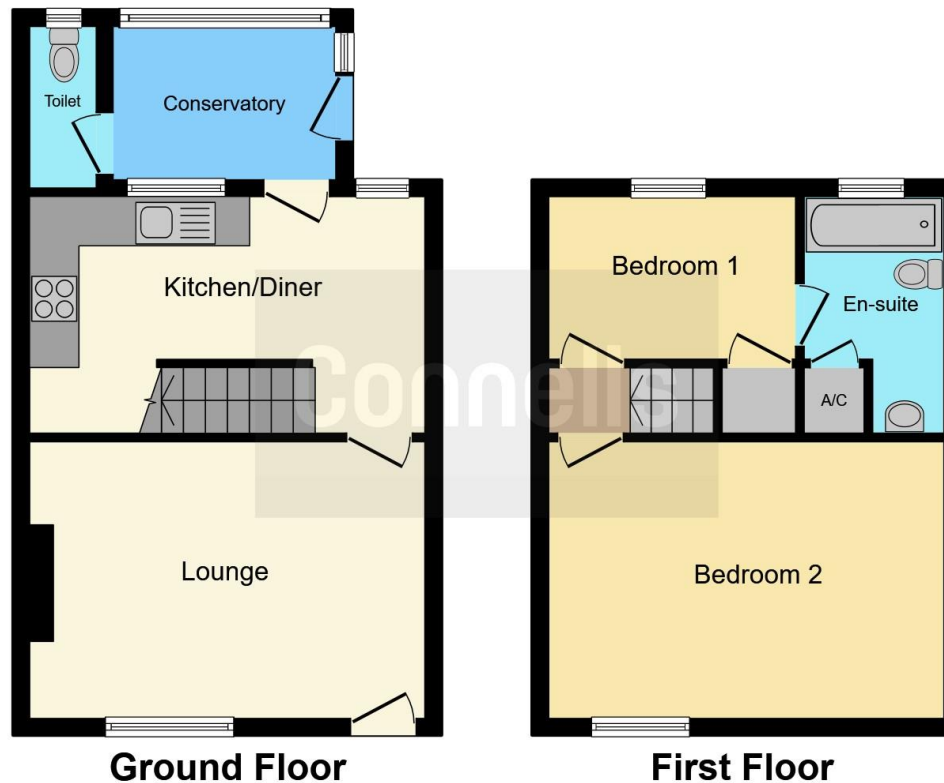

This floor plan is for illustrative purposes only. It is not drawn to scale. Any measurements, floor areas (including any total floor area), openings and orientation are approximate. No details are guaranteed, they cannot be relied upon for any purpose and they do not form part of any agreement. No liability is taken for any error, omission or misstatement. A party must rely upon its own inspection(s). Powered by www.focalagent.com

To view this property please contact Connells on

T 01543 262 376
E lichfield@connells.co.uk

11 & 13 Bore Street
 LICHFIELD WS13 6LZ

EPC Rating: D

view this property online connells.co.uk/Property/LFD310987

Tenure: Freehold



1. MONEY LAUNDERING REGULATIONS Intending purchasers will be asked to produce identification documentation at a later stage and we would ask for your co-operation in order that there will be no delay in agreeing the sale. 2. These particulars do not constitute part or all of an offer or contract. 3. The measurements indicated are supplied for guidance only and as such must be considered incorrect. Potential buyers are advised to recheck measurements before committing to any expense. 4. We have not tested any apparatus, equipment, fixtures, fittings or services and it is in the buyers interest to check the working condition of any appliances.

Connells Residential is registered in England and Wales under company number 1489613, Registered Office is Cumbria House, 16-20 Hockliffe Street, Leighton Buzzard, Bedfordshire, LU7 1GN. VAT Registration Number is 500 2481 05.

See all our properties at www.connells.co.uk | www.rightmove.co.uk | www.zoopla.co.uk

Property Ref: LFD310987 - 0003