



**Connells**

Barratt Court  
LICHFIELD



### Property Description

MORTGAGE ADVICE\*\* \*\*BOOK YOUR  
SLOT TODAY\*\*

\*\* 40 % SHARED OWNERSHIP \*\* \*\*AN  
ABSOLUTE MUST VISIT TO APPRECIATE  
ASPECT AND CONDITION\*\*

Welcome to Barratt Court. A stunning end of terrace family home in the popular Cathedral City of Lichfield. Offered for sale at a shared ownership price. Perfect for those looking to downsize or get on the property ladder.

This home briefly comprises of an entrance hallway, spacious living room with ample dining area, guest cloakroom and a modern kitchen. To the first floor we can offer two double bedrooms and a modern family bathroom. Externally this property offers a one car driveway to fore and a landscaped garden to rear, Barratt Court is a modern cul de sac and offers plenty of on Street parking and visitor parking to take advantage of.

This home is located only minutes away from plenty of local amenities. Most of which can be found in the centre of our Cathedral city. Lichfield City Centre is located approximately two miles away, with Lichfield Trent Valley station located just around the corner, which offers direct lines into London Euston. As well as this, the stunning Miller homes estate enjoys direct access onto the A38, which is ideal for commuting needs. Lichfield City Football Club and a host of parks and greens can be found on the doorstep.

WONDERFULLY MODERN PROPERTY,  
WELL PRESENTED THROUGHOUT\*\* CALL  
CONNELLS LICHFIELD FOR IN HOUSE



## Entrance Hallway

## Guest Wc

## Lounge Diner

12' 3" max x 15' 4" max ( 3.73m max x 4.67m max )

## Modern Kitchen

5' 3" x 10' 2" ( 1.60m x 3.10m )

## First Floor Accommodation

## Bedroom One

8' 5" max x 12' 3" max ( 2.57m max x 3.73m max )

## Bedroom Two

8' 5" max x 12' 3" max ( 2.57m max x 3.73m max )

## Modern Family Bathroom

## Landscaped Rear Garden

## Driveway To Fore

## Pleasant Cul De Sac

## Modern Homes







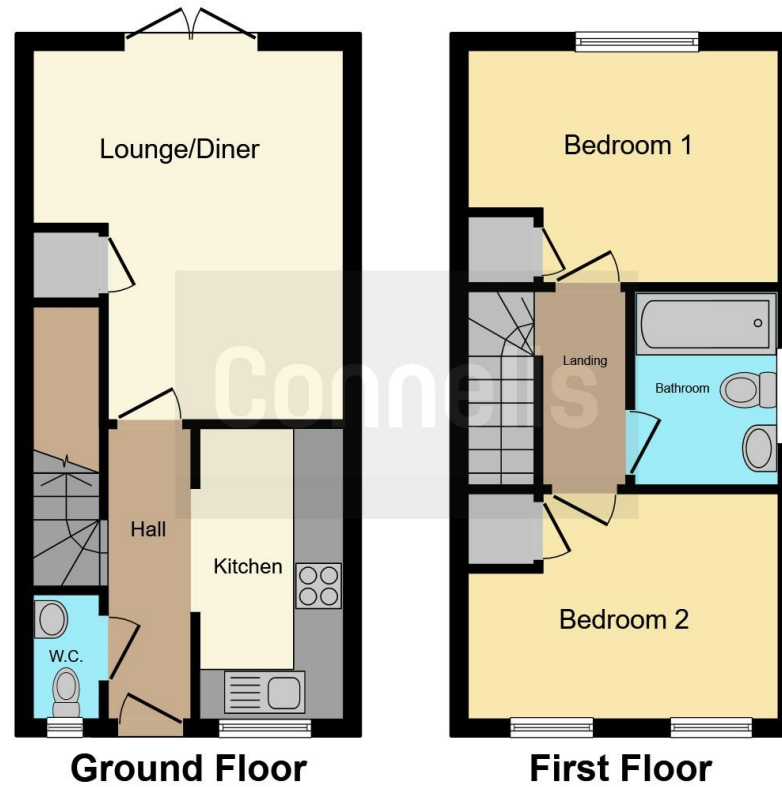

This floor plan is for illustrative purposes only. It is not drawn to scale. Any measurements, floor areas (including any total floor area), openings and orientation are approximate. No details are guaranteed, they cannot be relied upon for any purpose and they do not form part of any agreement. No liability is taken for any error, omission or misstatement. A party must rely upon its own inspection(s). Powered by [www.focalagent.com](http://www.focalagent.com)

To view this property please contact Connells on

**T 01543 262 376**  
**E [lichfield@connells.co.uk](mailto:lichfield@connells.co.uk)**

11 & 13 Bore Street  
 LICHFIELD WS13 6LZ

**EPC Rating: B**

Tenure: Freehold

**view this property online [connells.co.uk/Property/LFD311018](http://connells.co.uk/Property/LFD311018)**



1. MONEY LAUNDERING REGULATIONS Intending purchasers will be asked to produce identification documentation at a later stage and we would ask for your co-operation in order that there will be no delay in agreeing the sale. 2. These particulars do not constitute part or all of an offer or contract. 3. The measurements indicated are supplied for guidance only and as such must be considered incorrect. Potential buyers are advised to recheck measurements before committing to any expense. 4. We have not tested any apparatus, equipment, fixtures, fittings or services and it is in the buyers interest to check the working condition of any appliances.

Connells Residential is registered in England and Wales under company number 1489613, Registered Office is Cumbria House, 16-20 Hockliffe Street, Leighton Buzzard, Bedfordshire, LU7 1GN. VAT Registration Number is 500 2481 05.

**See all our properties at [www.connells.co.uk](http://www.connells.co.uk) | [www.rightmove.co.uk](http://www.rightmove.co.uk) | [www.zoopla.co.uk](http://www.zoopla.co.uk)**

Property Ref: LFD311018 - 0002