



Connells

Chaffinch Close
Streethay Lichfield



Property Description

**** 42 % SHARED OWNERSHIP ****

Welcome to Chaffinch Close. A stunning semi-detached family home in the popular village of Streethay. Offered for sale at a shared ownership price.

This home briefly comprises of an entrance hallway, spacious living room, guest cloakroom and a kitchen / diner to the rear. To the first floor landing we can offer two double sized bedrooms and a family bathroom. Externally this property offers at least two off road car parking spaces to the side. To the rear, there is a patio area and a good size lawn.

Chaffinch Close is a quiet cul de sac location. This home is located only minutes away from plenty of local amenities. Most of which can be found in the centre of our Cathedral city. Lichfield City Centre is located approximately two miles away, with Lichfield Trent Valley station located just around the corner, which offers direct lines into London Euston. As well as this, the stunning Miller homes estate enjoys direct access onto the A38, which is ideal for commuting needs.



Living Room

11' 9" max x 15' 2" (3.58m max x 4.62m)

Kitchen / Diner

10' 4" x 15' 2" (3.15m x 4.62m)

First Floor Landing

Bedroom One

11' 1" x 9' 6" (3.38m x 2.90m)

Bedroom Two

13' 7" max x 9' 9" (4.14m max x 2.97m)

Family Bathroom







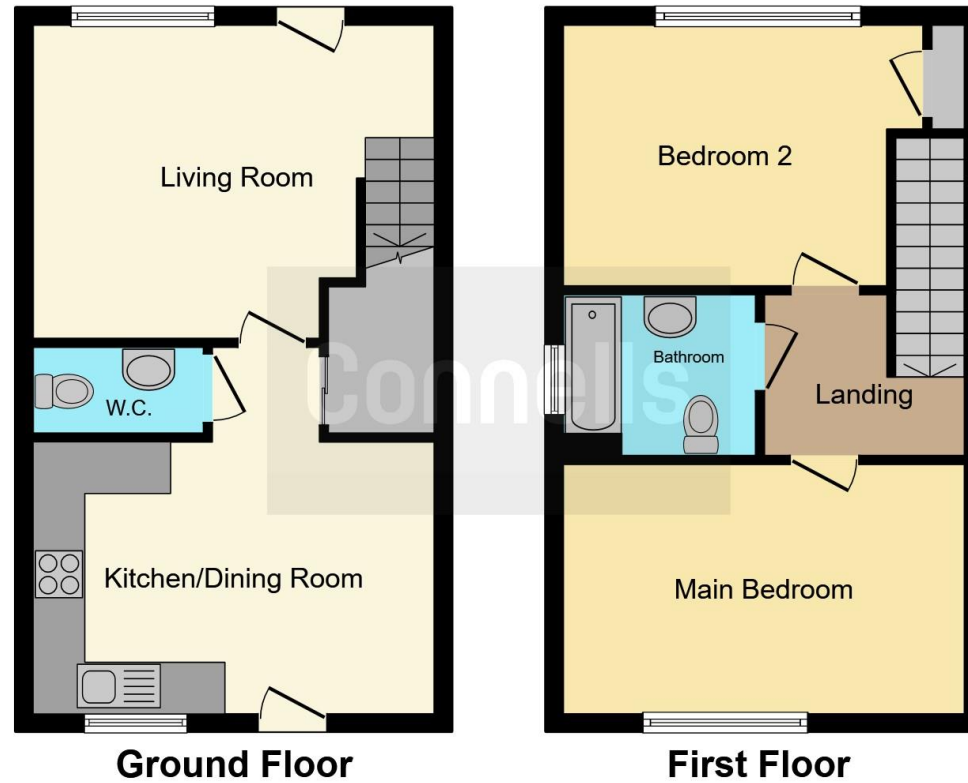

This floor plan is for illustrative purposes only. It is not drawn to scale. Any measurements, floor areas (including any total floor area), openings and orientation are approximate. No details are guaranteed, they cannot be relied upon for any purpose and they do not form part of any agreement. No liability is taken for any error, omission or misstatement. A party must rely upon its own inspection(s). Powered by www.focalagent.com

To view this property please contact Connells on

T 01543 262 376
E lichfield@connells.co.uk

11 & 13 Bore Street
 LICHFIELD WS13 6LZ

EPC Rating: B

Tenure: Leasehold

view this property online connells.co.uk/Property/LFD310679

This is a Leasehold property with details as follows; Term of Lease 125 years from 01 Apr 2019. Should you require further information please contact the branch. Please Note additional fees could be incurred for items such as



1. MONEY LAUNDERING REGULATIONS Intending purchasers will be asked to produce identification documentation at a later stage and we would ask for your co-operation in order that there will be no delay in agreeing the sale. 2. These particulars do not constitute part or all of an offer or contract. 3. The measurements indicated are supplied for guidance only and as such must be considered incorrect. Potential buyers are advised to recheck measurements before committing to any expense. 4. We have not tested any apparatus, equipment, fixtures, fittings or services and it is in the buyers interest to check the working condition of any appliances.

Connells Residential is registered in England and Wales under company number 1489613, Registered Office is Cumbria House, 16-20 Hockliffe Street, Leighton Buzzard, Bedfordshire, LU7 1GN. VAT Registration Number is 500 2481 05.

See all our properties at www.connells.co.uk | www.rightmove.co.uk | www.zoopla.co.uk

Property Ref: LFD310679 - 0003