



Connells

Homelodge House Castle Dyke
LICHFIELD

Homelodge House Castle Dyke LICHFIELD WS13 6XD

for sale offers in excess of
£70,000



Property Description

A ONE BEDROOM FIRST FLOOR RETIREMENT APARTMENT OVERLOOKING THE FRONT OF THE DEVELOPMENT. Homelodge House was constructed by McCarthy & Stone (Developments) Ltd and comprises 45 properties arranged over 3 floors each served by lift. The House Manager can be contacted from various points within each property in the case of an emergency. For periods when the House Manager is off duty there is a 24 hour emergency Careline response system. Each property comprises an entrance hall, lounge, kitchen, one bedroom and bathroom. It is a condition of purchase that residents must be over the age of 60 years, or in the event of a couple, one must be over the age of 60 years and the other over 55 years. Homelodge House offers the added attraction of being near to the amenities of the town centre.

Entrance Hall

Door to airing cupboard housing water tank with immersion heater, shelving and storage space. Ceiling light fittings. Power point.

Living Room

Wall light fittings, night storage heater, power points, TV aerial point, emergency pull cord. An archway leads to

Kitchen

Tiled and fitted with stainless steel sink unit,

wall and floor cupboards with work tops. Space for refrigerator and cooker. Power points. Strip light.

Bedroom

Built in wardrobe with hanging rail and shelf above. Storage heater, wall light fittings, power points, emergency pull cord.







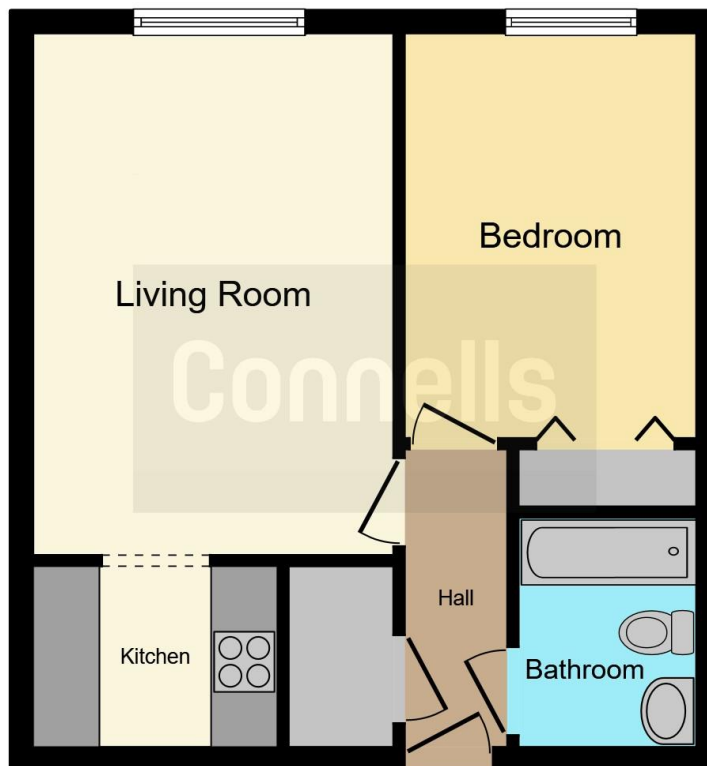

This floor plan is for illustrative purposes only. It is not drawn to scale. Any measurements, floor areas (including any total floor area), openings and orientation are approximate. No details are guaranteed, they cannot be relied upon for any purpose and they do not form part of any agreement. No liability is taken for any error, omission or misstatement. A party must rely upon its own inspection(s). Powered by www.focalagent.com

To view this property please contact Connells on

T 01543 262 376
E lichfield@connells.co.uk

11 & 13 Bore Street
LICHFIELD WS13 6LZ

EPC Rating: C

Tenure: Leasehold

view this property online connells.co.uk/Property/LFD310662

This is a Leasehold property. We are awaiting further details about the Term of the lease. For further information please contact the branch. Please note additional fees could be incurred for items such as Leasehold packs.



1. MONEY LAUNDERING REGULATIONS Intending purchasers will be asked to produce identification documentation at a later stage and we would ask for your co-operation in order that there will be no delay in agreeing the sale. 2. These particulars do not constitute part or all of an offer or contract. 3. The measurements indicated are supplied for guidance only and as such must be considered incorrect. Potential buyers are advised to recheck measurements before committing to any expense. 4. We have not tested any apparatus, equipment, fixtures, fittings or services and it is in the buyers interest to check the working condition of any appliances.

Connells Residential is registered in England and Wales under company number 1489613, Registered Office is Cumbria House, 16-20 Hockliffe Street, Leighton Buzzard, Bedfordshire, LU7 1GN. VAT Registration Number is 500 2481 05.

See all our properties at www.connells.co.uk | www.rightmove.co.uk | www.zoopla.co.uk

Property Ref: LFD310662 - 0006