



Connells

Leeside Court Northesk Street
Plymouth

Leeside Court Northesk Street Plymouth PL2 1EZ

for sale
£120,000



Property Description

NO CHAIN Situated in a popular residential location and close to a host of local amenities, this two bedroom purpose built apartment, situated in stoke offers good sized living space throughout, allocated parking and appeal to a wide range of buyer

Close to a host of local amenities, well-regarded schools, local parks and provides easy access to the city centre and main transport links.

With one double bedroom and one single bedroom, a separate spacious lounge, kitchen and allocated parking this apartment has potential for First time buyers looking for their first property to investors looking for a good return.

BOOK YOUR VIEWINGS NOW!

NO CHAIN Situated in a popular residential location and close to a host of local amenities, this two bedroom purpose built apartment, situated in stoke offers good sized living space throughout, allocated parking and appeal to a wide range of buyer

Close to a host of local amenities, well-regarded schools, local parks and provides easy access to the city centre and main transport links.

With one double bedroom and one single bedroom, a separate spacious lounge, kitchen and allocated parking this apartment has potential for First time buyers looking for

their first property to investors looking for a good return.

BOOK YOUR VIEWINGS NOW!

NO CHAIN Situated in a popular residential location and close to a host of local amenities, this two bedroom purpose built apartment, situated in stoke offers good sized living space throughout, allocated parking and appeal to a wide range of buyer

Close to a host of local amenities, well-regarded schools, local parks and provides easy access to the city centre and main transport links.

With one double bedroom and one single bedroom, a separate spacious lounge, kitchen and allocated parking this apartment has potential for First time buyers looking for their first property to investors looking for a good return.

BOOK YOUR VIEWINGS NOW!

NO CHAIN Situated in a popular residential location and close to a host of local amenities, this two bedroom purpose built apartment, situated in stoke offers good sized living space throughout, allocated parking and appeal to a wide range of buyer

Close to a host of local amenities, well-regarded schools, local parks and provides easy access to the city centre and main transport links.

With one double bedroom and one single bedroom, a separate spacious lounge, kitchen and allocated parking this apartment has potential for First time buyers looking for their first property to investors looking for a good return.

BOOK YOUR VIEWINGS NOW!







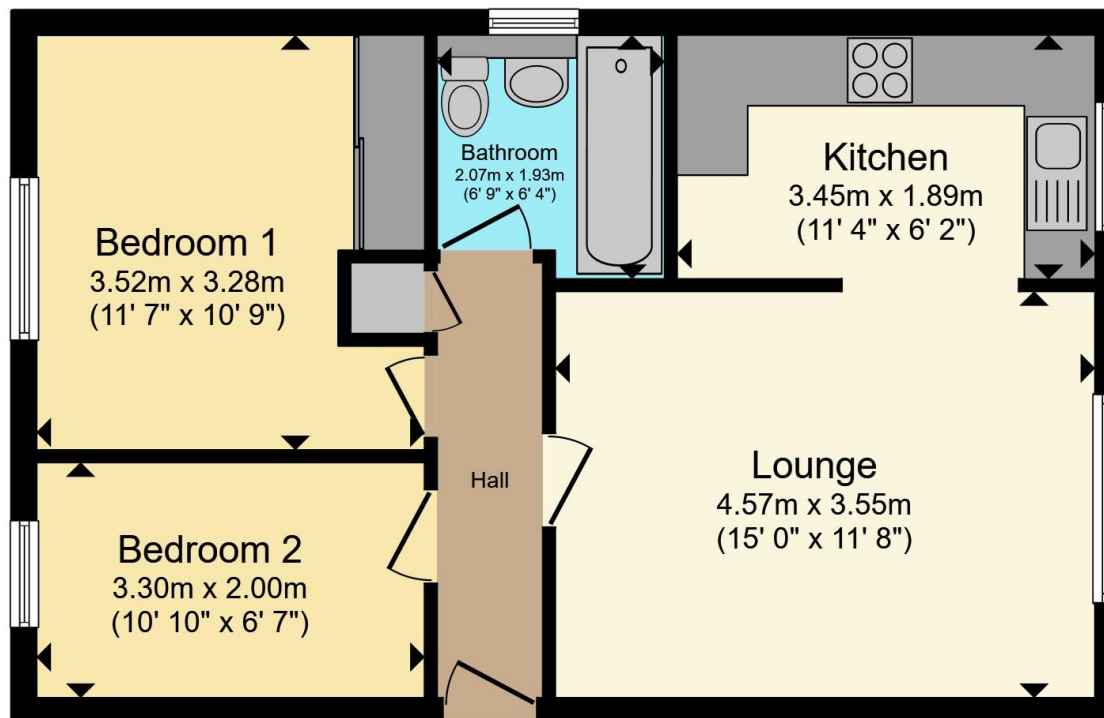

Total floor area 50.3 m² (542 sq.ft.) approx

This floor plan is for illustrative purposes only. It is not drawn to scale. Any measurements, floor areas (including any total floor area), openings and orientation are approximate. No details are guaranteed, they cannot be relied upon for any purpose and they do not form part of any agreement. No liability is taken for any error, omission or misstatement. A party must rely upon its own inspection(s). Powered by www.propertybox.io

Connells

To view this property please contact Connells on

T 01752 674 467
E plymouth@connells.co.uk

32 Mannamead Road
PLYMOUTH PL4 7AA

EPC Rating: D

Council Tax
Band: A

Service Charge: Ask
Agent

Ground Rent:
Ask Agent

Tenure: Leasehold

view this property online connells.co.uk/Property/PLH313037

This is a Leasehold property. We are awaiting further details about the Term of the lease. For further information please contact the branch. Please note additional fees could be incurred for items such as Leasehold packs.



1. MONEY LAUNDERING REGULATIONS Intending purchasers will be asked to produce identification documentation at a later stage and we would ask for your co-operation in order that there will be no delay in agreeing the sale. 2. These particulars do not constitute part or all of an offer or contract. 3. The measurements indicated are supplied for guidance only and as such must be considered incorrect. Potential buyers are advised to recheck measurements before committing to any expense. 4. We have not tested any apparatus, equipment, fixtures, fittings or services and it is in the buyers interest to check the working condition of any appliances.

Connells Residential is registered in England and Wales under company number 1489613, Registered Office is Cumbria House, 16-20 Hockliffe Street, Leighton Buzzard, Bedfordshire, LU7 1GN. VAT Registration Number is 500 2481 05.

See all our properties at www.connells.co.uk | www.rightmove.co.uk | www.zoopla.co.uk

Property Ref: PLH313037 - 0004