



Connells

Erlstoke Close
Plymouth



Property Description

As you enter the property and to your right, you will find a large open plan lounge diner perfect for entertaining, with windows to the front and rear, giving that light and airy feel, you will also find a modern kitchen with floor and wall units, built in appliances and double glazed window over looking the outdoor space.

Upstairs, you will be met with two large double bedrooms, a further generous third bedroom with built in storage. finally a modern fitted bathroom with separate W.C.

Externally, A large secluded rear garden, two car driveway and spacious garage. you also have the benefit of a substantial space with multiple uses below the garage.

This property is a must view.

Lounge

11' 5" x 13' 4" (3.48m x 4.06m)

Double glazed window to the front aspect, chimney breast and carpet

Kitchen

9' x 8' 8" (2.74m x 2.64m)

Double glazed window to rear aspect, wall and base units, hob, sink and separate storage cupboard

Dining Room

9' 3" x 9' (2.82m x 2.74m)

Double glazed window to rear aspect

Bedroom 1

9' 5" x 13' 1" (2.87m x 3.99m)

Double glazed window to front aspect and carpet

Bedroom 2

12' x 10' 6" (3.66m x 3.20m)

Double glazed window to rear aspect and carpet

Bedroom 3

8' 2" x 7' 11" (2.49m x 2.41m)

Double window to front aspect, carpet and storage

Bathroom

Double glazed window to rear aspect, bath and hand basin

W.C







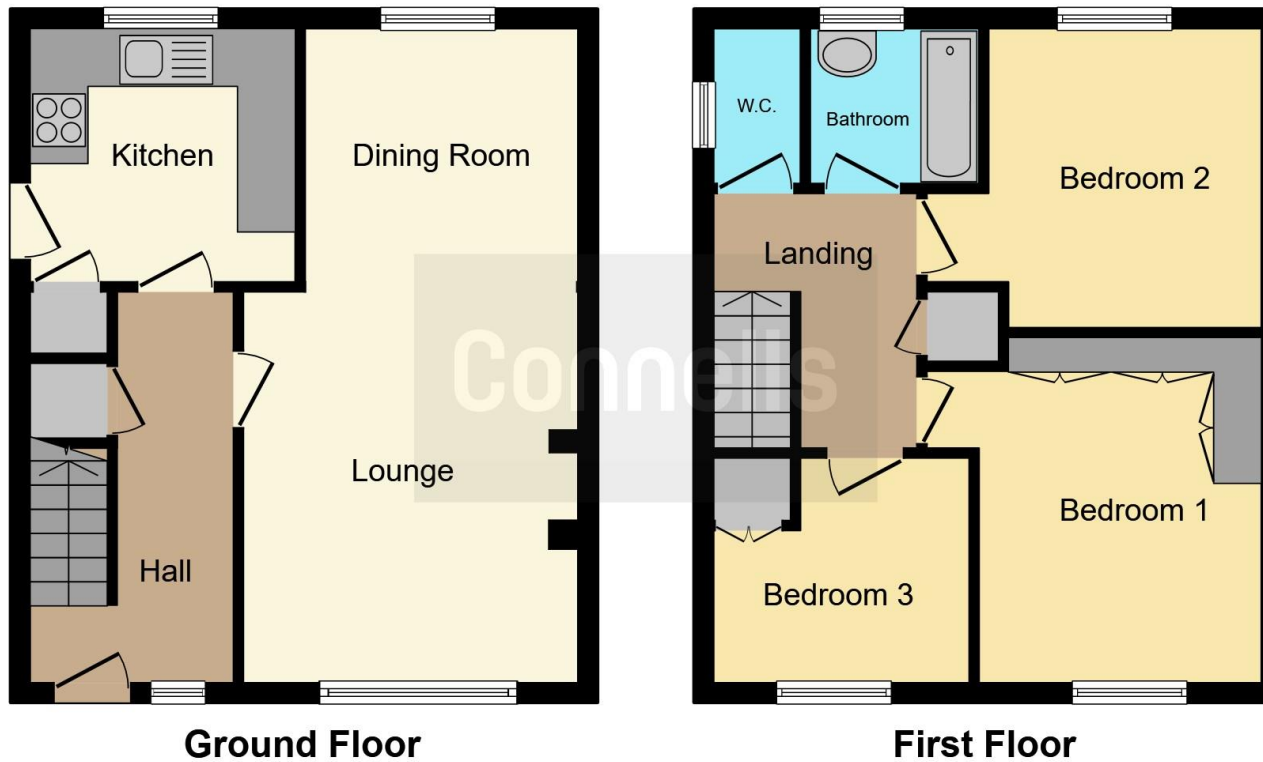

This floor plan is for illustrative purposes only. It is not drawn to scale. Any measurements, floor areas (including any total floor area), openings and orientation are approximate. No details are guaranteed, they cannot be relied upon for any purpose and they do not form part of any agreement. No liability is taken for any error, omission or misstatement. A party must rely upon its own inspection(s). Powered by www.focalagent.com

To view this property please contact Connells on

T 01752 674 467
E plymouth@connells.co.uk

32 Mannamead Road
 PLYMOUTH PL4 7AA

EPC Rating: D

view this property online connells.co.uk/Property/PLH310632

Tenure: Freehold



1. MONEY LAUNDERING REGULATIONS Intending purchasers will be asked to produce identification documentation at a later stage and we would ask for your co-operation in order that there will be no delay in agreeing the sale. 2. These particulars do not constitute part or all of an offer or contract. 3. The measurements indicated are supplied for guidance only and as such must be considered incorrect. Potential buyers are advised to recheck measurements before committing to any expense. 4. We have not tested any apparatus, equipment, fixtures, fittings or services and it is in the buyers interest to check the working condition of any appliances.

Connells Residential is registered in England and Wales under company number 1489613, Registered Office is Cumbria House, 16-20 Hockliffe Street, Leighton Buzzard, Bedfordshire, LU7 1GN. VAT Registration Number is 500 2481 05.

See all our properties at www.connells.co.uk | www.rightmove.co.uk | www.zoopla.co.uk

Property Ref: PLH310632 - 0004