

for sale

offers over **£475,000**



Freemans Wharf Plymouth PL1 3RN

Rare opportunity to enquire this stunning waterfront residence with far reaching sea views. Being sold with NO CHAIN sits this Three Bedroom townhouse with a plethora of features such as integral garage, sprawling water views from the rear garden and balcony. This property is a must see!

Freemans Wharf Plymouth PL1 3RN

Ground Floor

Entrance Hall

The Entrance Hall features under stair storage and ceiling light.

Lounge

15' 9" x 11' 3" (4.80m x 3.43m)

The Lounge features patio doors leading out into the rear garden, fitted carpet and ceiling light.

W.C.

There is a separate downstairs W.C. with wash hand basin.

First Floor Landing

The Landing features fitted carpet and ceiling light.

Kitchen / Diner

28' 1" x 15' 8" (8.56m x 4.78m)

The open plan Lounge / Kitchen features patio doors leading out onto the balcony, fitted carpet and ceiling light. The Kitchen comprises of; double glazed front window, matching wall and

base units, gas hob, oven and sink.

Utility Room

The Utility Room comprises of; double glazed front window, matching wall and base units, sink and ceiling light.

Second Floor Landing

The Landing features fitted carpet, ceiling light, built in storage and access to the loft.

Bedroom One

13' 8" x 11' 2" (4.17m x 3.40m)

The first double Bedroom features a double glazed rear window with sea views, built in wardrobes, fitted carpet, radiator and ceiling light.

En Suite

The En Suite can be accessed from Bedroom One and comprises of; W.C, wash hand basin, shower and radiator.

Bedroom Two

17' 8" x 7' 7" (5.38m x 2.31m)



The second double Bedroom features a double glazed front window, fitted carpet, radiator and ceiling light.

Bedroom Three

7' 8" x 6' 6" (2.34m x 1.98m)

The third Bedroom features a double glazed front window, fitted carpet, radiator and ceiling light.

Bathroom

The Bathroom comprises of; W.C, wash hand basin, bath with overhead shower and radiator.

Airing Cupboard

The Airing Cupboard features a light.

Loft

The Loft has been fully boarded and insulated and has a built in ladder with light.

Garage

The Garage is on the ground floor and has an electrical supply.



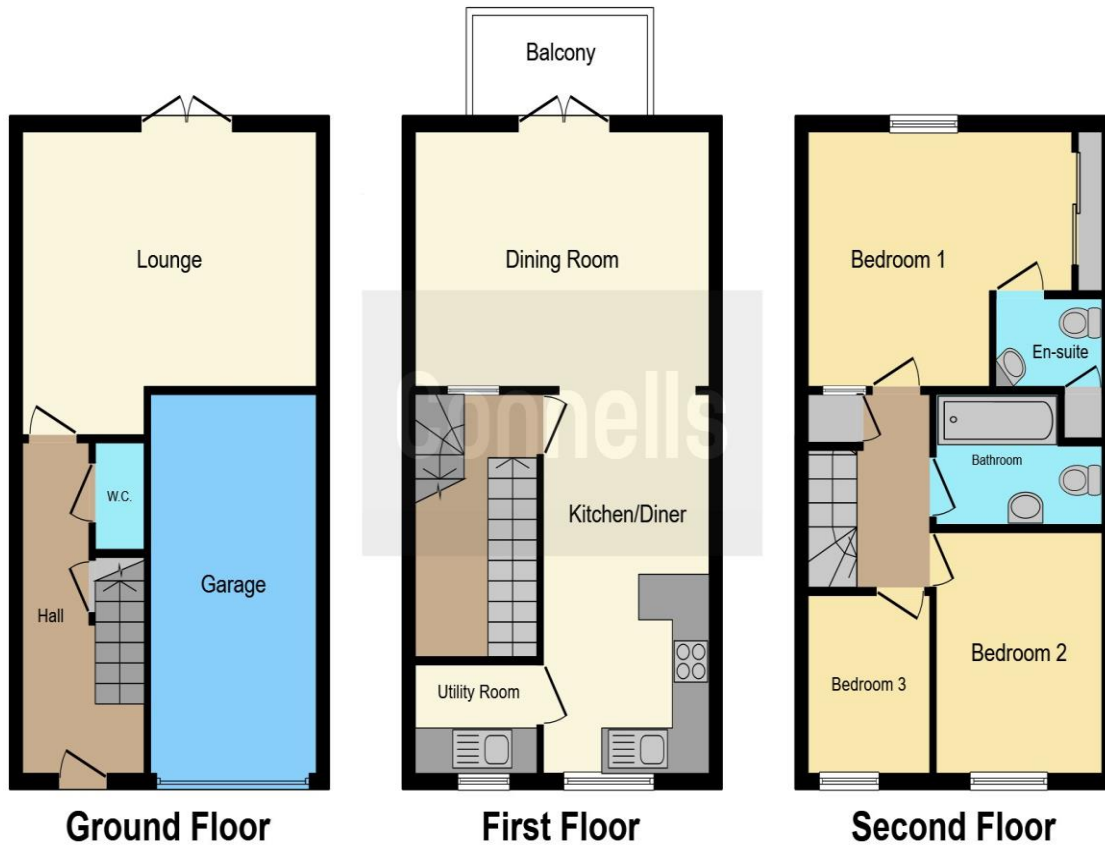

This floorplan is for illustrative purposes only and is not drawn to scale. Measurements, floor-areas, openings and orientations are approximate. They should not be relied upon for any purpose and do not form any part of an agreement. No liability is taken for any error or mis-statement. All parties must rely on their own inspections.

To view this property please contact Connells on

T 01752 674 467
E plymouth@connells.co.uk

32 Mannamead Road
 PLYMOUTH PL4 7AA

Property Ref: PLH309968 - 0006

Tenure: Freehold

EPC Rating: C

view this property online connells.co.uk/Property/PLH309968



1. MONEY LAUNDERING REGULATIONS Intending purchasers will be asked to produce identification documentation at a later stage and we would ask for your co-operation in order that there will be no delay in agreeing the sale. 2. These particulars do not constitute part or all of an offer or contract. 3. The measurements indicated are supplied for guidance only and as such must be considered incorrect. Potential buyers are advised to recheck measurements before committing to any expense. 4. We have not tested any apparatus, equipment, fixtures, fittings or services and it is in the buyers interest to check the working condition of any appliances.

Connells Residential is registered in England and Wales under company number 1489613, Registered Office is Cumbria House, 16-20 Hockliffe Street, Leighton Buzzard, Bedfordshire, LU7 1GN. VAT Registration Number is 500 2481 05.

see all our properties at www.connells.co.uk | www.rightmove.co.uk | www.zoopla.co.uk