

for sale

offers over **£130,000** Leasehold



Gallagher Court Wake Green Park Birmingham B13 9XX

Ground floor flat, Lounge, Two Bedrooms, Bathroom, Communal parking and gardens

- Energy Rating: C
- GROUND FLOOR FLAT
- LOUNGE
- TWO BEDROOMS
- KITCHEN

Property Details

Communal Entrance

Communal parking and gardens

Entrance Hall

Door to communal hall and hallway, with storage cupboards.
Doors to

Cloakroom

En-block garage

Lounge / Diner 17' 4" x 12' 9" narrowing to 9' 9" (5.28m x 3.89m narrowing to 2.97m)

Double glazed window and door to the rear, wall mounted radiator, storage cupboard and door to

Kitchen 10' 2" x 7' 6" (3.10m x 2.29m)

Double glazed window to the side, a range of wall and base units incorporating an electric oven, gas hob and hood, a single drainer sink, access to central heating boiler.

Bathroom

Corner bath with over bath electric shower, low level W.C, hand wash basin and heated towel rail

Bedroom 1 12' 11" x 9' 11" (3.94m x 3.02m)

Double glazed window to the front, wall mounted radiator and storage cupboard.



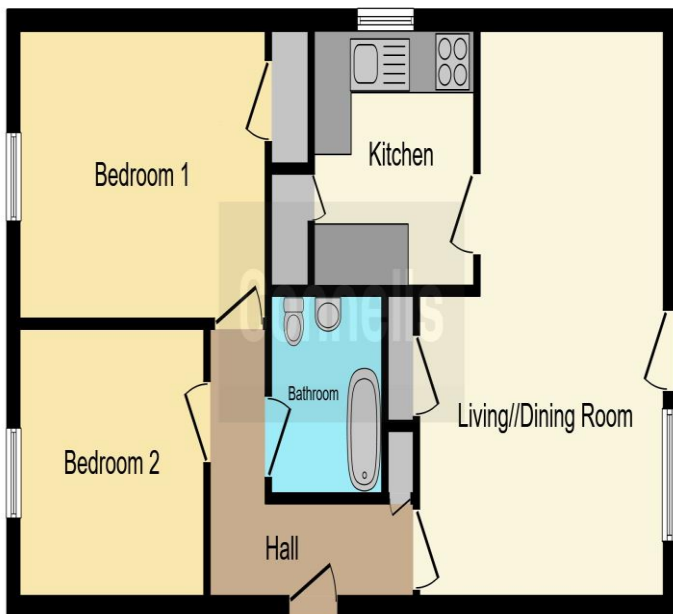

This floor plan is for illustrative purposes only. It is not drawn to scale. Any measurements, floor areas (including any total floor area), openings and orientation are approximate. No details are guaranteed, they cannot be relied upon for any purpose and they do not form part of any agreement. No liability is taken for any error, omission or misstatement. A party must rely upon its own inspection(s). Powered by www.focalagent.com

To view this property please contact Connells on

T 0121 443 3357
E kingsheath@connells.co.uk

93 High Street Kings Heath
BIRMINGHAM B14 7BW

Tenure: Leasehold

EPC Rating: C

Property Ref: KTH309869 - 0003

This is a Leasehold property. We are awaiting further details about the Term of the lease. For further information please contact the branch. Please note additional fees could be incurred for these such as Leasehold Fees.

1. MONEY LAUNDERING REGULATIONS Intending purchasers will be asked to produce identification documentation at a later stage and we would ask for your co-operation in order that there will be no delay in agreeing the sale. 2. These particulars do not constitute part or all of an offer or contract. 3. The measurements indicated are supplied for guidance only and as such must be considered incorrect. Potential buyers are advised to recheck measurements before committing to any expense. 4. We have not tested any apparatus, equipment, fixtures, fittings or services and it is in the buyers interest to check the working condition of any appliances.

Connells Residential is registered in England and Wales under company number 1489613, Registered Office is Cumbria House, 16-20 Hockliffe Street, Leighton Buzzard, Bedfordshire, LU7 1GN. VAT Registration Number is 500 2481 05.

see all our properties at www.connells.co.uk | www.rightmove.co.uk | www.zoopla.co.uk