



Connells

Porlock Crescent  
Northfield



## Property Description

Semi detached family home ideal for first time buyers and buy to let investors.

Off road parking, lounge, kitchen, ground floor bathroom, three bedrooms, large rear garden.

Call today to book your viewing on 0121 426 2800.

## Approach

Set back behind a driveway and front garden.

## Lounge

15' 8" maximum x 13' 5" maximum ( 4.78m maximum x 4.09m maximum )

Bay window to front elevation, feature fire surround with in set electric fire, storage cupboard, two ceiling light points, panelled radiator.

## Kitchen

7' 9" x 7' 5" ( 2.36m x 2.26m )

Ceiling light point, panelled radiator, double glazed window and door to rear, gas cooker point, sink with drainer, door leading to staircase to first floor.

## Bathroom

Ground floor bathroom with bath, shower overhead, hand wash basin, low flush wc, ceiling light point, heated towel rail, window to rear elevation.

## Landing

Doors and stairs off, loft access, ceiling light point, double glazed window to side

## Bedroom One

12' 8" x 8' 4" ( 3.86m x 2.54m )

double glazed window to rear elevation, over stairs storage cupboard housing the boiler, panelled radiator, ceiling light point.

## Bedroom Two

11' x 7' 11" ( 3.35m x 2.41m )

double glazed window to front elevation, panelled radiator, ceiling light point.

## Bedroom Three

7' 11" x 7' 7" ( 2.41m x 2.31m )

double glazed window to front elevation, ceiling light point, panelled radiator.

## Rear Garden

rear garden







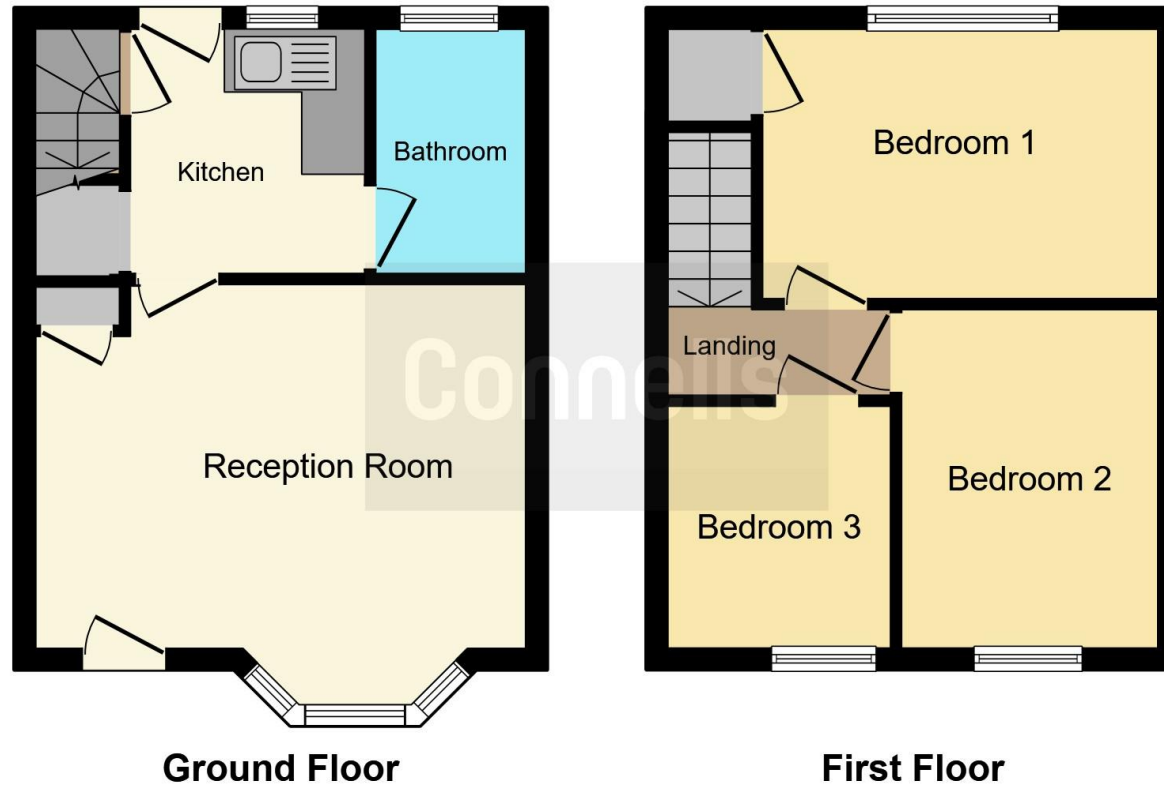

This floor plan is for illustrative purposes only. It is not drawn to scale. Any measurements, floor areas (including any total floor area), openings and orientation are approximate. No details are guaranteed, they cannot be relied upon for any purpose and they do not form part of any agreement. No liability is taken for any error, omission or misstatement. A party must rely upon its own inspection(s). Powered by [www.focalagent.com](http://www.focalagent.com)

To view this property please contact Connells on

**T 0121 426 2800**  
**E [harborne@connells.co.uk](mailto:harborne@connells.co.uk)**

158 High Street Harborne  
 BIRMINGHAM B17 9QE

EPC Rating: D Council Tax  
 Band: B

Tenure: Freehold

**view this property online [connells.co.uk/Property/HBO310345](http://connells.co.uk/Property/HBO310345)**



1. MONEY LAUNDERING REGULATIONS Intending purchasers will be asked to produce identification documentation at a later stage and we would ask for your co-operation in order that there will be no delay in agreeing the sale. 2. These particulars do not constitute part or all of an offer or contract. 3. The measurements indicated are supplied for guidance only and as such must be considered incorrect. Potential buyers are advised to recheck measurements before committing to any expense. 4. We have not tested any apparatus, equipment, fixtures, fittings or services and it is in the buyers interest to check the working condition of any appliances.

Connells Residential is registered in England and Wales under company number 1489613, Registered Office is Cumbria House, 16-20 Hockliffe Street, Leighton Buzzard, Bedfordshire, LU7 1GN. VAT Registration Number is 500 2481 05.

**See all our properties at [www.connells.co.uk](http://www.connells.co.uk) | [www.rightmove.co.uk](http://www.rightmove.co.uk) | [www.zoopla.co.uk](http://www.zoopla.co.uk)**

Property Ref: HBO310345 - 0007