



Connells

Hazelbeech Road
West Bromwich



Property Description

Situated in a sought after residential location this larger than average three bedroom 1930's terraced home is not one to be missed. Making a great home for a small family or first time buyer the property offers heaps of space and a sought after location within West Bromwich. The house briefly comprises of a well maintained front garden with the potential to add a driveway, a large living room, kitchen diner with a modern fitted kitchen, a large family sized rear garden which is low maintenance, three double bedrooms to the first floor and a modern fitted bathroom suite. There are several Primary Schools located within the immediate area as well as a local park and corner shop and walking distance to West Bromwich high street!

CALL US NOW TO BOOK YOUR VIEWINGS!

Lounge

17' 4" x 12' 5" (5.28m x 3.78m)

Double glazed window to the front, stairs to the first floor, TV and telephone points, central heated radiator and door to the kitchen.

Kitchen

17' 4" x 8' 4" (5.28m x 2.54m)

Modern fitted kitchen comprising of a range of wall and base units with work surfaces over, sink and drainer, space and plumbing for washing machine, integrated oven and induction hob with cooker hood over, storage pantry, double glazed window to the rear and door to the rear garden.

First Floor Landing

Stairs from the lounge, storage cupboard and doors to the bedrooms and family bathroom.

Bedroom One

12' 6" x 9' 9" (3.81m x 2.97m)

Double glazed window to the front, central heated radiator and fitted wardrobe.

Bedroom Two

14' 8" x 8' 3" (4.47m x 2.51m)

Double glazed window to the rear and central heated radiator.

Bedroom Three

10' 6" x 7' 6" (3.20m x 2.29m)

Double glazed window to the front and central heated radiator.

Bathroom

Fitted panel bath with shower over, wash hand basin, WC, part tiled and double glazed window to the rear.

Rear Garden

Slabbed patio area to the front, gravelled and artificial lawn areas to the rear.







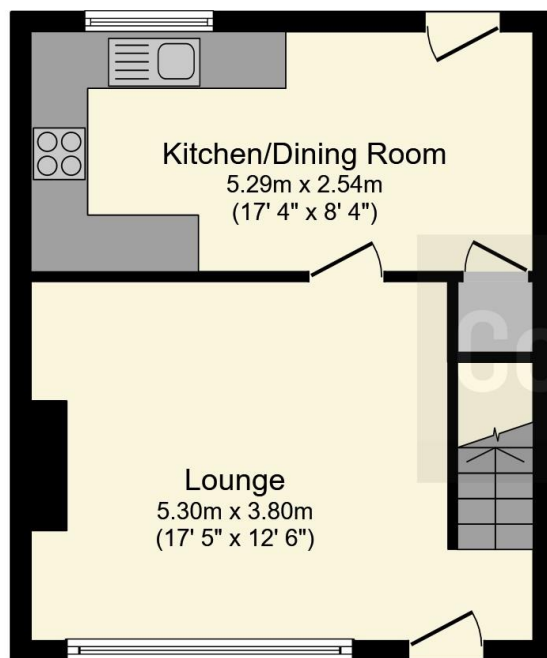

Ground Floor

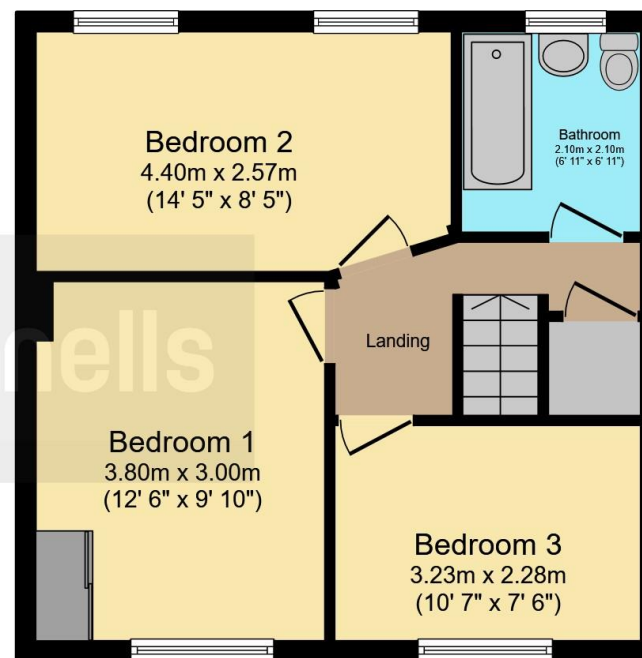

First Floor

This floor plan is for illustrative purposes only. It is not drawn to scale. Any measurements, floor areas (including any total floor area), openings and orientation are approximate. No details are guaranteed, they cannot be relied upon for any purpose and they do not form part of any agreement. No liability is taken for any error, omission or misstatement. A party must rely upon its own inspection(s). Powered by www.focalagent.com

To view this property please contact Connells on

T 0121 525 1177
E westbromwich@connells.co.uk

3 Astle Park
WEST BROMWICH B70 8NS

EPC Rating: D

Tenure: Freehold

view this property online connells.co.uk/Property/WBW310584



1. MONEY LAUNDERING REGULATIONS Intending purchasers will be asked to produce identification documentation at a later stage and we would ask for your co-operation in order that there will be no delay in agreeing the sale. 2. These particulars do not constitute part or all of an offer or contract. 3. The measurements indicated are supplied for guidance only and as such must be considered incorrect. Potential buyers are advised to recheck measurements before committing to any expense. 4. We have not tested any apparatus, equipment, fixtures, fittings or services and it is in the buyers interest to check the working condition of any appliances.

Connells Residential is registered in England and Wales under company number 1489613, Registered Office is Cumbria House, 16-20 Hockliffe Street, Leighton Buzzard, Bedfordshire, LU7 1GN. VAT Registration Number is 500 2481 05.

See all our properties at www.connells.co.uk | www.rightmove.co.uk | www.zoopla.co.uk

Property Ref: WBW310584 - 0004