



**Connells**

Farcroft Avenue  
Birmingham



## Property Description

This property briefly comprises of an entrance hall, lounge, dining room, fitted kitchen, utility area, down stairs bathroom, three good sized bedrooms, central heating and a rear garden.

## Entrance Hall

Main front door leading into the property, radiator, stairs rising to the first floor and doors into both receptions and kitchen.

## Lounge

14' 4" into bay x 11' 8" into recess ( 4.37m into bay x 3.56m into recess )

Bay window to the front, TV point, radiator, gas fire and surround and laminated flooring.

## Dining Room

12' 9" x 11' 8" ( 3.89m x 3.56m )

Window to the rear, radiator, TV point, gas fire and surround and laminated flooring.

## Kitchen

11' x 9' 5" ( 3.35m x 2.87m )

A range of fitted wall and base units with surfaces over, one bowl stainless steel sink and drainer with taps, window to the side, central heating boiler and doors into the lobby and entrance hall

## Lobby

Doors leading into the utility area/veranda, bathroom and wc.

## Bathroom

Window the the side, wash hand basin, low level wc, fitted panel bath with shower over, chrome heated towel rail and being fully tiled.

## Utility/veranda

23' 10" x 6' 1" into recess ( 7.26m x 1.85m into recess )

Door into the rear garden, wash hand basin and plumbing facilities.

## First Floor Landing

Window to the rear, radiator and laminated flooring.

## Bedroom One

15' 1" into recess x 12' excluding bay ( 4.60m into recess x 3.66m excluding bay )

Bay window to the front and two radiators.

## Bedroom Two

12' 8" x 11' 8" into recess ( 3.86m x 3.56m into recess )

Window to the rear, laminated flooring and a radiator.

## Bedroom Three

9' 5" x 8' 6" ( 2.87m x 2.59m )

Window to the front, radiator and laminated flooring.

## Rear Garden

Being completed slabbed for low maintenance, shed, flowerbeds to borders and rear gated access







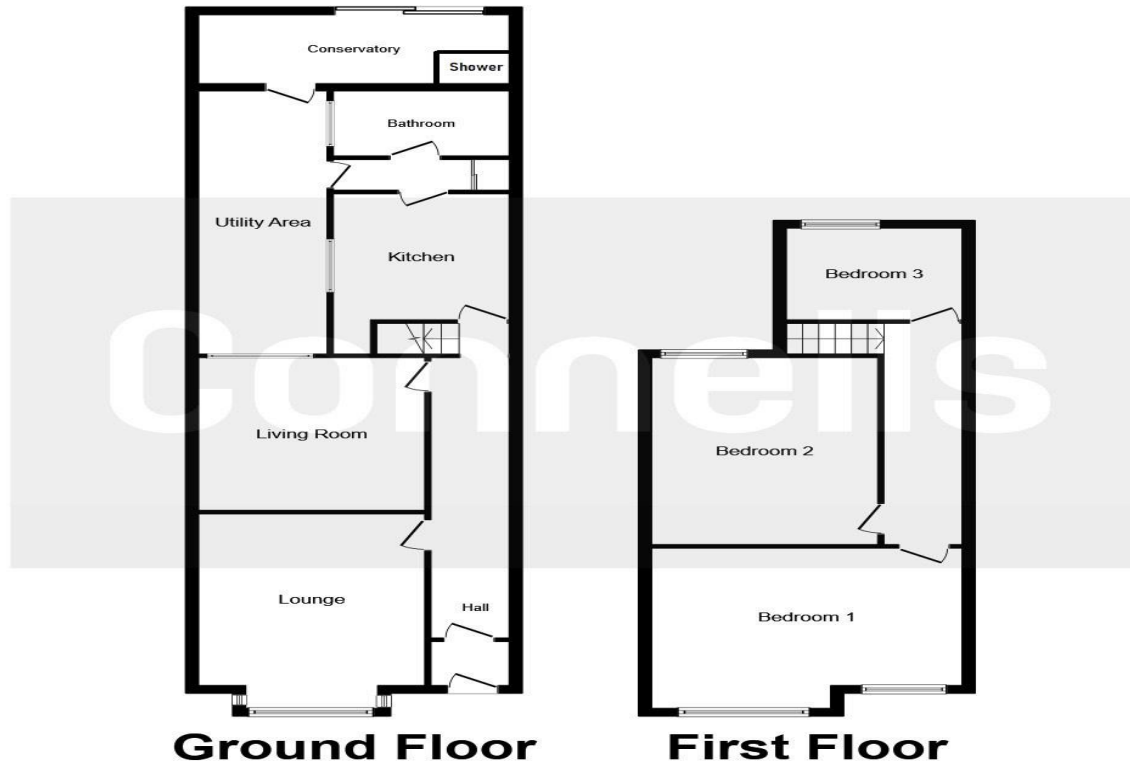

This floor plan is for illustrative purposes only. It is not drawn to scale. Any measurements, floor areas (including any total floor area), openings and orientation are approximate. No details are guaranteed, they cannot be relied upon for any purpose and they do not form part of any agreement. No liability is taken for any error, omission or misstatement. A party must rely upon its own inspection(s). Plan produced for Connells. Powered by www.focalagent.com

To view this property please contact Connells on

**T 0121 525 1177**  
**E westbromwich@connells.co.uk**

3 Astle Park  
 WEST BROMWICH B70 8NS

**EPC Rating: D**

Tenure: Freehold

**view this property online [connells.co.uk/Property/WBW309582](http://connells.co.uk/Property/WBW309582)**



1. MONEY LAUNDERING REGULATIONS Intending purchasers will be asked to produce identification documentation at a later stage and we would ask for your co-operation in order that there will be no delay in agreeing the sale. 2. These particulars do not constitute part or all of an offer or contract. 3. The measurements indicated are supplied for guidance only and as such must be considered incorrect. Potential buyers are advised to recheck measurements before committing to any expense. 4. We have not tested any apparatus, equipment, fixtures, fittings or services and it is in the buyers interest to check the working condition of any appliances.

Connells Residential is registered in England and Wales under company number 1489613, Registered Office is Cumbria House, 16-20 Hockliffe Street, Leighton Buzzard, Bedfordshire, LU7 1GN. VAT Registration Number is 500 2481 05.

**See all our properties at [www.connells.co.uk](http://www.connells.co.uk) | [www.rightmove.co.uk](http://www.rightmove.co.uk) | [www.zoopla.co.uk](http://www.zoopla.co.uk)**

Property Ref: WBW309582 - 0004