



George Law Court Anchorfields
Kidderminster



Property Description

A spacious one bedroom apartment situated in an ideal location, with Kidderminster Town Centre, Kidderminster Train Station and plenty of local amenities within walking distance. Stepping in through a secured intercom door, the communal areas of the building are kept clean and tidy at all times. Through the apartment door you will be greeted with an entrance hall with doors off to all rooms.

A spacious lounge with double glazed doors leading onto a balcony, a new and modern fitted kitchen, spacious bedroom with fitted wardrobes and a new white bathroom suite. This property benefits from communal parking.

Entrance Hall

Stepping in from the communal hallway into the entrance hall having wooden flooring, a wall-mounted electric heater, ceiling light point and storage cupboard. Doors off to all rooms.

Lounge

17' 3" x 11' (5.26m x 3.35m)

Two double glazed windows and a set of double glazed balcony doors create a bright and airy living space, with fitted carpet, television aerial point, wall-mounted electric heater, electric fireplace and surround and two ceiling light points. Open archway leads into the kitchen.

Kitchen

7' 9" x 6' 8" (2.36m x 2.03m)

Modern wall and base units surrounding with ample work surface space. Inset stainless steel sink, fitted electric hob with extractor fan above, integrated eye-level oven and grill and space for a freestanding fridge freezer. Vinyl flooring, under-cupboard lighting and a ceiling light point.

Bedroom

17' 3" x 10' 6" (5.26m x 3.20m)

Incredibly spacious bedroom, boasting fitted mirror-fronted sliding wardrobes, carpet, wall-mounted electric heater, ceiling light point and a double glazed window.

Bathroom

Modern white suite comprising a wash hand vanity unit with storage beneath and counter-top space to the side, low level WC and a large walk-in shower cubicle with a glass sliding door. Partially tiled walls, vinyl flooring, chrome heated towel rail, ceiling light point and a built-in storage cupboard.

Outside

Communal parking.







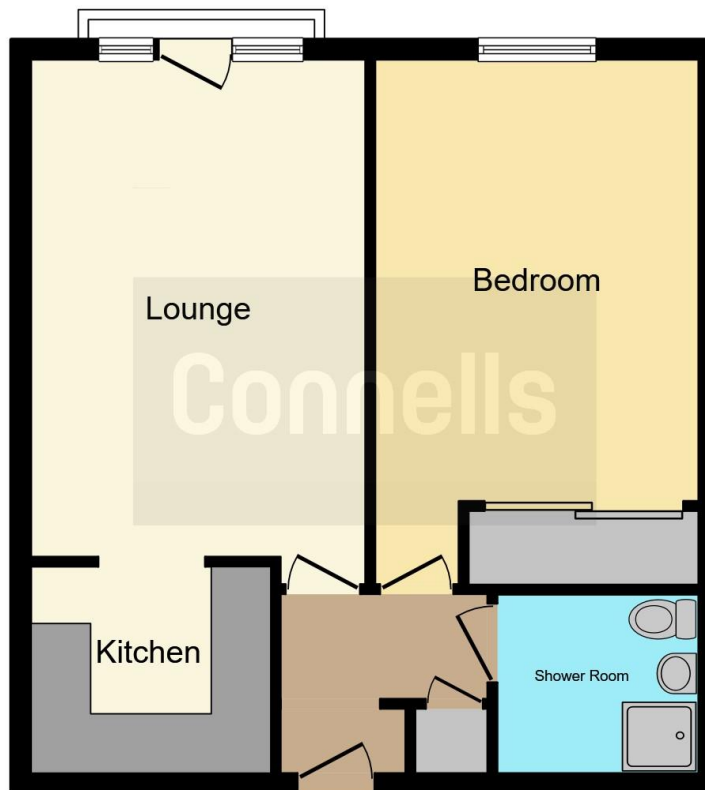

This floorplan is for illustrative purposes only and is not drawn to scale. Measurements, floor-areas, openings and orientations are approximate. They should not be relied upon for any purpose and do not form any part of an agreement. No liability is taken for any error or mis-statement. All parties must rely on their own inspections.

To view this property please contact Connells on

T 01562 682 14
E kidderminster@connells.co.uk

28-29 Worcester Street
KIDDERMINSTER DY10 1ED

EPC Rating: B

Tenure: Leasehold

[check out more properties at connells.co.uk](http://connells.co.uk)

This is a Leasehold property. We are awaiting further details about the Term of the lease. For further information please contact the branch. Please note additional fees could be incurred for items such as Leasehold packs.



1. MONEY LAUNDERING REGULATIONS Intending purchasers will be asked to produce identification documentation at a later stage and we would ask for your co-operation in order that there will be no delay in agreeing the sale. 2. These particulars do not constitute part or all of an offer or contract. 3. The measurements indicated are supplied for guidance only and as such must be considered incorrect. Potential buyers are advised to recheck measurements before committing to any expense. 4. We have not tested any apparatus, equipment, fixtures, fittings or services and it is in the buyers interest to check the working condition of any appliances.

Connells Residential is registered in England and Wales under company number 1489613, Registered Office is Cumbria House, 16-20 Hockliffe Street, Leighton Buzzard, Bedfordshire, LU7 1GN. VAT Registration Number is 500 2481 05.

See all our properties at www.connells.co.uk | www.rightmove.co.uk | www.zoopla.co.uk

Property Ref: KMR310403 - 0004