



Connells

Hawthorn Road
Wednesbury



Property Description

A THREE BEDROOM SEMI DETACHED HOME IN POPULAR LOCATION & NO CHAIN - A three bedroom home having through lounge, kitchen, ample rear garden & driveway to front, good size bedrooms & bathroom.

Property Info

Entrance Hallway

Lounge Irregular Shaped Room 21' 1" max x 13' 11" max (6.43m max x 4.24m)
'L' Shaped

Breakfast Kitchen 11' 10" x 9' 4" (3.61m x 2.84m)

First Floor Landing

Access to boarded loft

Bedroom One 12' 11" x 9' 9" (3.94m x 2.97m)

Bedroom Two 10' 8" x 12' 11" (3.25m x 3.94m)

Bedroom Three 7' 8" x 8' 11" (2.34m x 2.72m)

Bathroom

Outside
Front:
Driveway

Rear:
Rear garden

Outhouse WC



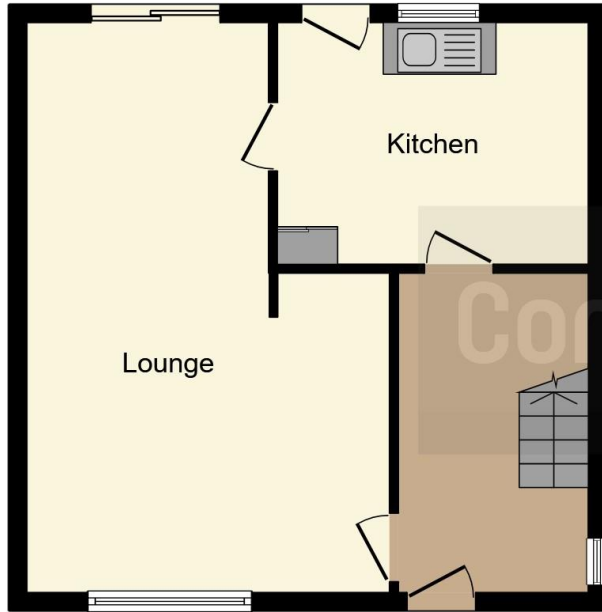

Ground Floor



First Floor



This floorplan is for illustrative purposes only and is not drawn to scale. Measurements, floor-areas, openings and orientations are approximate. They should not be relied upon for any purpose and do not form any part of an agreement. No liability is taken for any error or mis-statement. All parties must rely on their own inspections.

To view this property please contact Connells on

T 0121 556 2338

E wednesbury@connells.co.uk

22 Springhead
WEDNESBURY WS10 9AD

EPC Rating: D

view this property online connells.co.uk/Property/WED309510

Tenure: Freehold



1. MONEY LAUNDERING REGULATIONS Intending purchasers will be asked to produce identification documentation at a later stage and we would ask for your co-operation in order that there will be no delay in agreeing the sale. 2. These particulars do not constitute part or all of an offer or contract. 3. The measurements indicated are supplied for guidance only and as such must be considered incorrect. Potential buyers are advised to recheck measurements before committing to any expense. 4. We have not tested any apparatus, equipment, fixtures, fittings or services and it is in the buyers interest to check the working condition of any appliances.

Connells Residential is registered in England and Wales under company number 1489613, Registered Office is Cumbria House, 16-20 Hockliffe Street, Leighton Buzzard, Bedfordshire, LU7 1GN. VAT Registration Number is 500 2481 05.

See all our properties at www.connells.co.uk | www.rightmove.co.uk | www.zoopla.co.uk

Property Ref: WED309510 - 0011