



Connells

Romsley Road  
Stourbridge





### Property Description

AN ATTRACTIVE SEMI DETACHED BUNGALOW IN A POPULAR LOCATION. EXTENDED TO REAR. SPACIOUS THROUGHOUT & READY TO MOVE INTO. LARGE LOUNGE & CONSERVATORY. EXTENDED GALLEY KITCHEN. GOOD SIZE PLOT WITH AMPLE DRIVEWAY, GARAGE & LOVELY, ESTABLISHED REAR GARDEN. Briefly comprises; hall, lounge, conservatory, two bedrooms and shower room. Benefiting from double glazing, gas central heating system, driveway & rear garden.

### To The Front

Block paved driveway providing off road parking leads to the side entrance door and garage, access to the rear garden.

### Entrance Hallway

Double glazed door to the side elevation, radiator and doors to;

### Lounge

Double glazed window to the side elevation, two radiators, fireplace with electric fire.

### Kitchen

Two double glazed windows to the side elevation and a range of wall and base units with worktops, inset sink and integrated oven and gas hob, radiator.

### Conservatory

Overlooking the rear garden with radiator.

### Bedroom One

Double glazed bow window to the front elevation and radiator.

### Bedroom Two

Double glazed bow window to the front elevation, fitted wardrobes and radiator.

### Wet Room

Double glazed window to the side elevation and suite comprising; power shower, wash hand basin, wc and radiator rail.

### Rear Garden

### Garage

Double glazed windows to the side and rear elevations and door to side.





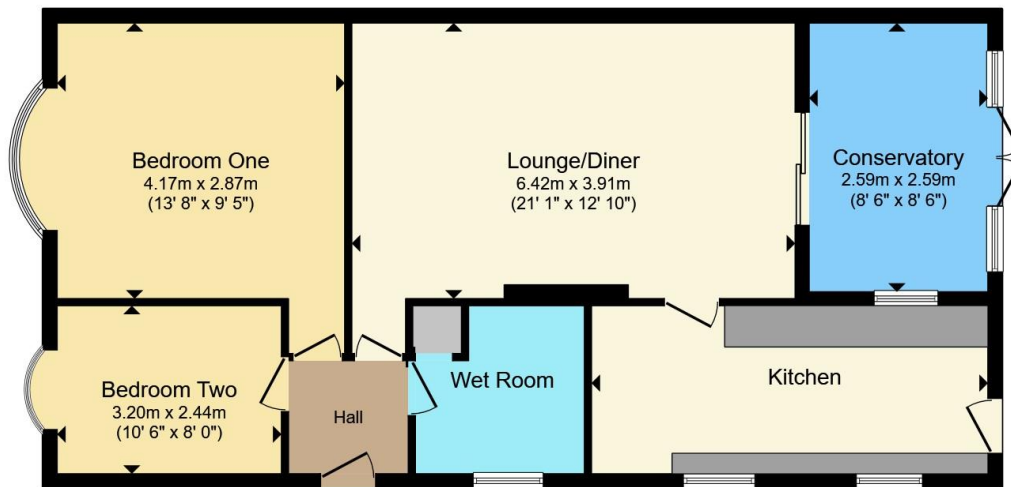

**Floor Plan**



**Garage**

Total floor area 109.1 m<sup>2</sup> (1,174 sq.ft.) approx

This floor plan is for illustrative purposes only. It is not drawn to scale. Any measurements, floor areas (including any total floor area), openings and orientation are approximate. No details are guaranteed, they cannot be relied upon for any purpose and they do not form part of any agreement. No liability is taken for any error, omission or misstatement. A party must rely upon its own inspection(s). Powered by [www.propertybox.io](http://www.propertybox.io)

**Connells**



To view this property please contact Connells on

**T 01384 374 545**  
**E [stourbridge@connells.co.uk](mailto:stourbridge@connells.co.uk)**

11B St. Johns Road  
STOURBRIDGE DY8 1EJ

EPC Rating: C Council Tax  
Band: C

**view this property online [connells.co.uk/Property/SBR313058](http://connells.co.uk/Property/SBR313058)**

Tenure: Freehold



1. MONEY LAUNDERING REGULATIONS Intending purchasers will be asked to produce identification documentation at a later stage and we would ask for your co-operation in order that there will be no delay in agreeing the sale. 2. These particulars do not constitute part or all of an offer or contract. 3. The measurements indicated are supplied for guidance only and as such must be considered incorrect. Potential buyers are advised to recheck measurements before committing to any expense. 4. We have not tested any apparatus, equipment, fixtures, fittings or services and it is in the buyers interest to check the working condition of any appliances.

Connells Residential is registered in England and Wales under company number 1489613, Registered Office is Cumbria House, 16-20 Hockliffe Street, Leighton Buzzard, Bedfordshire, LU7 1GN. VAT Registration Number is 500 2481 05.

**See all our properties at [www.connells.co.uk](http://www.connells.co.uk) | [www.rightmove.co.uk](http://www.rightmove.co.uk) | [www.zoopla.co.uk](http://www.zoopla.co.uk)**

Property Ref: SBR313058 - 0005