



**Connells**

Westbourne Road  
Penn Wolverhampton



### Property Description

A three bedroom detached home in the popular residential area of Penn, close to local amenities and schools with fantastic transport links to Wolverhampton City centre and is an ideal family home. The property has potential for extension subject to the usual planning permission and building regulations consent.

To the ground floor is an entrance hall, lounge, separate dining room and breakfast kitchen. To the first floor there are three bedrooms and family bathroom. Externally there is a well maintained family garden to rear.

### The Location & Area

The property is conveniently located for easy access to Wolverhampton City centre which offers an extensive range of amenities, shops and supermarkets along with leisure facilities. The area itself benefits from close access to a good selection of highly regarded schools and universities.

### Entrance Hall

Door to front, double glazed window to front, staircase leading to first floor, wooden panelling to walls, useful cupboard extending under the stairs, doors to lounge, dining room and kitchen.

### Lounge

14' 4" x 11' 8" ( 4.37m x 3.56m )

Double glazed french doors leading to the rear garden, central heating radiator, TV aerial point, door to hall.

### Dining Room

11' 4" x 11' 4" max into bay ( 3.45m x 3.45m max into bay )

Feature double glazed bay window to front, open fireplace, picture rail, central heating radiator.

### Breakfast Kitchen

15' 4" x 8' 3" ( 4.67m x 2.51m )

Double glazed window to side and rear, Velux window to roof, comprehensive range of wall and base units, inset bowl and half sink unit, working surfaces, built-in hob and oven with cooker hood, plumbing for washing machine and dishwasher, tiled floor, underfloor heating, lighting concealed unit wall cupboard, double glazed door to rear garden,

## First Floor Landing

Doors to various rooms.

## Bedroom One

12' 9" x 11' 7" ( 3.89m x 3.53m )

Double glazed window to rear, central heating radiator, feature ornamental fireplace, door to landing.

## Bedroom Two

Irregular Shaped Room 11' 1" max x 9' 8" (3.38m max x 2.95m)

Double glazed window to front, central heating radiator, cupboard housing central heating boiler, door to landing.

## Bedroom Three

9' 8" x 6' 6" ( 2.95m x 1.98m )

Double glazed window to front, central heating radiator, feature picture rail, door to landing.

## Family Bathroom

Double glazed window to side, panelled bath with separate shower cubicle, wash hand basin set in a vanity unit, heated towel rail, ceramic tiled floor, access to loft.

## Outside Front

Gravelled fore garden and driveway affording off road parking, access to double gates leading to rear.

## Outside Rear

Enclosed rear garden with planted borders, shed, outside tap, power point.







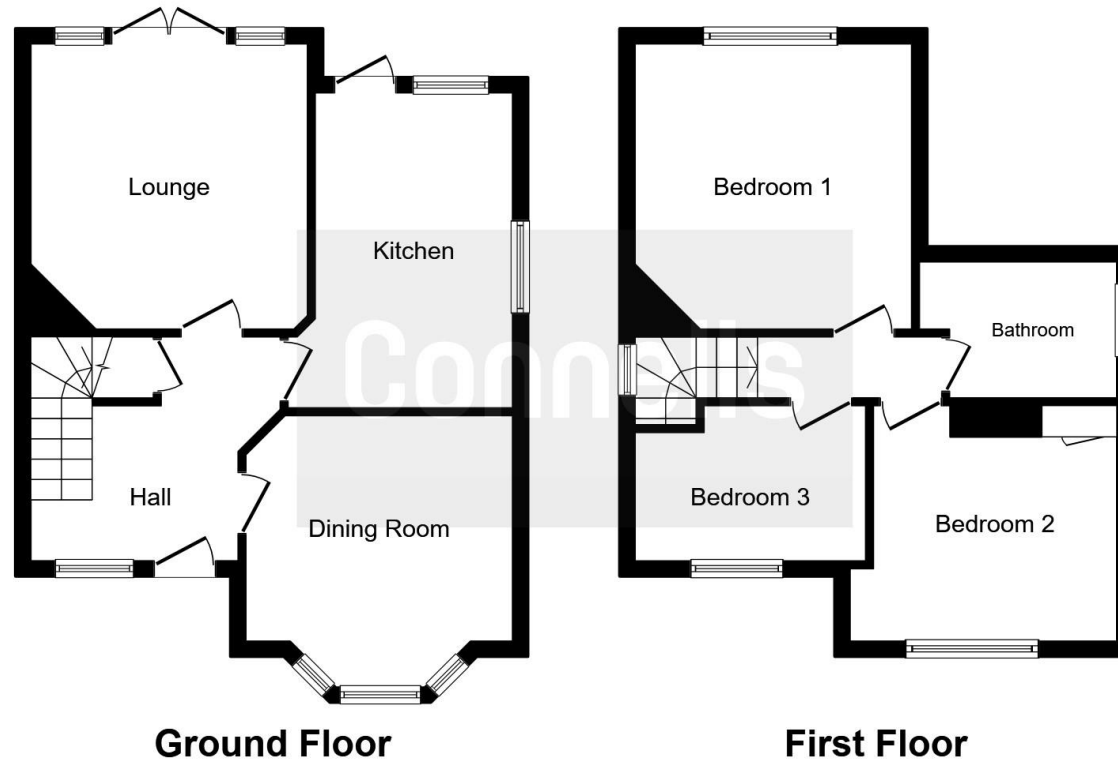

This floor plan is for illustrative purposes only. It is not drawn to scale. Any measurements, floor areas (including any total floor area), openings and orientation are approximate. No details are guaranteed, they cannot be relied upon for any purpose and they do not form part of any agreement. No liability is taken for any error, omission or misstatement. A party must rely upon its own inspection(s).  
Plan produced for Connells. Powered by [www.focalagent.com](http://www.focalagent.com)

To view this property please contact Connells on

**T 01902 710 170**  
**E [wolverhampton@connells.co.uk](mailto:wolverhampton@connells.co.uk)**

81-83 Darlington Street  
WOLVERHAMPTON WV1 4EX

**EPC Rating: D**

**view this property online [connells.co.uk/Property/WVH322756](http://connells.co.uk/Property/WVH322756)**

Tenure: Freehold



1. MONEY LAUNDERING REGULATIONS Intending purchasers will be asked to produce identification documentation at a later stage and we would ask for your co-operation in order that there will be no delay in agreeing the sale. 2. These particulars do not constitute part or all of an offer or contract. 3. The measurements indicated are supplied for guidance only and as such must be considered incorrect. Potential buyers are advised to recheck measurements before committing to any expense. 4. We have not tested any apparatus, equipment, fixtures, fittings or services and it is in the buyers interest to check the working condition of any appliances.

Connells Residential is registered in England and Wales under company number 1489613, Registered Office is Cumbria House, 16-20 Hockliffe Street, Leighton Buzzard, Bedfordshire, LU7 1GN. VAT Registration Number is 500 2481 05.

**See all our properties at [www.connells.co.uk](http://www.connells.co.uk) | [www.rightmove.co.uk](http://www.rightmove.co.uk) | [www.zoopla.co.uk](http://www.zoopla.co.uk)**

Property Ref: WVH322756 - 0007